



Elevate Casement/Awning Narrow Frame

Replacement Parts

Specifications and technical data are subject to change without notice.

Numbers listed in () parentheses are metric equivalents in millimeters rounded to the nearest whole number.

Suggested fasteners are not included and must be ordered separately.

Illustrations are not to scale.

Contents

Product History.....	2
Part Identification - Casement Operator	3
Part Identification - Awning Operator	4
Part Identification - Casement/Awning Stationary/Picture.....	5
Operators	6
Hinges - Casement.....	9
Hinges - Awning	11
Locking Hardware	12
Miscellaneous Parts	17
WOCD Field Applied and Replacement Kit	18
Sash Limiters	19
Sash Limiters - Discontinued Limited Availability (LA).....	20
Vinyl Parts.....	21
Wood Parts - Configured Part in OMS	22
Weather Strip	23
Sash Replacement - Configured Part in OMS	24
Screen Replacement - Configured Part in OMS.....	25
Screen Parts	26
Screen Parts - Discontinued No Availability (NA).....	27
Tools	28

Produced	Unit Type	Features and Changes
2014	Casement/Awning Narrow Frame	08/25/2014: Introduced Casement and Awning Narrow Frame products.
2015	Awning Narrow Frame	08/31/2015: Introduced Awning sash limiter option.
2017	Casement/Awning Narrow Frame	12/18/2017: Added availability of customer specified lite cut configurations for SDL with and without spacer bar and GBG, to include simulated check rail and allow any color GBG to the exterior only of standard and special sized units.
2018	Casement/Awning Narrow Frame	10/29/2018: Introduced Designer Black and Clear interior finishes and Matte Black (MBK) hardware option. Low E3 ERS glass type was added.
	Casement/Awning Narrow Frame	12/17/2018: Introduced textured glass types: Reed, Narrow Reed, Rain, Glue Chip and Frost and also colored glass types: Clear, Bronze, Gray and Green.
2019	Casement/Awning Narrow Frame	12/16/2019: Discontinued the sale of Wood Removable Grilles.
2020	Casement Narrow Frame	04/27/2020: Added WOCD field applied and replacement kits (see Product Bulletin 758).
	Casement/Awning Narrow Frame	08/31/2020: Added Custodial and Non-Custodial Sash Limiters.
2021	Casement/Awning Narrow Frame	08/30/2021: Wood profiles W11981, W12106 and W12107 were made available as a Configured Part in OMS (see Product Bulletin 791). 10/25/2021: Screen retention plunger. See Product Bulletin 799 for more information. Standard screen mesh changed to Marvin Bright View™. See product bulletin 793 for more information.
2022	Casement/Awning Narrow Frame	02/03/2022: Part numbers for wood profiles W11981, W12106 and W12107 were removed. These profiles are available as Configured Parts in OMS. 10/31/2022: Evergreen exterior discontinued. See Product Bulletin 851 for additional information.
2023	Casement/Awning Narrow Frame	02/27/2023: Gunmetal introduced. See Product Bulletin 863 for additional information. 06/26/2023: Nailing fin added as an optional installation method (refer to Elevate Accessories section for part numbers). See Product Bulletin 893 for additional information. 10/30/2023: An ERS coating became available as a standard option for current Triple Pane offerings. Low E3 was also added as a glass option to Triple Pane. See Product Bulletin 904 for more details.

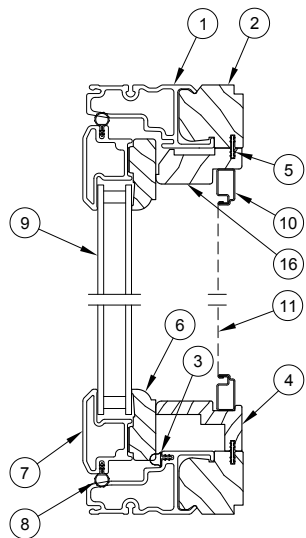

Head Jamb and Sill

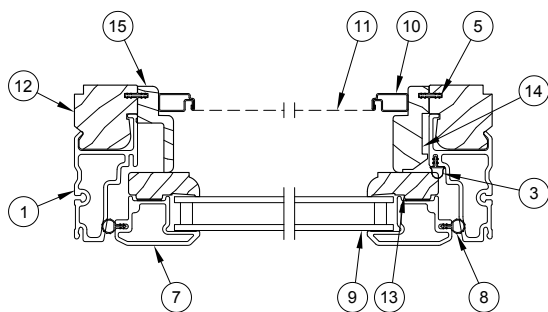

Jamb

1. Exterior Rail
2. Head Jamb Liner
3. Frame Weather Strip, V189
4. Hardware Cover, W11981
5. Connecting Barb, V803
6. Interior Wood Rail
7. Exterior Rail
8. Sash Weather Strip, V147
9. Insulating Glass
10. Screen Frame
11. Screen
12. Jamb Liner
13. Interior Wood Stile
14. Jamb Stop, Stationary, W12107
15. Jamb Stop, Operator, W12106
16. Jamb Stop, Head Jamb, W12107

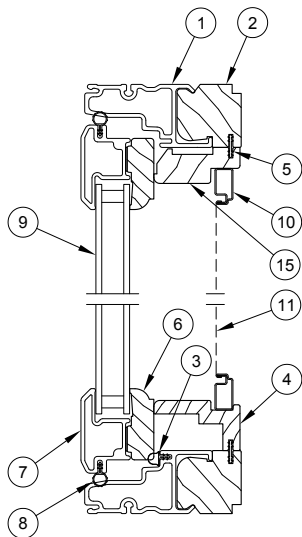

Head Jamb and Sill

1. Frame
2. Head Jamb Liner
3. Foam Weather Strip, V189
4. Hardware Cover, W11981
5. Connecting Barb, V803
6. Interior Rail
7. Exterior Rail
8. Sash Weather Strip, V147
9. Insulating Glass
10. Screen Frame
11. Screen
12. Jamb Liner
13. Stile
14. Jamb Stop, Stationary, W12106
15. Jamb Stop, Operator, W12107

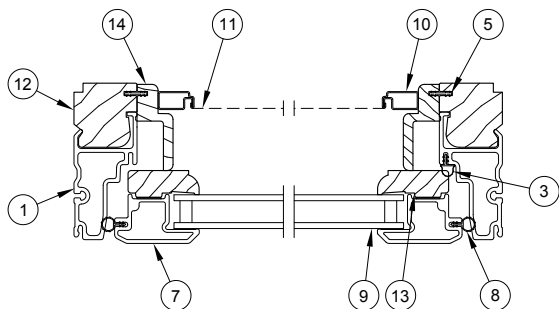

Jamb

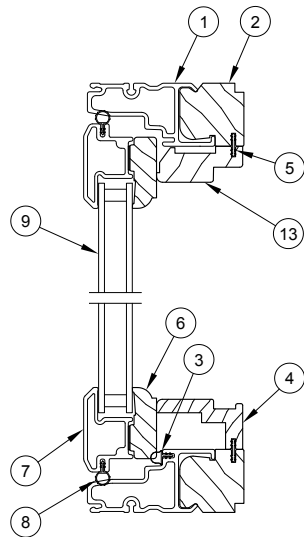

Head Jamb and Sill

1. Frame
2. Head Jamb Liner
3. Frame Weather Strip, V189
4. Hardware Cover, W11981
5. Connecting Barb, V803
6. Interior Wood Rail
7. Exterior Rail
8. Sash Weather Strip, V147
9. Insulating Glass
10. Jamb Liner
11. Interior Wood Stile
12. Jamb Stop. Stationary, W12107
13. Jamb Stop, Head Jamb, W12107

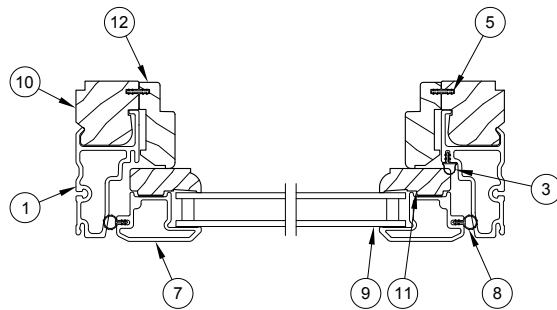

Jamb

Dyad Operator Roto Gear

Usage dates:

8/25/2014 to present

Casement		
Used on units with IO width less than 24 3/8"		
Color/Finish	RH PN	LH PN
E-Gard	10896280	10896279
Coastal	11862611	11862610

Suggested Fasteners	
Uses 4: #8 x 7/8" Type AB, Phillips flat head, stainless steel w/ZYC screws	
PN	11806102

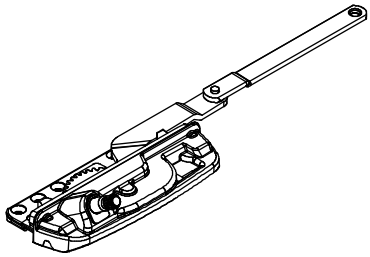

LH shown

Dual Arm Operator Roto Gear

Usage dates:

8/25/2014 to present

Casement		
Used on units with IO width 24 3/8" or greater		
Color/Finish	RH PN	LH PN
E-Gard	10896282	10896281
Coastal	11862606	11862605

Suggested Fasteners	
Uses 4: #8 x 7/8" Type AB, Phillips flat head, stainless steel w/ZYC screws	
PN	11806102

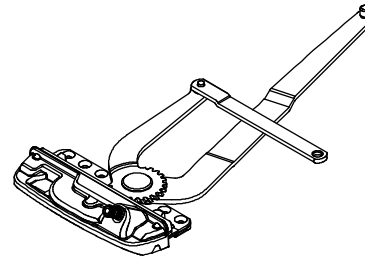

LH shown

Scissor Arm Operator

Usage dates:

8/25/2014 to present

Suggested Fasteners	
Uses 4: #8 x 7/8" Type AB, Phillips flat head, stainless steel w/ZYC screws	
PN	11806102

Awning	
Color/Finish	PN
E-Gard	10896278
Coastal	11862612

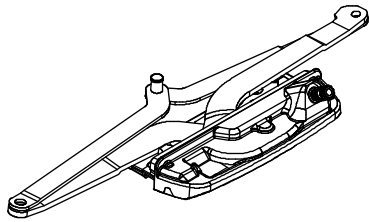

Folding Handle and Cover

Usage dates:

8/25/2014 to present

Casement		
Color	RH Dyad/LH Dual Arm PN	LH Dyad/RH Dual Arm PN
Almond Frost	10896251	10896250
White	10896254	10896253
Oil Rubbed Bronze	10896306	10896303
Satin Nickel	10896305	10896302
Brass	10896304	10896301
Matte Black	10896318	10896319

Awning	
Color	PN
Almond Frost	10896251
White	10896254
Oil Rubbed Bronze	10896306
Satin Nickel	10896305
Brass	10896304
Matte Black	10896318

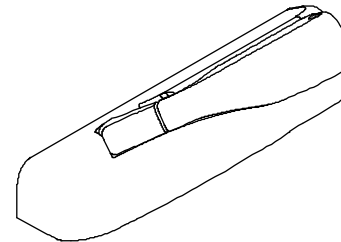

LH Dual Arm shown
(Casement)

Guide Track

Includes:

4 – #7 x 1 1/4", AB, Phillips flat head, Steel w/ZYC or Stainless Steel screws

Usage dates:

8/25/2014 to present

Casement	
Color/Finish	PN
E-Gard	10896276
Coastal	11896717

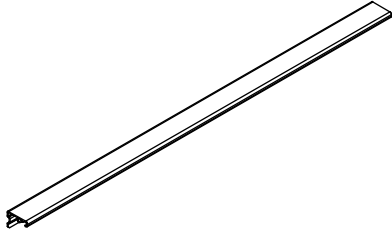

Guide Track Shoe

Usage dates:

8/25/2014 to present

Casement
PN
10896277

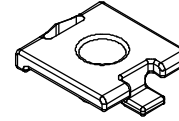

Stud Bracket

Includes:

4 – #7 x 1 1/4", Phillips flat head, Steel w/ZYC or Stainless Steel screws

Usage dates:

8/25/2014 to present

Casement		
Color/Finish	RH PN	LH PN
E-Gard	10896264	10896263
Coastal	11896719	11896718

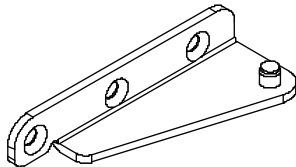

Stud Bracket

Includes:

4 – #7 x 1 1/4", Phillips flat head, Steel w/ZYC

Usage dates:

8/25/2014 to present

Awning
PN
10896274

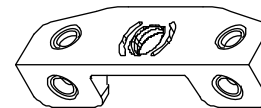

Hinge Arm Assembly

Includes:

4 – #7 x 5/8", Type AB-17, Phillips flat head, Steel w/ZYC screws

Used on:

All casement operators EXCEPT units with a Rough Opening of 27 1/8" - 29 63/64" (689 –762)

Usage dates:

8/25/2014 to present

Casement		
Color/Finish	LL-UR PN	UL-LR PN
E-Gard	10814754	10814755
Coastal	11896720	11896721

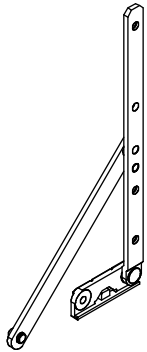

LL-UR Shown

This hinge is used on the bottom of a LH sash and top of a RH sash.

Hinge Arm Assembly, Egress

Includes:

4 – #7 x 5/8", Type AB-17, Phillips flat head, Steel w/ZYC screws

Used on:

Casement units with a Rough Opening of 27 1/8" - 29 63/64" (689 –762)

Usage dates:

8/25/2014 to present

Casement		
Color/Finish	LL-UR PN	UL-LR PN
E-Gard	10896273	10896272
Coastal	11896722	11896723

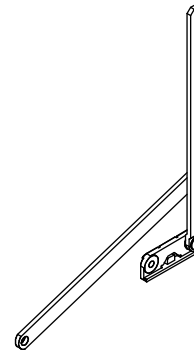

LL-UR Shown

This hinge is used on the bottom of a LH sash and top of a RH sash.

Adjustable Hinge Track

Includes:

3 – #7 x 5/8", Phillips flat head, UC, Stainless Steel screws

Usage dates:

8/25/2014 to present

Casement	
Color/Finish	PN
Stainless Steel	UL-LR 10896284
	LL-UR 10896283

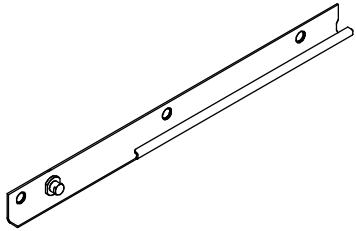

LL-UR shown

Hinge Limiter

Used on:

All casement operators with a Rough Opening of 30" (762) or greater

Usage dates:

8/25/2014 to present

Casement		
Color/Finish	RH PN	LH PN
Stainless Steel	11862601	11862602

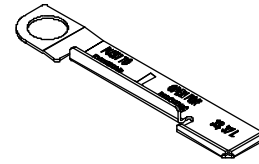

Hinge Arm Assembly

Includes:

4 – #7 x 5/8", Type AB-17, Phillips flat head, Steel w/ZYC screws

Usage dates:

E-Gard: 9/24/2007 to present; Coastal: 6/2/2008 to present

Awning		
Color/Finish	RH PN	LH PN
E-Gard	10813005	10813004
Coastal	11896731	11896730

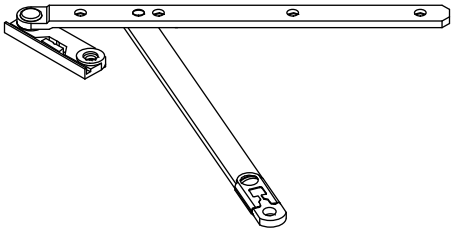

Stainless Steel Hinge Track Kit

Includes:

3 – #7 x 5/8", Tek-2, Phillips flat head screws

Usage dates:

9/24/2007 to present

Awning		
Color/Finish	RH PN	LH PN
Stainless Steel	11896733	11896732

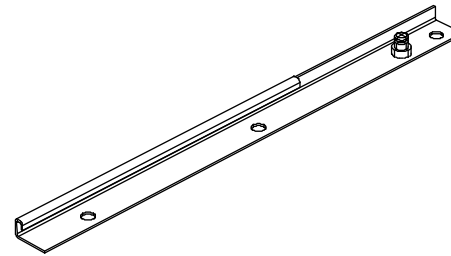

Detach Clip, Hinge

Usage dates:

8/25/2014 to present

PN
10814839

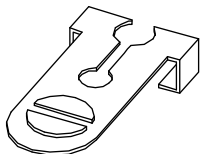

Lock Drive Handle and Escutcheon

Usage dates:

8/25/2014 to present

Casement and Awning	
Color	PN
Almond Frost	10895019
White	10895018
Oil Rubbed Bronze	10895020
Satin Nickel	10895021
Brass	10895022
Matte Black	10895023

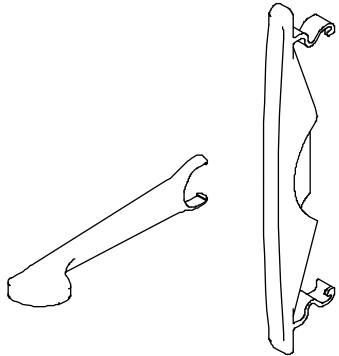

Lock Drive Assembly

Includes:

3 – #7 x 3/4", Type AB, Phillips flat head, Steel w/ZYC screws

Usage dates:

8/25/2014 to present

Casement and Awning
PN
10896265

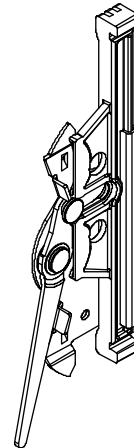

Tie Bar Assembly

Includes:

2 to 6 - #7 x 3/4" Phillips pan head, Stainless Steel screws

Usage dates:

8/25/2014 to present

Casement		
Sizing	E-Gard PN	Coastal PN
IO height 34 1/4" (869) or less	10896255	11862615
IO height 34 17/64" (870) to 42 1/4" (1073)	10896256	11862616
IO height 42 17/64" (1074) to 54 1/4" (1378)	10896257	11862617
IO height 54 17/64" (1379) to 61 1/4" (1555)	10896258	11862618
IO height 61 17/64" (1556) to 70 1/4" (1784)	10896259	11862619
IO height 70 17/64" (1785) or greater	10896260	11862620

Tie Bar Assembly

Includes:

2 - #7 x 3/4" Phillips pan head, Stainless Steel screws

Usage dates:

8/25/2014 to present

Awning		
Color/Finish	RH PN	LH PN
E-Gard	10896262	10896261
Coastal	11896735	11896734

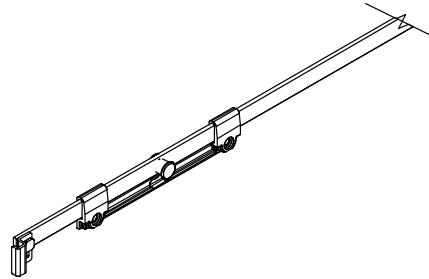

Keeper

Usage dates:

8/25/2014 to present

Casement and Awning		
Color/Finish	Handing	PN
E-Gard	RH	10896267
	LH	10896266
Black	RH	11862913
	LH	11862914
Coastal (Stainless Steel)	RH	11862613
	LH	11862614

Suggested Fasteners

Uses 2: #7 x 1 1/4" Phillips, flat head screw (color match)

E-Gard PN	Black PN	Coastal PN
11806105	11807137	11806108

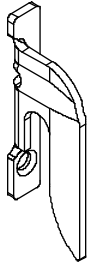

Keeper Shim

Usage dates:

8/25/2014 to present

Casement and Awning	
Color/Finish	PN
White	10500617
Black	10500618

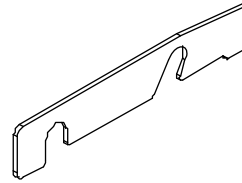

Concealed Snubber

Used on Units with a Rough Opening of greater than 39 5/8"

Includes:

2 - 5/32 x 5/16" Peel Rivets

Usage dates:

8/25/2014 to present

PN
11841111

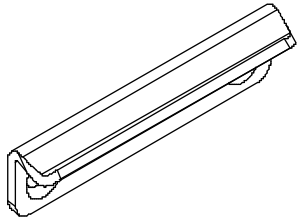

Interlocking Snubber

Used on Sash and Frame with a Rough Opening sizes greater than 63 5/8" and impacts Rough Opening sizes greater than 39 5/8"

Includes:

2 - #8 x 5/8" Phillips flat head, UC, Stainless Steel screws

Usage dates:

8/25/2014 to present

PN
10896275

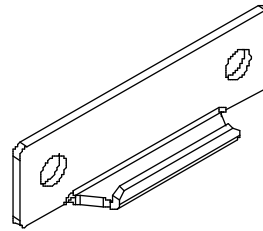

Sash Snubber

Used on Sash with a Rough Opening of greater than 39 5/8"

Includes:

2 - #7 x 5/8" Phillips flat head, UC, Stainless Steel screws

Usage dates:

8/25/2014 to present

PN
11873231

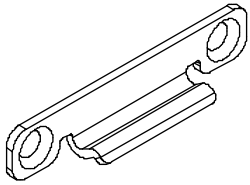

Stationary Bracket

Includes:

- 2 - #8 x 1" Type AB, Phillips flat head, Steel w/ZYC screws
- 2 - #8 x 1/2" Type AB, Phillips flat head, Steel w/ZYC screws

Usage dates:

8/25/2014 to present

Casement and Awning	
Color/Finish	PN
Standard	10896297
Coastal	11896736

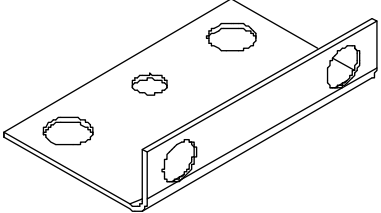

WOCD Field Applied and Replacement Kit

Includes:

- 1 – Field installation instructions
- 1 – Hang tag
- 2 – Safety and operating instructions
- 1 – WOCD sticker
- 1 – Casement WOCD tether assembly
- 1 – Casement WOCD locking assembly
- 2 – #8–15 x 1 1/2 flat head screw
- 2 – #8–18 x 3/4 Torx T20screw, AB

NOTE: All covers for units must be ordered separately.

Casement	
Color	PN
Stone White	11903901
Almond Frost	11903902
Matte Black	11903903

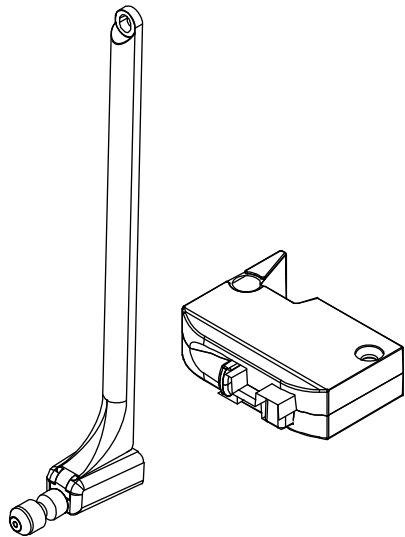

NOTE: For windows without factory-applied WOCD, refer to Product Bulletin 758 for more information.

Custodial Sash Limiter, 3" Travel

NOTE: Casement units must have a frame width of 23 or greater. 2 sash limiters are required for frame height 60 and greater.

NOTE: Awning units must have a frame height of 23 or greater. 2 sash limiters are required on all sizes.

Includes:

- 1 – Sash limiter arm assembly, includes retaining ring (custodial)
- 1 – Sash limiter track
- 2 – #8 X 3/8 T20 Torx screw
- 2 – 5/32 diameter x 5/16 peel rivet
- 1 – T20 Torx tamperproof bit
- 1 – Field installation instructions

Usage dates:

8/31/2020 to present

Casement and Awning
PN
11850763

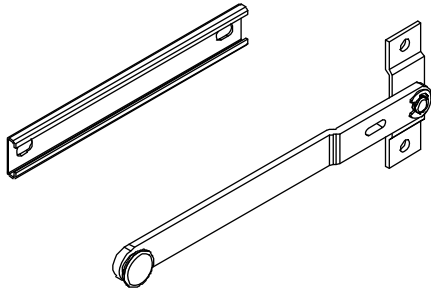

Non-Custodial Sash Limiter, 3" Travel

NOTE: Casement units must have a frame width of 23 or greater. 2 sash limiters are required for frame height 60 and greater.

NOTE: Awning units must have a frame height of 23 or greater. 2 sash limiters are required on all sizes.

Includes:

- 1 – Sash limiter arm assembly (non-custodial)
- 1 – Sash limiter track
- 2 – #8 X 3/8 T20 Torx screw
- 2 – 5/32 diameter x 5/16 peel rivet
- 1 – T20 Torx tamperproof bit
- 1 – Field installation instructions

Usage dates:

8/31/2020 to present

Casement and Awning
PN
11850764

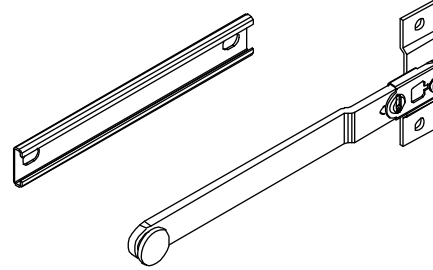

Sash Limiter, Awning

Usage dates:

8/31/2015 to 8/30/2020

PN
11860938

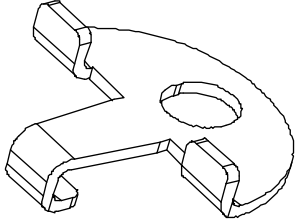

Sill Installation Filler

V1203

Usage dates:

8/25/2014 to present

Color	Length	PN
White	108" (2743)	105074

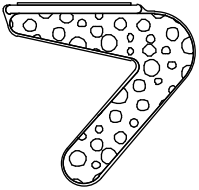

Ordering specifications for Configured Parts in OMS:

1. Unit handing;
2. Interior and exterior color;
3. Unit size (call number, rough opening or frame size);
4. Location of cover (from exterior view);
 - a. Top,
 - b. Sill,
 - c. Left jamb,
 - d. Right jamb.

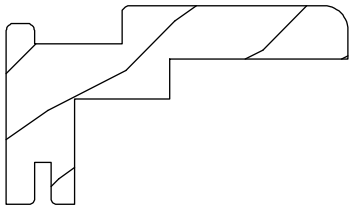

Hardware Cover
W11981

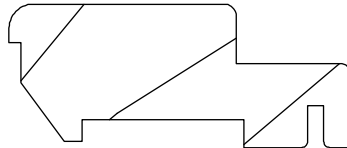

Head Jamb/Jamb Stop
W12107

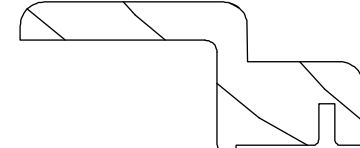

Jamb Stop - Lock Side
W12106

Frame Weather Strip

V189

Usage dates:

8/25/2014 to present

Head Jamb/Sill		
Color	Length	PN
Black	13 31/32" (355)	17003000
	17 31/32" (456)	17003002
	21 31/32" (558)	17003004
	25 31/32" (660)	17003006
	29 31/32" (761)	17003008
	33 31/32" (863)	17003010
	37 31/32" (964)	17003011
	45 61/64" (1167)	17003012
	53 61/64" (1370)	17003014
	69 61/64" (1777)	17003015

Jamb		
Color	Length	PN
Black	13 23/32" (349)	17003016
	17 3/32" (434)	17003018
	21 3/32" (536)	17003020
	25 3/32" (637)	17003021
	29 3/32" (739)	17003022
	33 3/32" (841)	17003024
	37 3/32" (942)	17003026
	41 7/32" (1047)	17003028
	45 5/64" (1145)	17003030
	53 5/64" (1348)	17003032
	57 5/64" (1450)	17003034
	61 5/64" (1551)	17003036
	69 5/64" (1755)	17003038

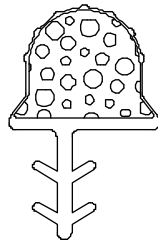

Sash Weather Strip

V147

Usage dates:

8/25/2014 to present

Rail		
Color	Length	PN
Black	14 9/32" (363)	17001917
	18 9/32" (464)	17001921
	22 9/32" (566)	17001925
	26 9/32" (668)	17001929
	30 9/32" (769)	17001933
	34 9/32" (871)	17001937
	38 9/32" (972)	17001941
	46 9/32" (1176)	17001949
	54 9/32" (1379)	17001957
	70 9/32" (1785)	17001973

Stile		
Color	Length	PN
Black	14 1/32" (356)	17001916
	17 13/32" (442)	17001919
	21 13/32" (544)	17001923
	25 13/32" (645)	17001927
	29 13/32" (747)	17001931
	33 13/32" (849)	17001935
	37 13/32" (950)	17001939
	41 17/32" (1055)	17001943
	45 13/32" (1153)	17001947
	53 13/32" (1357)	17001955
	57 13/32" (1458)	17001959
	61 13/32" (1560)	17001963
	69 13/32" (1763)	17001971

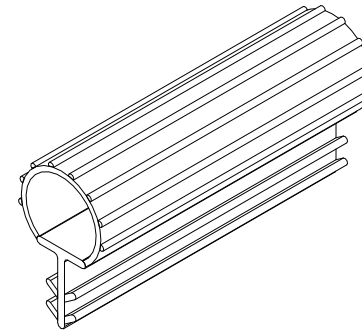

For replacement sash specify:

1. Size (using included chart)
2. Operation: Stationary, transom, picture, or left or right hand operator (see handing example)
3. Exterior color
4. Interior finish
5. Glazing
6. If the unit has a Window Opening Control Device (WOCD) on the sash, specify on order

Sash Sizes for Casement and Awning Narrow Frame manufactured 2014 to present

Daylight Opening to Sash OM

Daylight Width + 3 17/32" = OM Width of Sash

Daylight Height + 3 17/32" = OM Height of Sash

NOTE: Sash is not reglazable; glass replacement will require a new sash.

Replacement sash are marked for hardware application (hardware not included).

Replacement Casement sash for units with the window opening control device (WOCD) will have the tether applied.

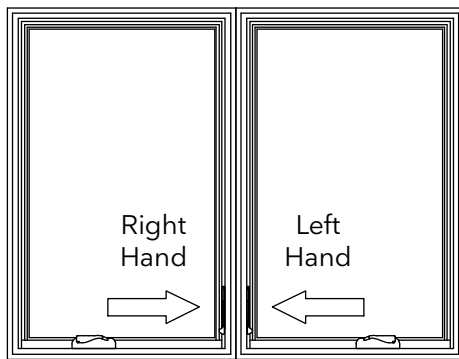

Interior view shown

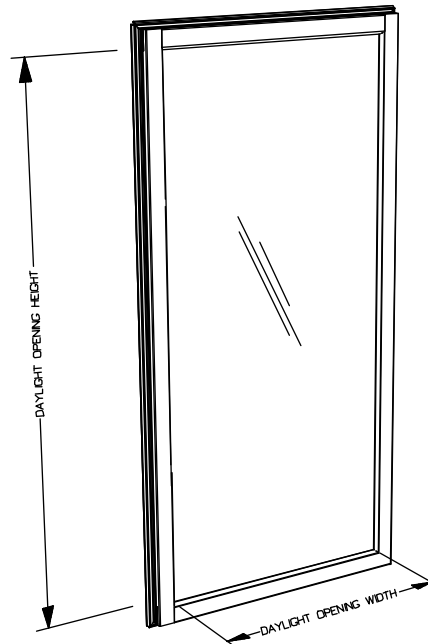

Casement (shown) Interior View

NOTE: Daylight opening is the measurement of visible glass.

For replacement screen specify:

1. Size (determine the outside measurement (OM) of the existing screen. If not available, determine the size of the screen by using the conversion chart shown below.
2. Aluminum or aluminum with bare wood veneer interior
3. Color

Daylight Opening to OM of Screen

Daylight Opening is the measurement of visible glass

Daylight Width + 1 5/8" = OM Width of Screen (Aluminum)

Daylight Height + 1 15/64" = OM Height of Screen (Aluminum)

Daylight Width + 1 9/16" = OM Width of Screen (with Wood Veneer)

Daylight Height + 1 3/16" = OM Height of Screen (with Wood Veneer)

NOTE: OM of aluminum screens include corner keys. Wood veneer screens have no visible corner keys.

NOTE: Screens feature plunger type mounting system.

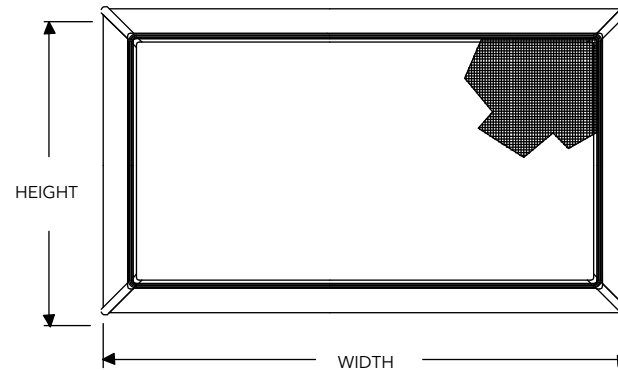

Screen Plunger Kit

Includes:

- 1 - Plunger spring
- 1 - Plunger
- 1 - Plunger cap

Usage dates:

07/01/2023 to present

PN
11851059

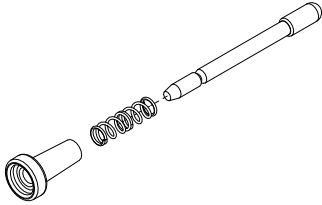

Screen Grommet

Usage dates:

8/14/2014 to present

Color	PN
Beige	05070412
Black	05070413
White	05070414

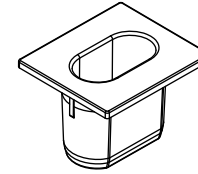

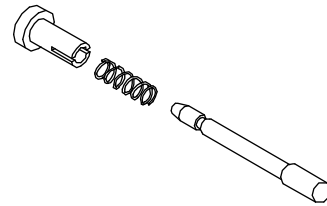

Plunger and Spring Assembly

Clear cap, Off White bolt

Used until 06/30/2023, replace with current.

3/8" Open Ended Wrench

PN
10814840

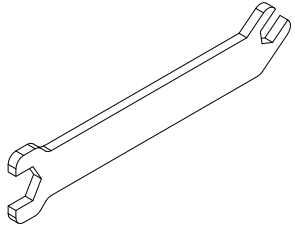

T20 Torx Tamper Proof Bit

Usage dates:

8/31/2020 to present

PN
02071481

