



# Modern MultiSlide Door

## Replacement Parts

Specifications and technical data are subject to change without notice.

Numbers listed in ( ) parentheses are metric equivalents in millimeters rounded to the nearest whole number.

Suggested fasteners are not included and must be ordered separately.

Illustrations are not to scale.

## Contents

Product History.....	2
Part Identification - Pocket/Stacked Head Jamb and Sill Details .....	3
Part Identification - Stacked Jamb Details.....	4
Part Identification - Pocket Jamb Details.....	5
Replacement Panels and Sills .....	6
Installation Parts.....	7
Installation Kit Parts - Uni-Directional Stacked Kit.....	11
Installation Kit Parts - Uni-Directional Pocket Kit.....	12
Installation Kit Parts - Bi-Parting Stacked Kit.....	13
Installation Kit Parts - Bi-Parting Pocket Kit .....	14
Handles .....	15
Operators.....	16
Locking Hardware.....	17
Lock Status Sensor Parts.....	19
Automatic Control Parts .....	20
Automatic Control Parts - Locally Sourced.....	24
Miscellaneous Parts .....	25
Miscellaneous Parts - Discontinued No Availability (NA).....	32
Aluminum Parts .....	33
Aluminum Parts - Fabricated.....	36
Vinyl Parts.....	40
Vinyl Parts - Fabricated .....	42
Vinyl Parts - Discontinued No Availability (NA) .....	43
Weather Strip.....	44
Screen Handing Diagram.....	45
Retractable Screen SE4 Parts Configured Parts in OMS.....	46
Retractable Screen SE4 Parts.....	47
Scenic Door Sliding Screen Parts - Disc LA Pre 4/27/20 .....	51

Produced	Unit Type	Features and Changes
2018	Modern MultiSlide Door	10/29/2018: Introduced the Modern MultiSlide Door.
2019	Modern MultiSlide Door	4/29/2019: Added Stone White Hardware, Exterior Jamb/Head Jamb cover F2065 was replaced with A3476.
2020	Modern MultiSlide Door	4/27/2020: Scenic Door Modern Sliding Screen transitions to the SE4 Retractable Screen.
2021	Modern MultiSlide Door	12/13/2021: A new Sliding Door Automatic Control (SDAC) system will be available on Ultimate and Modern multi-slide door products with the OMS version 3.12 on December 13, 2021. See Product Bulletin #805 for additional information and Product Bulletin #837 for installation requirements.
2023	Modern MultiSlide Door	10/30/2023: An ERS coating became available as a standard option for current Triple Pane offerings. See Product Bulletin 904 for additional information
2024	Modern MultiSlide Door	2/26/2024: Additional 2-track configurations became available. See Product Bulletin 917 for additional information. Automated parts added to allow the MultiSlide door to integrate with the Marvin Connected Home app. See Product Bulletin 906 for additional information. 8/26/2024: The Scenic Retractable Screen is now available up to Nominal 12 ft height. See Product Bulletin 944 for additional information.
2025	Modern MultiSlide Door	12/15/2025: New accessory kerf integrated into the frame A 2" exterior mull cap was added. See Product Bulletin 996 for additional information.

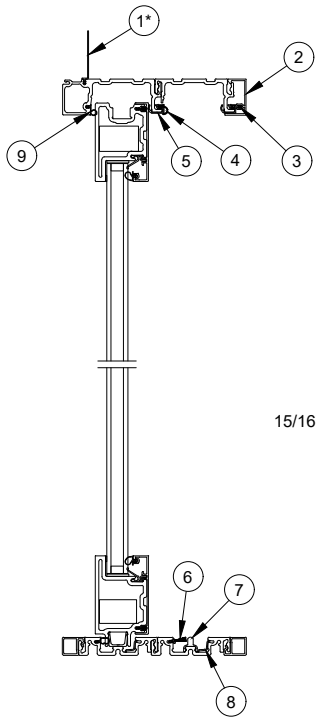

15/16" Glass

Stationary/Pocket Panel  
Head Jamb and Sill

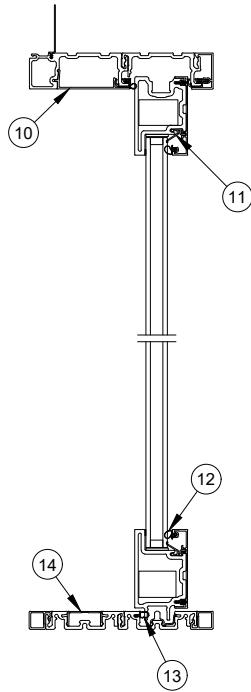

Primary/Inactive Panel  
Head Jamb and Sill

1. Nail Fin, V2920\*
2. Frame Liner, A3248
3. Connecting Barb, V803
4. Head Jamb Weather Strip, V2977
5. Frame Clip, V03263
6. Pile Weather Strip, V2493
7. Roller Track, V2426
8. Sill Slot Cover, A3420
9. Frame Weather Strip, V2475
10. Jamb/Head Jamb Exterior Cover, A3476
11. Glazing Clip, V2874
12. Interior Glazing Seal, V2949
13. Sill Bulb Weather Strip, V2564
14. Sill Track Cover, A2736
15. Sill Liner, A3245
16. Performance Sill Liner, A3247
17. High Performance Sill Liner Nosing, A2863
18. High Performance Sill Liner, A3246

\*Not included on Pocket Door

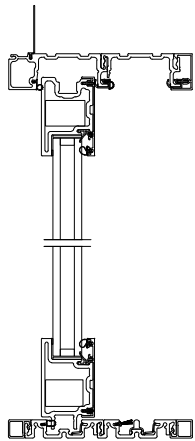

1 1/4" Glass

Stationary/Pocket Panel  
Head Jamb and Sill

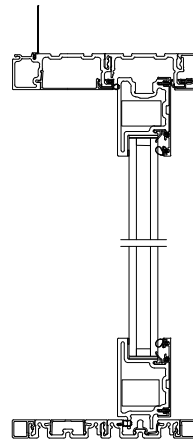

Primary/Inactive Panel  
Head Jamb and Sill

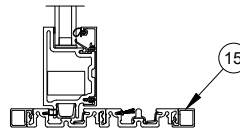

Flush Sill Option

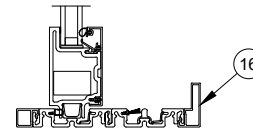

Performance Sill Option

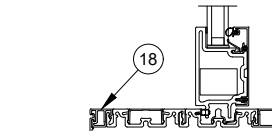

High Performance Sill Option

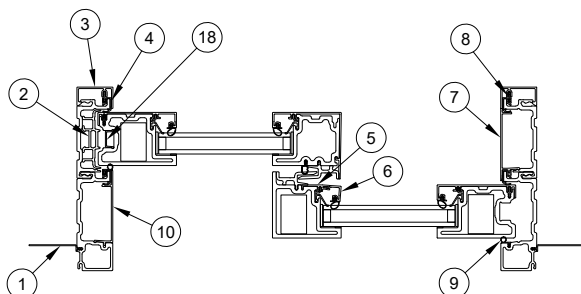

Stacked Uni-directional Jamb Detail

1. Nail Fin, V2920
2. Jamb Filler, V2915
3. Frame Liner, A3248
4. Frame Clip, V03263
5. Exterior, Interlocking Stile Clad Connector, V2966
6. Frame Clip, V03263
7. Jamb/Head Jamb Interior Cover, A3244
8. Connecting Barb, V803
9. Frame Weather Strip, V2475
10. Jamb/Head Jamb Exterior Cover, A3476
11. Clad, Locking/Stationary Stile 15/16" Glass, A3362
12. Glazing Clip, 15/16" Glass, V2874
13. Clad, Interior Interlock Stile, A3363
14. Clad, Locking Stile, Bi-Parting 15/16" Glass, A3366
15. Interlock, V2875
16. Bulb Weather Strip, Sill and Panel, V2564
17. Interior Glazing Seal, V2949
18. Cover, Locking Stile, V2885
19. Clad, Locking/Stationary Stile, 1 1/4" Glass, A3349
20. Glazing Clip, 1 1/4" Glass, V2886
21. Clad, Interior Interlock Stile, 1 1/4" Glass, A3350
22. Clad, Locking Stile, Bi-Parting 1 1/4" Glass, A3352
23. Bi-parting Meeting Stile Weather Strip, V2968

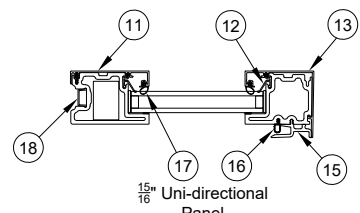

15/16" Uni-directional Panel

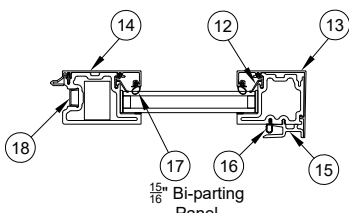

15/16" Bi-parting Panel

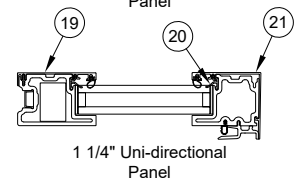

1 1/4" Uni-directional Panel

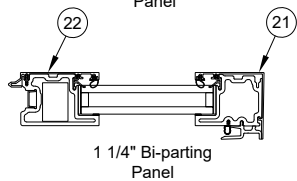

1 1/4" Bi-parting Panel

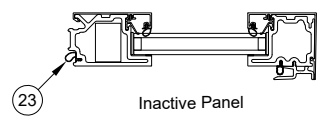

Inactive Panel

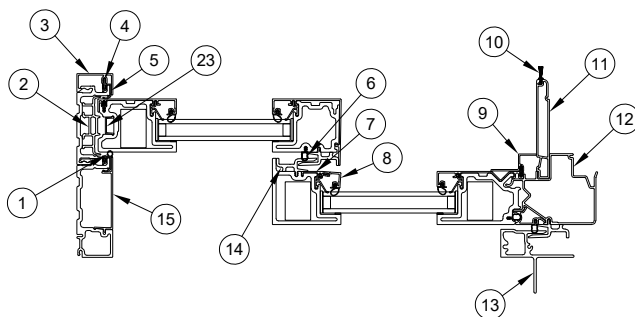

Pocket Uni-directional Jamb Detail

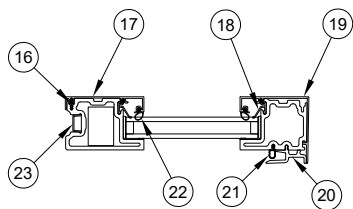

15/16" Uni-directional Panel

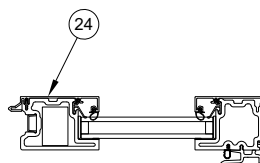

15/16" Bi-parting Panel

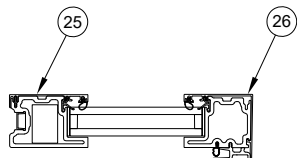

1 1/4" Uni-directional Panel

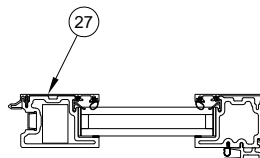

1 1/4" Bi-parting Panel

1. Frame Weather Strip, V2475
2. Jamb Filler, V2915
3. Frame Liner, A3248
4. Connecting Barb, V803
5. Frame Clip, V03263
6. Bulb Weather Strip, Sill and Panel, V2564
7. Exterior, Interlocking Stile Clad Connector, V2966
8. Clad, Exterior Interlocking Stile, A3409
9. Pocket Cover Trim, A3291
10. Pile Weather Strip, V2493
11. Pocket Cover, A3293
12. Pocket Interlock Support Block, A3313
13. Pocket Frame Interlock
14. Interlock, V2875
15. Jamb/Head Jamb Exterior Cover, A3476
16. Connecting Barb, V803
17. Clad, Locking Stile, Bi-Parting 15/16" Glass, A3362
18. Glazing Clip, V2874
19. Clad, Interlocking Stile, 15/16" Glass, A3363
20. Interlock, V2874
21. Bulb Weather Strip, Sill and Panel, V2564
22. Interior Glazing Seal, V2949
23. Locking Stile Cover, V2885
24. Clad, Locking Stile, Bi-Parting 15/16" Glass, A3366
25. Clad, Locking/Stationary Stile, 1 1/4" Glass, A3354
26. Clad, Interior Interlocking Stile 1 1/4" Glass, A3350
27. Clad, Locking Stile, Bi-Parting 1 1/4" Glass, A3352

**To order complete Replacement Panels and/or Replacement Sills, refer to Configured Parts in OMS.**

## Sill Corner Key

### Includes:

- 1 - Key, jamb to sill
- 2 - #8 x 1 3/4", TEK 2, Torx, Pan head stainless steel screws
- 2 - #8 x 1/2" full thread, Torx, Pan head stainless steel screws

Handing	Color	PN
LH	Black	11862438
RH		11862439

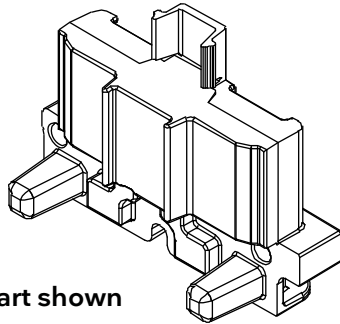

LH part shown

## Exterior Frame Hollow Corner Key

Color	PN
Black	10501347

Suggested Fasteners	PN
4 - #8 x 1/2" full thread, Torx, Pan head stainless steel screw	11800147

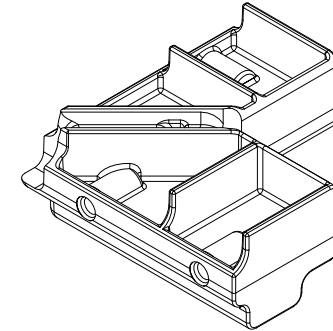

## Head Jamb Corner Key Kit

### Includes:

- 1 - Key, Jamb to head jamb
- 4 - #8 x 1/2" full thread, Torx, Pan head stainless steel screws

Color	PN
Black	11862441

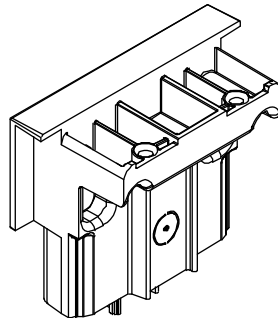

## Head Jamb Corner Key, Exterior

### Includes:

- 1 - Key, jamb to head jamb, exterior
- 4 - #8 x 1/2" full thread, Torx, Pan head stainless steel screws

Color	PN
Black	11862442

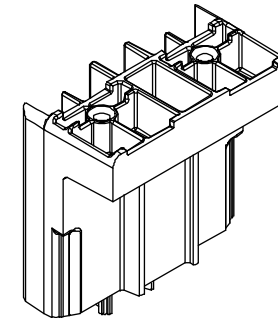

## Exterior Frame Hollow Splice Key

Color	PN
Black	10501348

Suggested Fasteners	PN
4 - #8 x 1/2" full thread, Torx, Pan head stainless steel screw	11800147

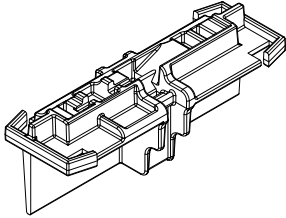

## Exterior Flat Shim

Adhesive backed

Qty	PN
Pkg of 20	11102179

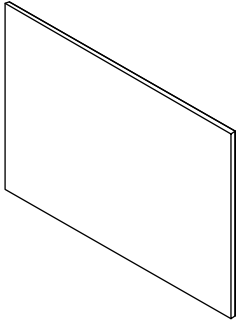

## Interior Flat Shim

Adhesive backed

Qty	PN
Pkg of 20	11102180

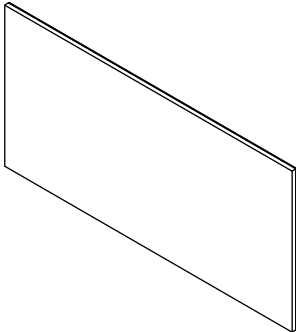

## Interior Counter Shim

Color	PN
Black	11102175

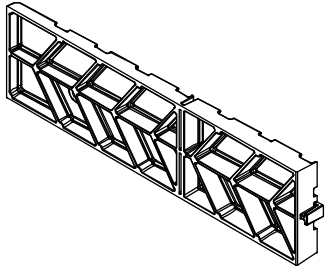

## Middle Counter Shim

Color	PN
Black	11102174

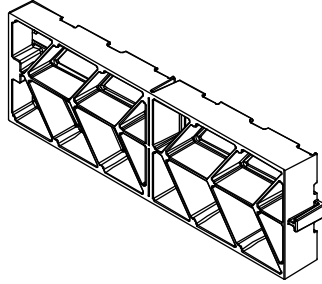

## Exterior Counter Shim

Color	PN
Black	11102176

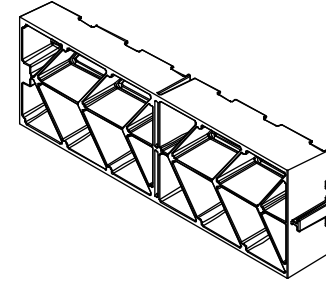

## Installation Tools Kit

### Includes:

1 - Long arm Allen wrench, M5

### Usage dates:

4/26/2021 to present

PN
11862829

No illustration available

## Fastener Kit, Black Bag\*

### Includes:

25 - #8-12 x 3" Torx T20, pan head, 2/3 thread screws

### Products:

All windows and doors

Color	PN 25/bag	PN 200/box
Matte Black	11862478	11862477

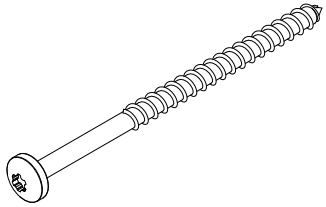

## Fastener Kit, Green Bag\*

### Includes:

16 - #8-18 x 1 3/4" Tek-2, pan head, Torx T20, full thread screws

### Products:

All windows and doors

Color	PN 16/bag
Stainless Steel	11862476

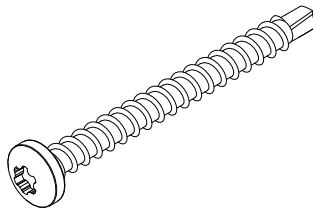

## Fastener Kit, Red Bag\*

### Includes:

16 - #8-18 x 1/2" Type AB, full thread screws

### Products:

All windows and doors

Color	PN 16/bag
Stainless Steel	11862475

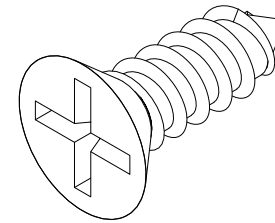

\*NOTE: Colors refer to color coded bags.

Parts in Kit	Uni-Directional Stacked				
	OX/XO	OXO/XXO	OXXX/ XXXXO	OXXXX/ XXXXXO	OXXXXX/ XXXXXXO
	Part Number				
	11862449	11862450	11862451	11862452	11862453
	Quantity in Kit				
Pocket Bumper/2 per kit	0	0	0	0	0
Pocket Cover Support Bracket Kit	0	0	0	0	0
Bumper, .532"	0	0	0	0	0
Gasket, Pocket Interlock (Includes both LH and RH gasket)	0	0	0	0	0
Screw, #8 x 15 x 2.500" 2/3 thread	0	0	0	0	0
Stationary Bracket Kit	1	1	1	1	1
Shoot Bolt Strike Kit	0	0	0	0	0
Screw, #8 x 15 x 3", 2/3 thread	1	1	1	1	1
Header Part Stop Foam Seal	1	2	3	4	5
Sill Drain Filter	1	2	3	4	5
Bumper, .125"	2	0	0	0	0
Panel Bumper Kit (Panel A to B)	0	1	1	1	1
Panel Bumper Kit (Panel B to B)	0	0	1	2	3
Stile Plug, Inactive Interior Interlock	1	2	3	4	5
Screw, #8 x 1.750, Tek-2	1	1	2	2	2
Screw, #8 x .500 Torx	1	2	2	2	2
Dust Block, 1/2" x 1 1/2" x 1/2" Pile	4	4	4	4	4

Parts in Kit	Uni-Directional Pocket					
	PX/XP	PXX/XXP	PXXX/XXXP	PXXXX/XXXXP	PXXXXX/XXXXXP	PXXXXXX/XXXXXP
	Part Number					
	11862454	11862455	11862456	11862457	11862458	11862459
	Quantity in Kit					
Pocket Bumper/2 per kit	1	1	1	1	1	1
Pocket Cover Support Bracket Kit	0	0	0	1	1	1
Bumper, .532"	0	0	2	2	2	2
Gasket, Pocket Interlock (Includes both LH and RH gasket)	1	1	1	1	1	1
Screw, #8 x 15 x 2.500" 2/3 thread	1	1	1	1	1	1
Stationary Bracket Kit	0	0	0	0	0	0
Shoot Bolt Strike Kit	0	0	0	0	0	0
Screw, #8 x 15 x 3", 2/3 thread	1	1	1	1	1	1
Header Part Stop Foam Seal	0	1	2	3	4	5
Sill Drain Filter	0	1	2	3	4	5
Bumper, .125"	0	2	0	0	0	0
Panel Bumper Kit (Panel A to B)	0	0	1	1	1	1
Panel Bumper Kit (Panel B to B)	0	0	0	1	2	3
Stile Plug, Inactive Interior Interlock	0	1	2	3	4	5
Screw, #8 x 1.750, Tek-2	3	3	3	3	4	4
Screw, #8 x .500 Torx	1	1	2	2	2	2
Dust Block, 1/2" x 1 1/2" x 1/2" Pile	4	4	4	4	4	4

Parts in Kit	Bi-Parting Stacked			
	OX-XO	OXX-XXO	OXXX-XXXO	OXXXX-XXXXO
	Part Number			
	11862460	11862461	11862462	11862463
	Quantity in Kit			
Pocket Bumper/2 per kit	0	0	0	0
Pocket Cover Support Bracket Kit	0	0	0	0
Bumper, .532"	0	0	0	0
Gasket, Pocket Interlock (Includes both LH and RH gasket)	0	0	0	0
Screw, #8 x 15 x 2.500" 2/3 thread	0	0	0	0
Stationary Bracket Kit	2	2	2	2
Shoot Bolt Strike Kit	1	1	1	1
Screw, #8 x 15 x 3", 2/3 thread	0	0	0	0
Header Part Stop Foam Seal	2	4	6	8
Sill Drain Filter	2	4	6	8
Bumper, .125"	4	0	0	0
Panel Bumper Kit (Panel A to B)	0	2	2	2
Panel Bumper Kit (Panel B to B)	0	0	2	4
Stile Plug, Inactive Interior Interlock	2	4	6	8
Screw, #8 x 1.750, Tek-2	1	1	2	2
Screw, #8 x .500 Torx	1	2	2	2
Dust Block, 1/2" x 1 1/2" x 1/2" Pile	0	0	0	0

Parts in Kit	Bi-Parting Pocket				
	PX-XP	PXX-XXP	PXXX-XXXP	PXXXX-XXXXP	PXXXXX-XXXXXP
	Part Number				
	11862464	11862465	11862466	11862467	11862468
	Quantity in Kit				
Pocket Bumper/2 per kit	1	1	1	1	1
Pocket Cover Support Bracket Kit	2	2	2	2	2
Bumper, .532"	0	0	0	2	2
Gasket, Pocket Interlock (Includes both LH and RH gasket)	0	0	4	4	4
Screw, #8 x 15 x 2.500" 2/3 thread	1	1	1	1	1
Stationary Bracket Kit	2	2	2	2	2
Shoot Bolt Strike Kit	0	0	0	0	0
Screw, #8 x 15 x 3", 2/3 thread	1	1	1	1	1
Header Part Stop Foam Seal	0	0	0	0	0
Sill Drain Filter	0	2	4	6	8
Bumper, .125"	0	2	4	6	8
Panel Bumper Kit (Panel A to B)	0	4	0	0	0
Panel Bumper Kit (Panel B to B)	0	0	2	2	2
Stile Plug, Inactive Interior Interlock	0	2	4	6	8
Screw, #8 x 1.750, Tek-2	5	5	5	6	6
Screw, #8 x .500 Torx	1	1	2	2	2
Dust Block, 1/2" x 1 1/2" x 1/2" Pile	0	0	0	0	0

## Trim Set, Active Keyed

Handing	Color	PN
LH	Matte Black	10501558
	Matte Bronze	10501559
	Satin Nickel	10501560
	Silver	10501561
	Stone White	10501571
RH	Matte Black	10501562
	Matte Bronze	10501563
	Satin Nickel	10501564
	Silver	10501565
	Stone White	10501572

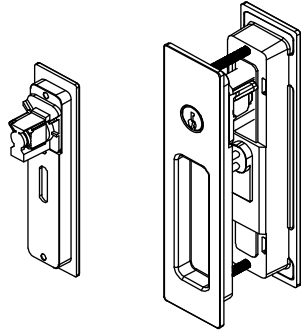

## Trim Set, Active, Non-Keyed

Color	PN
Matte Black	10501583
Matte Bronze	10501584
Satin Nickel	10501585
Silver	10501586
Stone White	10501574

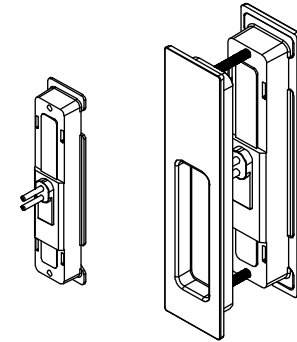

## Trim Set, Inactive

Color	PN
Matte Black	10501566
Matte Bronze	10501567
Satin Nickel	10501568
Silver	10501569
Stone White	10501573

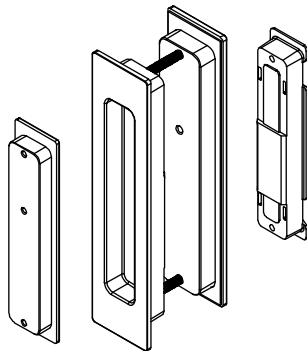

## Edge Pull Kit - Pocketing Units

### Includes:

- 1 - Edge pull
- 2 - #7-19 x 7/8" Type AB Phillips head screws

Color	PN
Satin Chrome	11862432

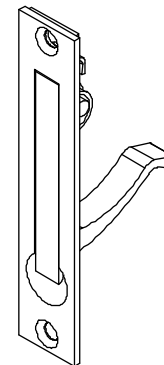

## Trim Set, Keyed Cylinder

### Includes:

- 2 - Keys

NOTE: For keyed alike cylinders, please contact your Marvin representative. Please supply the original order number, if available.

PN
10830174

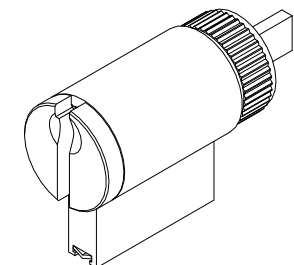

## Roller, Hoppe (Series 360) Kit

### Includes:

- 1 - Roller
- 2 - #8 -19 x 1/2" Torx Phillips head screws

Color	PN
Stainless Steel	11862431

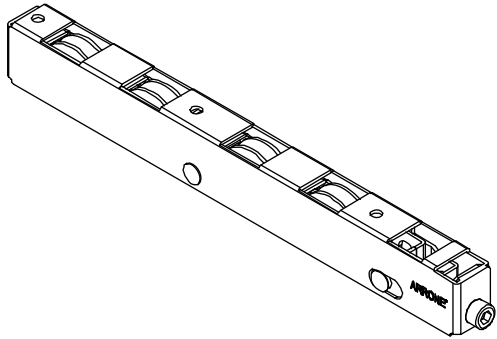

## Lock Box Kit

### Includes:

- 1 - Lock box
- 7 - #7-10 x 7/8" Type AB Phillips head screws

PN
11862430

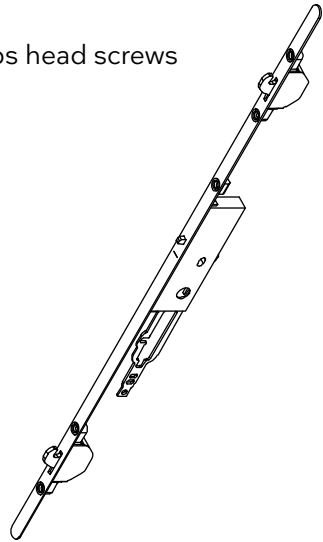

## Flush Bolt Rod

### Includes:

- 1 - Locking rod with end bolt

Length	PN
11 1/32"	05700180
27 1/32"	05700185
34 9/32"	05700170
41 15/16"	05700177
51 7/16"	05700179
63 7/16"	05700191

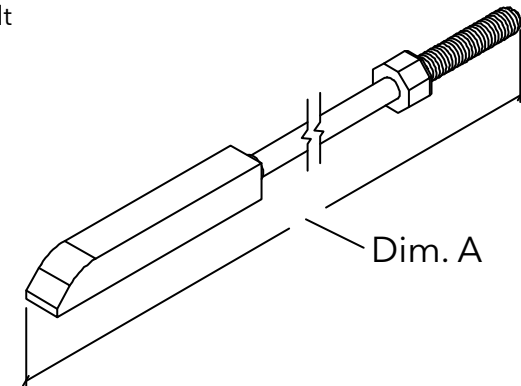

## Jamb Strike Kit

### Includes:

- 1 - Strike
- 3 - #8-18 x 1/2" type AB Phillips head screws
- 4 - #8-15 x 3" 2/3 thread Phillips head screws

Color	PN
Stainless Steel	11862435

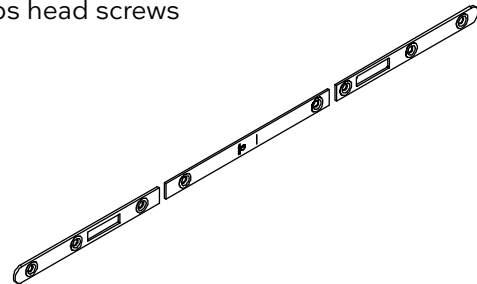

## Panel Strike Kit

### Includes:

- 1 - Strike
- 7 - #7-19 x 7/8" type AB Phillips head screws

Color	PN
Stainless Steel	11862434

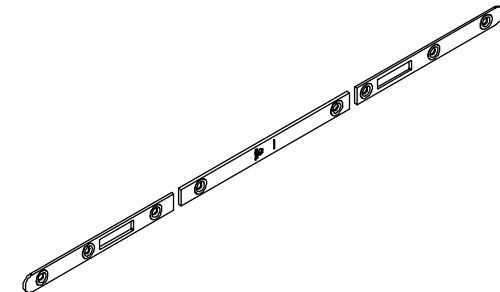

## Shoot Bolt Strike Kit

### Includes:

- 1 - Strike, shoot bolt
- 2 - #10-12 x 3", 2/3 thread, Torx T20 head screws

Color	PN
Black	11862425

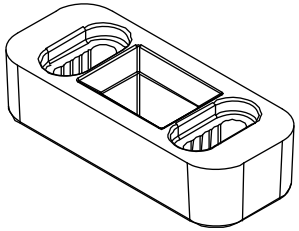

## Shoot Bolt Guide

PN
10501544

Suggested Fasteners	PN
1 - #8 x 1" TEK-3, Phillips, pan head screw	11800180

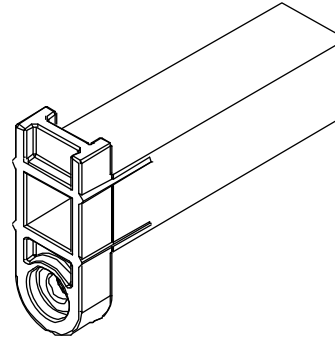

## Flush Bolt Assembly

Color	PN
Black	11101780

Suggested Fasteners	PN
2 - #7-19 x 7/8" Type AB, full thread, P2, Phillips head, stainless steel screws	11800777

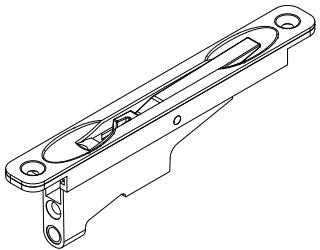

## Flush Bolt Trim Cover

### Includes:

- 1 - Flush bolt trim cover
- 2 - #7-19 x 7/8" Type AB, full thread, P2, Phillips head, stainless steel screws

PN
11862433

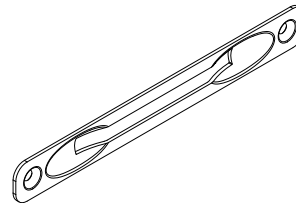

## Magnet Assembly Housing

Color	PN
Black	10815371

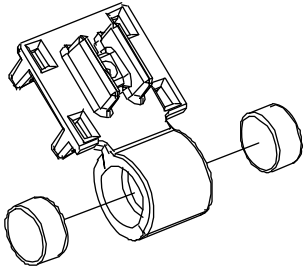

## Turnbuckle Assembly

### Includes:

- 1 - Turnbuckle
- 2 - 1/4-20 x 1" full thread, flat head P3 screw

Handing	PN
LH	10507605
RH	10507606

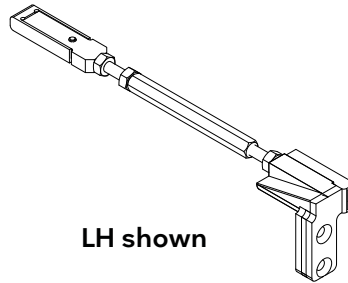

## Turnbuckle Barrel

Length	PN
4"	10507628
10"	10507629

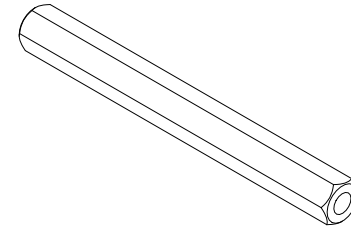

## Transmitter Housing

Color	PN
Black	10501896

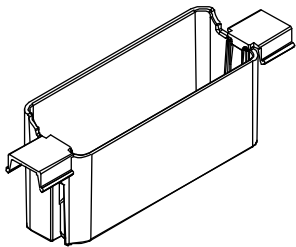

## Transmitter Cover

Color	PN
Black	10501898

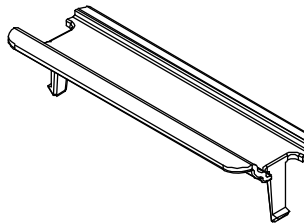

## Bracket, Sensor

Color	PN
Black	10501899

Suggested Fasteners	PN
1 - #8-18 x 1/2" TEK-2 Phillips, full thread, pan head screw	11800277

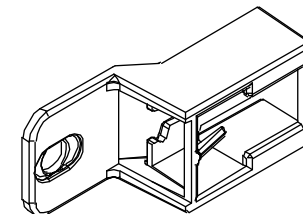

## Reed Capsule

Color	PN
Black	10501846

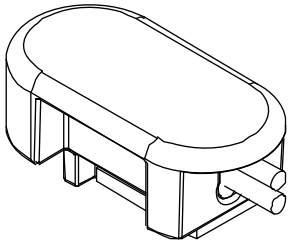

## Pulley Corner Key

### Includes:

- 1 - Bracket
- 4 - #8-15 x 3" type A/TF, 2/3 thread screw

PN
10507609

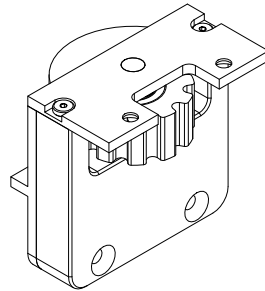

## Bi-Parting Belt Clamp

### Includes:

- 1 - Bracket
- 2 - 1/4-20 x 1" full thread, flat head P3 screw

Handing	PN
LH	10507607
RH	10507608

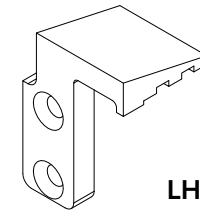

LH shown

## Motor

Model	PN
Everest	10507610
Peak	10507600



## Control Box

(Configurable to Motor)

PN
10507601



## C13 18" Power Cord

PN
10507621

No illustration available

## Closing Ramp Assembly

### Includes:

- 1 - Bracket
- 2 - #8-18 x 3" type AB, Phillips head, full thread screw

PN
10507611

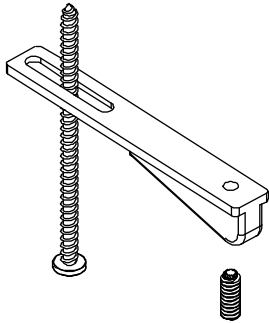

## Exterior Wall Switch

Color	PN
Black	10507612
White	10507613



## Interior Wall Switch, 12-in-1

PN
10507632



## T1 Sensor

PN
10507615



## H1 Sensor

PN
10507616



## Power Transfer Device Kit, Panel

### Includes:

- 1 - Power Transfer Device
- 1 - Magnet
- 2 - #8 x 1" TEK-3, Phillips pan head stainless steel screws

PN
11862384

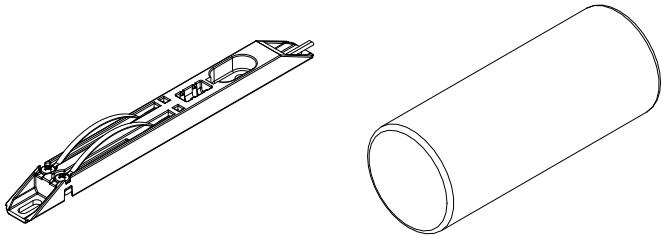

## Power Transfer Device Kit, Frame

### Includes:

- 1 - Power Transfer Device
- 1 - Reed Capsule
- 2 - #10-12 x 3" Torx, T20, pan head, 2/3 thread screws

PN
11862383

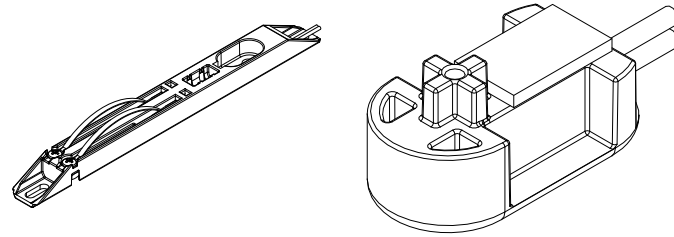

## Power Transfer Device Wire Kit, Bi-Parting

### Includes:

- 4 - Wire Connector
- 2 - Wire Lock/Close, 25'

PN
11862385

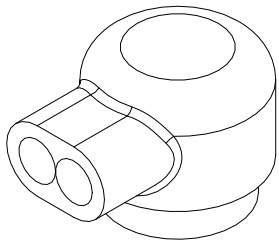

## SDAC Control Module With Ethernet Kit

### Includes:

- 1 - Control Module with ethernet
- 1 - 18" Wire, aux to brake
- 1 - 2' CAT5E wire
- 2 - #8-32 x 5/16" Phillips, pan head stainless steel screws

PN
11862389

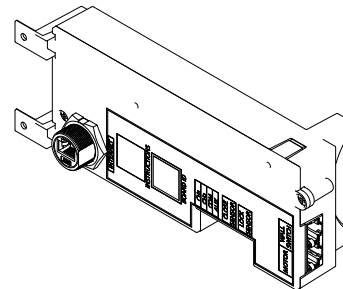

## Belt

NOTE: Order by foot - belt calculation is frame width x 2 + 4'

Color	PN
Black	10507620

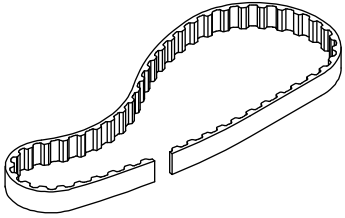

## Belt Clip

Color	PN
Black	10507619

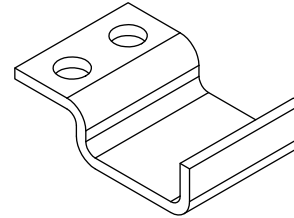

## Wire Harness, CAT5E, 2'

PN
10810035

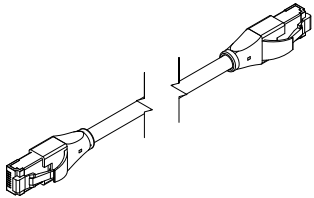

NOTE: The following cables are required, and should be locally sourced for purchase.

### **Communication Cables**

Shielded Cat5e cable with shielded RJ45 connections

### **Motor Power Cable**

Shielded Stranded 14-2 Cable

## Stationary Bracket Kit

### Includes:

- 1 - Upper stationary bracket
- 1 - #10-12 x 3", Torx T20, 2/3 thread screw
- 1 - #8 x 1", TEK 3, full thread, P2, Phillips pan head screw
- 2 - Lower stationary bracket
- 1 - #8-18 x 7/16" TEK-2 Phillips, full thread, pan head screw
- 1 - #8-18 x 1 1/2", 2/3 thread, A/TF flat head screw

Color	PN
Aluminum	11862424

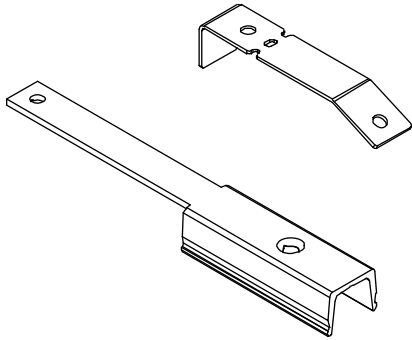

Upper Stationary Bracket (Top)  
Lower Stationary Bracket (Bottom)

## Pocket Cover Support Bracket Kit

### Includes:

- 2 - Pocket support cover brackets
- 4 - #8-18 x 1/2" TEK-2 Phillips, full thread, pan head screw

PN
11862426

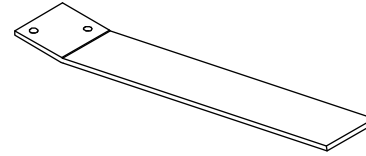

## Bumper, .532"

PN
10501592

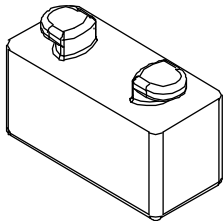

## Bumper, .125"

PN
10501591

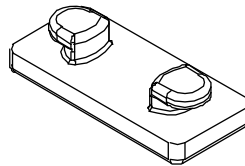

## Pocket Bumper Kit

### Includes:

- 2 - Bumper, pocket jamb
- 2 - #10-12 x 3" Torx T20, 2/3 thread screws

Color	PN
Black	11862429

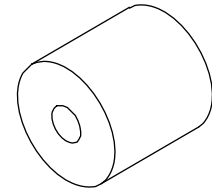

## Panel Bumper Kit (panel A to panel B)

### Includes:

- 2 - Bumper, secondary to primary
- 2 - Bumper, .375"
- 4 - #10-16 x 1 1/2" P2 flat head, full thread, TEK 2 screws

Color	PN
Black	11862427

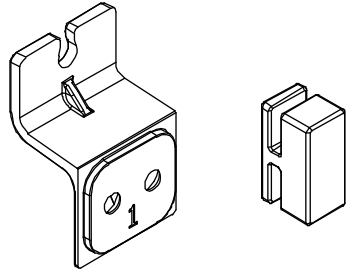

## Panel Bumper Kit (panel B to panel B)

### Includes:

- 2 - Bumper, secondary to secondary
- 2 - Bumper, .375"
- 4 - #10-16 x 1 1/2" P2 flat head, full thread, TEK 2 screws

Color	PN
Black	11862428

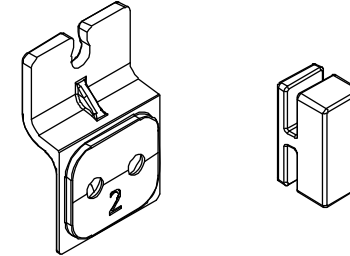

## Sill Drain Filter

Color	PN
Black	10500240

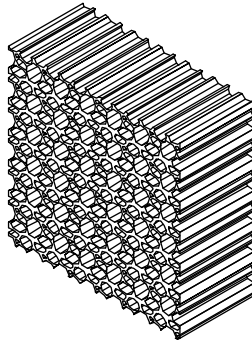

## Header Part Stop Foam Seal

Color	PN
Black	10500436

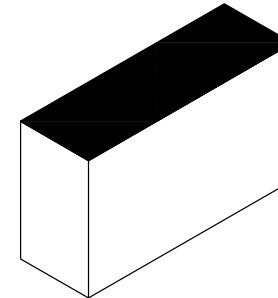

## Gasket, Pocket Interlock

Color	PN
Black	10501546

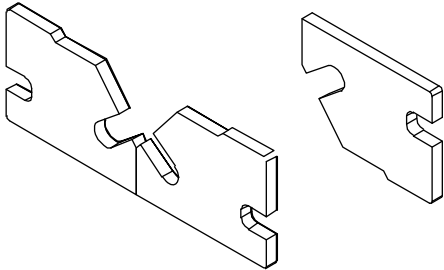

## End Cap, HP Sill Liner

Handing	Color	PN
LH	Black	10501543
RH		10501542

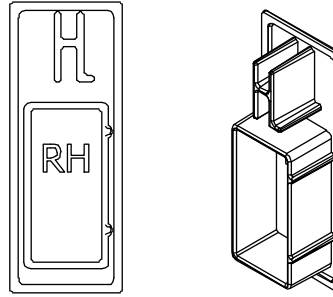

RH part shown

## Sill Liner Splice Key, Flush Performance, Kit

### Includes:

- 1 - Splice key
- 2 - #8-18 x 1/2", Type AB, full thread, Phillips head, stainless steel screws

Color	PN
Black	11862436

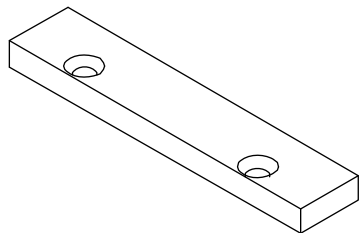

## Sill Liner Splice Key, High Performance, Kit

### Includes:

- 1 - Splice key, High Performance
- 2 - #8-18 x 1/2", Type AB, full thread, Phillips head, stainless steel screws

Color	PN
Black	11862437

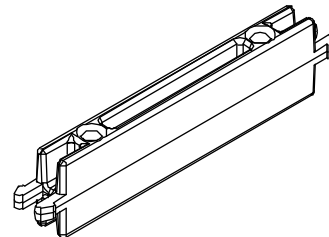

## Stile Hole Cover, Exterior, Kit

### Includes:

- 2 - Stile hole covers
- 2 - Cover retainer bracket
- 2 - #8-18 x 1 3/4" full thread pan head screws

Color	PN
Bronze	11862444
Ebony	11862445
Gunmetal	11862446
Silver	11862447
Stone White	11862448

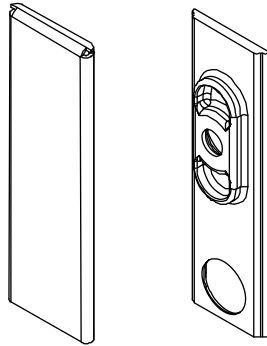

## Cover Retainer Bracket

Color	PN
Black	10501594

Suggested Fasteners	PN
1 - #8-18 x 1 3/4" full thread pan head screw	11808176

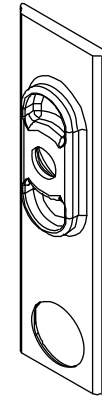

## Stile Plug, Inactive Interior Interlock

Color	PN
Black	10500412

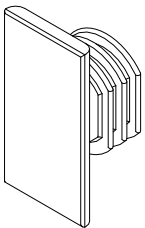

## Weep Hole Cover

Color	PN
Black	10501910

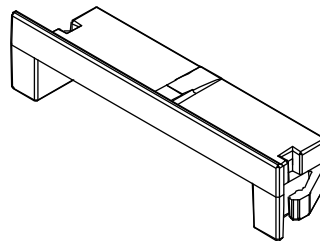

## Dust Block Holder, Interior

Color	PN
Black	10500725

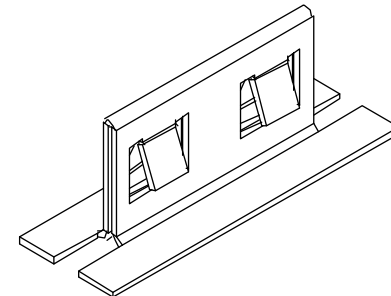

## Dust Block, 1/2" x 2 1/4" x 1/2" Pile

Bottom of Exterior Interlock

Color	PN
Black	10500483

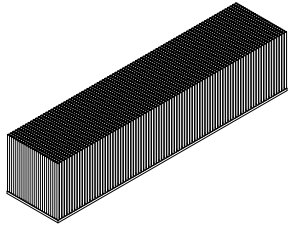

## Dust Block, 1/2" x 1 1/2" x 1/2" Pile

Top and bottom of Interior Interlock

Top of Exterior Interlock

Inactive Panel Shoe

Locking/Stationary Jamb

Head Jamb

Pocket Sill

Color	PN
Black	10500443

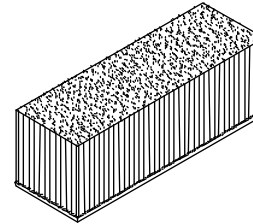

## Dust Block, 1/2" x 1 1/8" x 1/2" Pile

Primary Bi Parting Panel Shoe

Color	PN
Black	10500448

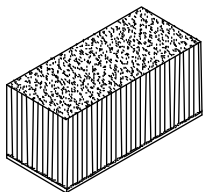

## Dust Block, 1/2" x 13/16" x 1/4" Pile

Primary Bi Parting Panel Shoe

Color	PN
Black	10500449

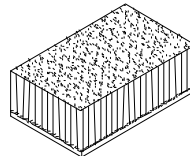

**Dust Block**  
**1/2" x 1 1/2" x 3/4" Pile**

Bi Parting Sill

Color	PN
Black	10500482

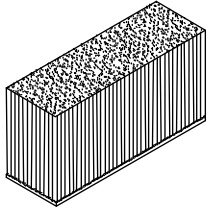

**Dust Block**  
**3/4" x 1/2" x 1/2" Pile**

Color	PN
Black	10500499

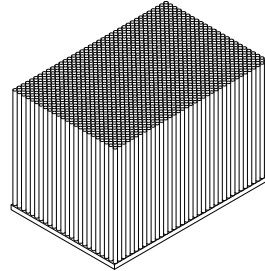

**Dust Block**  
**1/4" x 2 1/4" x 1/2" Pile**

Color	PN
Black	10500468

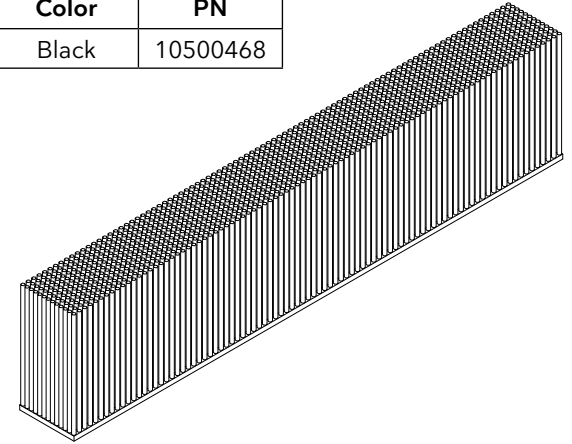

**#8-18 x 1/2" Phillips, Pan Head, Tek 2 Screw**

PN
11800277

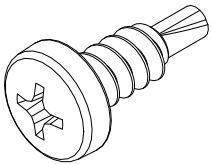

**Panel Leveling Block Kit, Stationary Panel**

A2810

*Modern MultiSlide Door Stacked*

**Includes:**

- 2 - Leveling blocks
- 2 - #8-15 x 1 1/2" 2/3 thread, A.TF, P2, flat head screws

Color	PN
Bronze	11862387

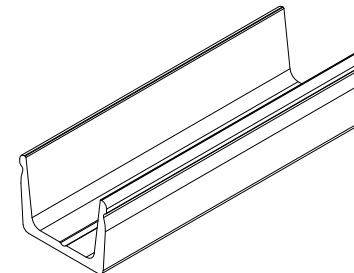

## Head Jamb Bracket Kit, Stationary Panel

*Modern MultiSlide Door Stacked*

### Includes:

- 1 - Head jamb bracket
- 4 - #10-12 x 3" 2/3 thread, Torx T20 head screws

Color	PN
Black	11852559

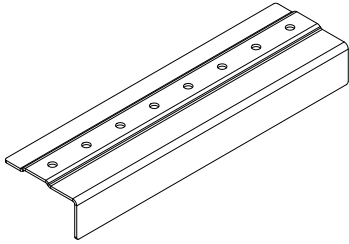

## Sill Bracket Kit, Stationary Panel

*Modern MultiSlide Door Stacked*

### Includes:

- 1 - Sill bracket
- 1 - #8-18 x 1/2" Phillips, pan head, Tek 2 screw

Color	PN
Black	11852558

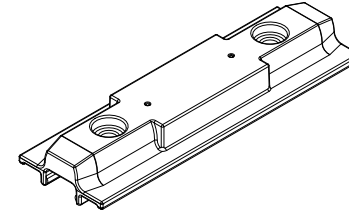

## Bumper Bracket Kit, Stationary Sill

*Modern MultiSlide Door Stacked*

### Includes:

- 2 - Bumper brackets
- 2 - Bumpers
- 4 - #10-16 x 1 1/2" P2, flat head, full thread Tek 2 screws

Color	PN
Black	11852556

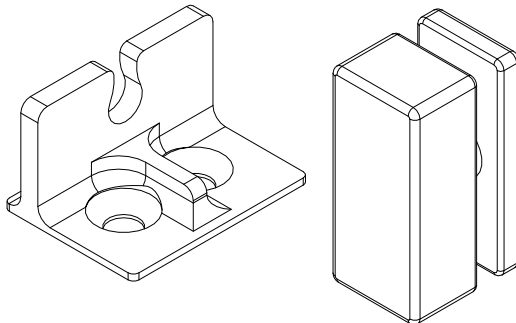

## Upper Bracket Kit, Stationary Panel

*Modern MultiSlide Door Stacked*

### Includes:

- 1 - Upper bracket
- 1 - #10-12 x 3" Torx T20, Phillips, 2/3 thread screws
- 1 - #8 x 1" Tek-3 flat head, P2, Phillips, stainless steel screw

Color	PN
Bronze	11852557

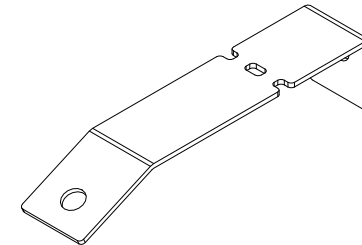

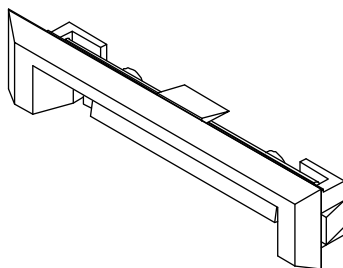

**Weep Hole Cover**

No longer available, use current.

## Jamb Cover, Interior

A3244

Length	Color	PN
200" (5080)	Gunmetal	18818170
	Stone White	18818165
	Bronze	18818160
	Clear Anodized	18818155
	Ebony	18818150



## Frame Liner (Head Jamb and Jamb)

A3248

Length	Color	PN
200" (5080)	Gunmetal	18818120
	Stone White	18818115
	Bronze	18818110
	Clear Anodized	18818105
	Ebony	18818100

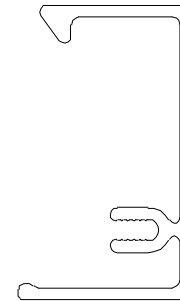

## Clad, Locking/Stationary Stile 15/16" Glass

A3362

Length	Color	PN
200" (5080)	Gunmetal	18818220
	Stone White	18818215
	Bronze	18818210
	Clear Anodized	18818205
	Ebony	18818200



## Clad, Locking/Stationary Stile 1 1/4" Glass

A3349

Length	Color	PN
200" (5080)	Gunmetal	18819420
	Stone White	18819415
	Bronze	18819410
	Clear Anodized	18819405
	Ebony	18819400



## Trim, Pocket, 1 Deep

A3312

Length	Color	PN
200" (5080)	Gunmetal	18818870
	Stone White	18818865
	Bronze	18818860
	Clear Anodized	18818855
	Ebony	18818850



## Pocket Interlock Support Block

A3313

Length	Color	PN
200" (5080)	Black	18818900

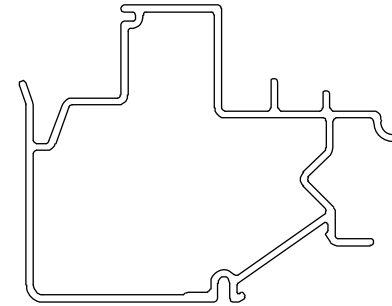

## Sill Slot Cover

A3420

Length	Color	PN
98" (2489)	Black	18819900

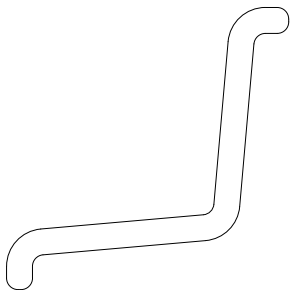

## Sill Track Cover

A2736

Length	Color	PN
200" (5080)	Ebony	18818050
	Bronze	18818060



## Sill Liner

A3245

Length	Color	PN
200" (5080)	Bronze	18818010
	Ebony	18818000

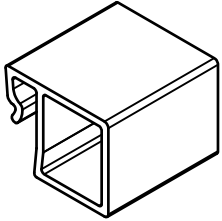

## Performance Sill Liner

A3247

Length	Color	PN
200" (5080)	Bronze	18818460
	Ebony	18818450

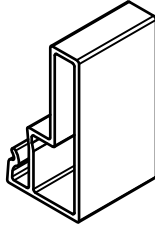

## High Performance Sill Liner

A3246

Length	Color	PN
200" (5080)	Bronze	18818805
	Ebony	18818800

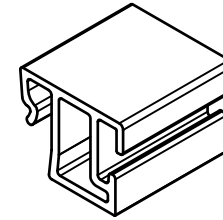

## Jamb/Head Jamb Cover, Exterior

A3476

Length	Color	PN
200" (5080)	Gunmetal	18819965
	Stone White	18819960
	Bronze	18819955
	Silver	18819970
	Ebony	18819950

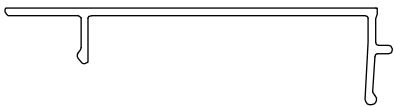

## Mull Cap, Exterior, 2"

A04307

Length	Color	PN
200" (5080)	Gunmetal	18364904
	Stone White	18364900
	Bronze	18364906
	Silver	18364902
	Ebony	18364908

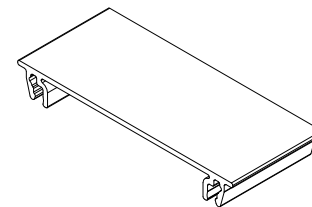

## When ordering replacement aluminum parts, specify:

1. Order number/line number (if available);
2. Type of unit;
3. Description;
4. Color;
5. Length.



**A3476**  
Jamb/Head Jamb Cover, Exterior



**A2736**  
Sill Track Cover

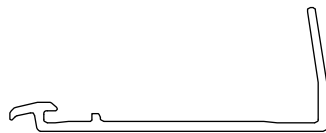

**A2863**  
Sill Liner Nosing, HP

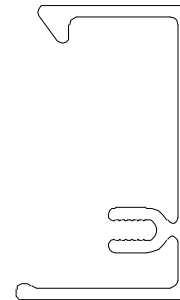

**A3248**  
Frame Liner (Head Jamb and Jamb)

## When ordering replacement aluminum parts, specify:

1. Order number/line number (if available)
2. Type of unit
3. Description
4. Color
5. Length



**Jamb Cover, Interior , A3244**

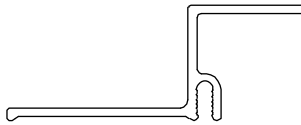

**Trim, Pocket Cover A3291**

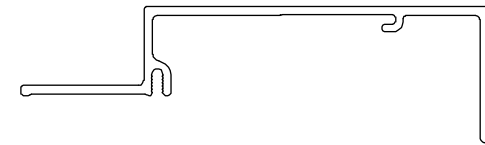

**Trim, Pocket, 1 Deep , A3312**

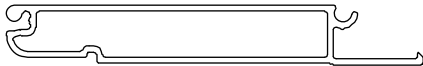

**Pocket Cover, Modular, A3292**

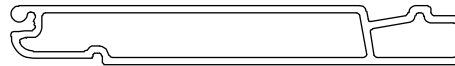

**Pocket Cover, A3293**

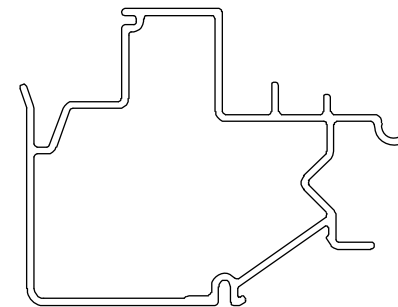

**Pocket, Interlock Support Block, A3313**

## When ordering replacement aluminum parts for, specify:

1. Order number/line number (if available)
2. Type of unit
3. Description
4. Color
5. Length



**Clad, Locking/Stationary Stile, A3362**  
15/16" Glass



**Clad, Locking Stile Bi-Parting, A3366**  
15/16" Glass



**Clad, Inactive Stile, A3367**  
15/16" Glass

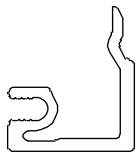

**Clad, Exterior Interlock Stile, A3410**  
15/16" Glass



**Clad, Pocket Stile, A3368**  
15/16" Glass

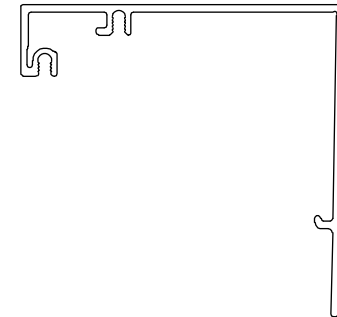

**Clad, Interior Interlock Stile, A3363**  
15/16" Glass

## When ordering replacement aluminum parts, specify:

1. Order number/line number (if available)
2. Type of unit
3. Description
4. Color
5. Length



**Clad, Exterior Interlock Stile, A3409**  
1 1/4" Glass



**Clad, Locking Stile Bi-Parting, A3352**  
1 1/4" Glass



**Clad, Locking/Stationary Stile, A3349**  
1 1/4" Glass



**Clad, Inactive Stile, A3354**  
1 1/4" Glass



**Clad, Pocket Stile, A3355**  
1 1/4" Glass

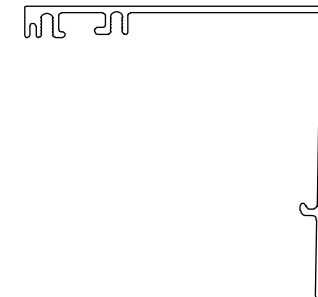

**Clad, Interior Interlock Stile, A3350**  
1 1/4" Glass

## Jamb Filler

V2915

Length	PN
150" (3810)	16219225

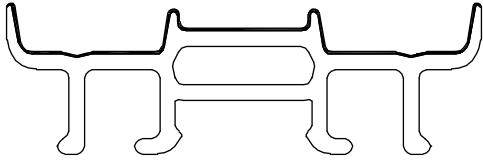

## Interlock

V2875

Length	Color	PN
150" (3810)	Black	16219215

Suggested Fasteners	PN
#8-1" full thread, Phillips pan head screw, black	11800180

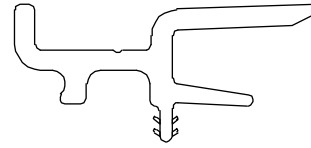

## Frame Clip

V03263

Length	Color	PN
203" (5156)	Black	16219212

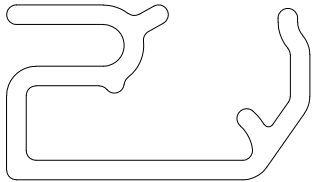

## Clad Connector, Exterior Interlock Stile

V2966

Length	Color	PN
200" (5080)	Black	16219260

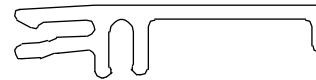

## Glazing Clip, 15/16" Glass

V2874

Length	Color	PN
200" (5080)	Black	16219205

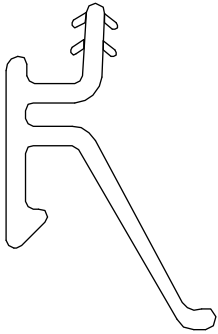

## Glazing Clip, 1 1/4" Glass

V2886

Length	Color	PN
200" (5080)	Black	16219230

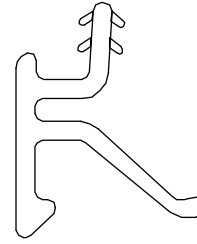

## Interior Glazing Seal

V2949

Length	Color	PN
200" (5080)	Black	16219235

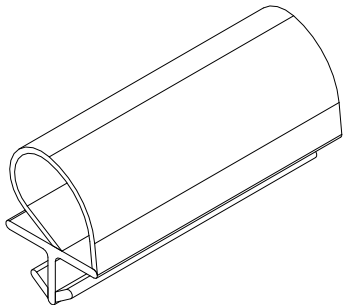

## Roller Track

V2426

Length	Color	PN
150" (3810)	Black	15984899

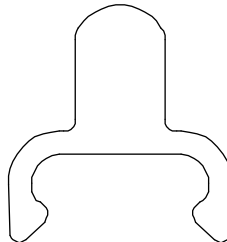

## Locking Stile Cover

V2885

Length	PN
200" (5080)	16219200

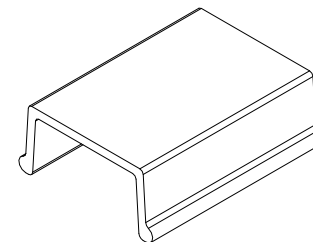

## When ordering replacement vinyl parts, specify:

1. Order number/line number (if available)
2. Type of unit
3. Description
4. Length

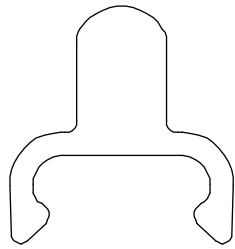

**Roller Track, V2426**

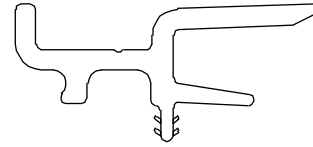

**Interlock, V2875**

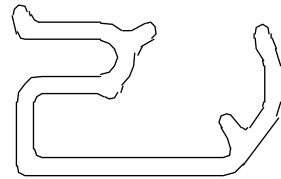

**Frame Clip, V2884**

No longer available, replaced with V03263

## Weather Strip, 1/2" Pile

V2493

Length	Color	PN
500' (152,400) roll	Black	11209999

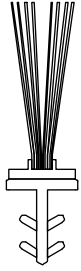

## Bi-Parting Meeting Stile Weather Strip

V2968

Length	Color	PN
144" (3658)	Black	16219265

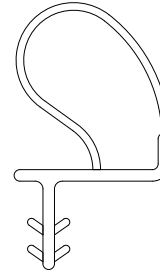

## Jamb Bulb Weather Strip

V2475

Length	Color	PN
144" (3658)	Black	11209699

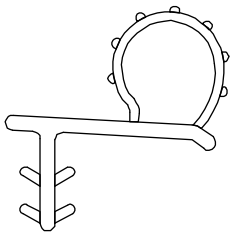

## Weather Strip, Head Jamb

V2977

Length	Color	PN
200" (5080)	Black	16219275

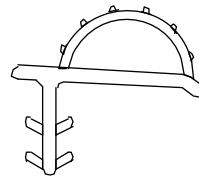

## Sill Bulb Weather Strip

V2564

Length	Color	PN
150" (3810)	Black	11211299

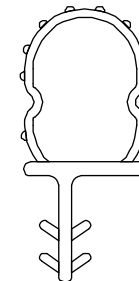

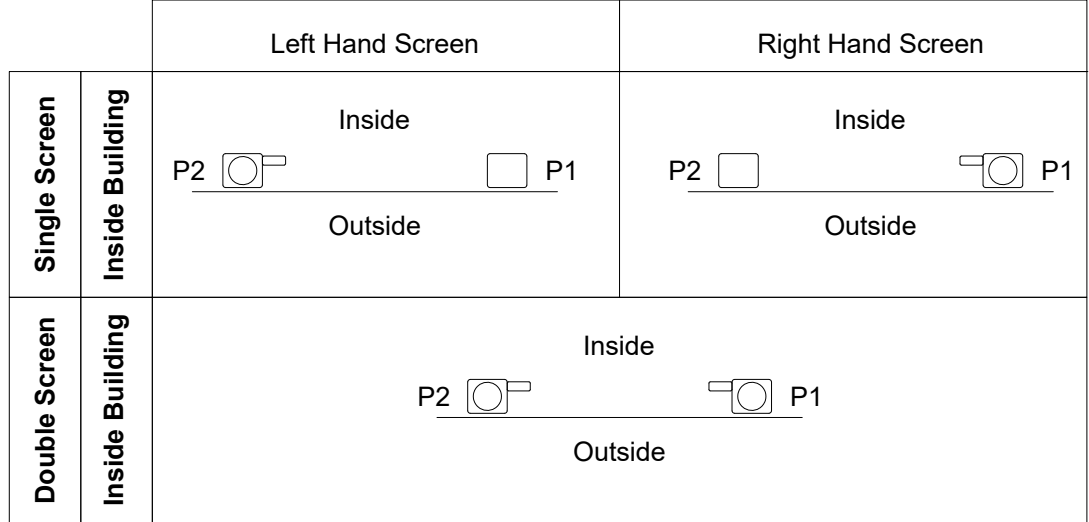

**To order full unit sill covers and screen cartridges, refer to configured parts in OMS.**

## When ordering replacement screen parts, specify:

1. Original order number/line number.

NOTE: Single screens: Marvin order number is found under the bottom stile cover on the opposite side of the tensioning springs. Double screens: Marvin order number is found under the bottom left hand stile cover on the opposite side of the tensioning springs (left hand when viewing from exterior).

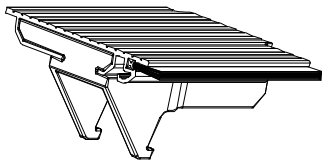

**Sill Cover, Short End**

Operation	Color	PN
LH	Clear Anodized	10504034
	Gunmetal	10504036
	Stone White	10504038
	Bronze	10504040
	Ebony	10504042
RH	Clear Anodized	10504035
	Gunmetal	10504037
	Stone White	10504039
	Bronze	10504041
	Ebony	10504043

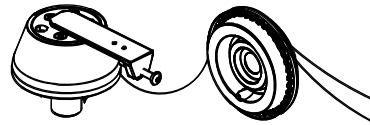

**Cone Assembly**

Operation	PN
LH	10504102
RH	10504103

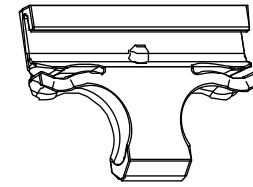

**Screen Stop, Header, Bi-Parting**

PN
10504106

## When ordering replacement screen parts, specify:

1. Original order number/line number.

NOTE: Single screens: Marvin order number is found under the bottom stile cover on the opposite side of the tensioning springs. Double screens: Marvin order number is found under the bottom left hand stile cover on the opposite side of the tensioning springs (left hand when viewing from exterior).

Illustration not available

### Cable

Color	PN
Black	10504098
Red	10504099
Yellow	10504100
Green	10504101



### Splice Joiner

PN
10504139

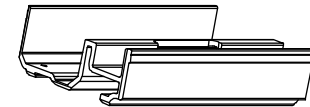

### Splice Joiner, Sill

PN
10504175

## When ordering replacement aluminum parts, specify:

1. Original order number/line number;
2. Total rough opening;
3. Part length;
4. Handing;
5. Finish/Color (where applicable),

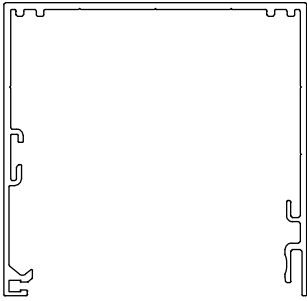

**Head Jamb Frame**  
**Head Jamb Frame, Spliced**

Note: Spliced is available in LH or RH configurations

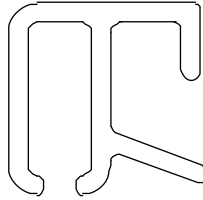

**Tab Retainer, Head Jamb**

Includes: Retainer clips



**Head Cover**  
**Head Cover, Spliced**

Includes: Pile weather strip and retainer clips

Note: Spliced is available in LH or RH configurations.



**Sill Cover, Spliced**

Includes: Pile weather strip and end caps

Note: Available in LH or RH configurations

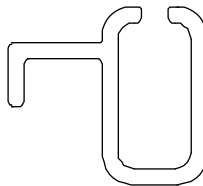

**Tab Retainer, Sill**  
**Tab Retainer, Sill, Spliced**

Note: Spliced is available in LH or RH configurations.

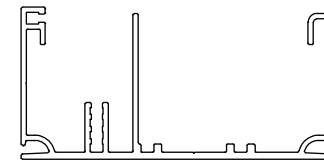

**Sill, Frame**  
**Sill, Spliced**

Note: Spliced is available in LH or RH configurations

## When ordering replacement aluminum parts, specify:

1. Original order number/line number;
2. Total rough opening;
3. Part length;
4. Handing;
5. Finish (where applicable),

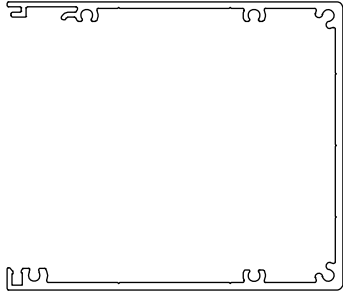

**Frame, Jamb, No Cartridge**  
**Jamb, Cartridge Side**  
**Jamb, Bi-Parting**

Note: Available in LH or RH configurations

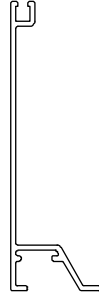

**Jamb Cover, Cartridge**

Includes: Pile weather strip and retainer clips



**Jamb Cover, Stationary**

Includes: Magnets and retainer clips

## When ordering replacement aluminum parts, specify:

1. Original order number/line number;

NOTE: Single screens: Marvin order number is found under the bottom stile cover on the opposite side of the tensioning springs. Double screens: Marvin order number is found under the bottom left hand stile cover on the opposite side of the tensioning springs (left hand when viewing screen from exterior).

### Top Cartridge Bearing

#### Includes:

- 1 - Cable tensioner
- 1 - Top block slide pulley/bearing
- 4 - Screws

#### Product usage:

Used prior to 04/27/2020

Operation	Color	PN
LH	Black	10501287
RH	Black	10501288



### Bottom Handle Pull Assembly

#### Includes:

- 1 - Bottom stile cap
- 2 - Screws/cable crimp

#### Product usage:

Used prior to 04/27/2020

Operation	Color	PN
LH	Black	10501289
RH	Black	10501290



## When ordering replacement aluminum parts, specify:

1. Original order number/line number;

NOTE: Single screens: Marvin order number is found under the bottom stile cover on the opposite side of the tensioning springs. Double screens: Marvin order number is found under the bottom left hand stile cover on the opposite side of the tensioning springs (left hand when viewing screen from exterior).

### Top Handle Pull Assembly

#### Includes:

- 1 - Top stile cap
- 2 - Screws/cable crimp

#### Product usage:

Used prior to 04/27/2020

Operation	Color	PN
LH	Black	10501291
RH	Black	10501292



### Bi-Parting Screen Stop

#### Includes:

- 1 - Double screen stop

#### Product usage:

Used prior to 04/27/2020

Color	PN
Black	10501296



## When ordering replacement aluminum parts, specify:

1. Original order number/line number;

NOTE: Single screens: Marvin order number is found under the bottom stile cover on the opposite side of the tensioning springs. Double screens: Marvin order number is found under the bottom left hand stile cover on the opposite side of the tensioning springs (left hand when viewing screen from exterior).

## Bottom Cartridge Bearing

### Includes:

- 1 - Bottom bearing/pulley assembly
- 2 - Screws

### Product usage:

Used prior to 04/27/2020

Operation	PN
LH	10501299
RH	10501298



## Spool Kit

### Includes:

- 1 - LH/RH Cone
- 1 - Cable/crimp
- 1 - Cable connector
- 4 - Screws

NOTE: Modern MultiSlide Door will use 13ft (cable) for each cone to connector. Top Cables: width of screen + 1/2 the height. Bottom Cables: 2 times the width of the screen + 1 1/2 times the height

### Product usage:

Used prior to 04/27/2020

Length	Operation	Color	PN
Specify LF length	LH	Black	10501294
	RH	Gray	10501293



## When ordering replacement aluminum parts, specify:

1. Original order number/line number;

NOTE: Single screens: Marvin order number is found under the bottom stile cover on the opposite side of the tensioning springs. Double screens: Marvin order number is found under the bottom left hand stile cover on the opposite side of the tensioning springs (left hand when viewing screen from exterior).

### Cable

NOTE: Modern MultiSlide Door will use 13ft (cable) for each cone to connector. Top Cables: width of screen + 1/2 the height. Bottom Cables: 2 times the width of the screen + 1 1/2 times the height

#### Product usage:

Used prior to 04/27/2020

Length	PN
Specify LF length	10501259



### Handle Pull Covers/Spring Kit

#### Includes:

- 4 - Stile covers
- 2 - Springs
- 4 - Spring keepers

#### Product usage:

Used prior to 04/27/2020

PN
10501297



## When ordering replacement aluminum parts, specify:

1. Original order number/line number;
2. Total rough opening;
3. Part length;
4. Handing;
5. Finish/color (where applicable),

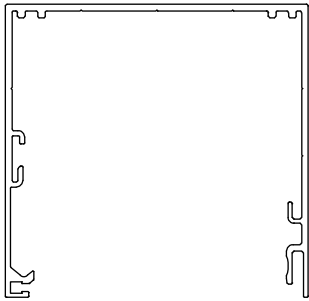

### Head Jamb Frame

Includes: Weather strip  
Used prior to 04/27/2020

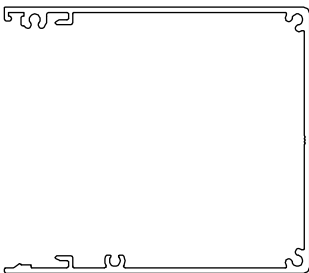

### Jamb Frame

Includes: Weather strip  
Used prior to 04/27/2020

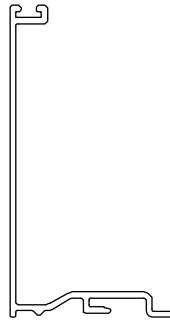

### Head Jamb/Jamb Cover

Includes: Weather strip  
Used prior to 04/27/2020

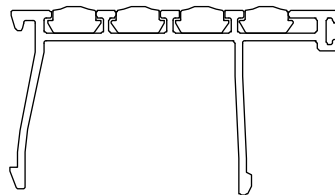

### Sill

Includes: Weather strip  
Used prior to 04/27/2020



### Cartridge

Includes: 1 Complete cartridge assembly  
Used prior to 04/27/2020

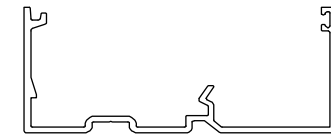

### Sill

Includes: Weather strip  
Used prior to 04/27/2020



### Jamb Stop

Includes: Magnet strip  
Used prior to 04/27/2020