



Elevate Sliding Patio Door

Replacement Parts

Specifications and technical data are subject to change without notice.

Numbers listed in () parentheses are metric equivalents in millimeters rounded to the nearest whole number.

Suggested fasteners are not included and must be ordered separately.

Illustrations are not to scale.

Contents

| | |
|--|----|
| Product History..... | 2 |
| Part Identification - Two Panel Operator..... | 3 |
| Part Identification - Three Panel Operator..... | 4 |
| Part Identification - Four Panel Operator..... | 5 |
| Installation Kits..... | 6 |
| Installation Parts..... | 7 |
| Cambridge Handles..... | 8 |
| Northfield Handles..... | 10 |
| Handle Parts..... | 12 |
| Locking Hardware..... | 13 |
| Locking Hardware - Discontinued Limited Availability (LA)..... | 17 |
| Operators..... | 18 |
| Operators - Discontinued No Availability (NA)..... | 19 |
| Miscellaneous Parts..... | 20 |
| Miscellaneous Parts - Discontinued No Availability (NA)..... | 24 |
| Tools..... | 25 |
| Aluminum Parts..... | 26 |
| Vinyl Parts - Configured Part in OMS..... | 30 |
| Vinyl Parts..... | 31 |
| Vinyl Parts - Discontinued No Availability (NA)..... | 34 |
| Wood Parts..... | 35 |
| Weather Strip - Configured Part in OMS..... | 40 |
| Weather Strip..... | 41 |
| Weather Strip: Blocks/Seals/Plugs..... | 42 |
| Panel Replacement - Configured Part in OMS..... | 43 |
| Screen Replacement - Configured Part in OMS..... | 44 |
| Screen Parts..... | 45 |

| Produced | Unit Type | Features and Changes |
|----------|--------------------|--|
| 2019 | Sliding Patio Door | 02/25/2019: Introduced the Generation 3 Elevate Sliding Patio Door. The handles were standardized across the Elevate Sliding Door products. The handle now has a thinner escutcheon plate. 12/16/2019: Discontinued the sale of Wood Removable Grilles. |
| 2020 | Sliding Patio Door | 02/14/2020: The screen handle position was changed to a height dimension of 38" from the bottom of the screen to the center of the handle. 04/27/2020: Added exterior Ultrex capping to the interior and added a wood interior cover to the stationary jamb for Bare and Clear finish options. 12/29/2020: Manufacturing began using Operator Interlock V3189 and Stationary Interlock V3130. NOTE: When replacing interlock system parts on product manufactured between 2/25/2019 to 12/29/2020, all Interlock parts must be replaced with current parts and must be ordered separately. The replacement parts needed are the Interlock Seal Sub Assembly, Interlock Hook, V3189 Operator Interlock and V3130 Stationary Interlock. Please reference Customer Service Bulletin #178 for more details on available replacement parts and service dates. |
| 2021 | Sliding Patio Door | 02/22/2021: W13261 Astragal Cover available to order separate from the Astragal Assembly. Service instructions are available. 10/25/2021: Standard screen mesh changed to Marvin Bright View™. See Product Bulletin 793 for more information. Sliding Door Interlocks became available as Configured Parts in OMS. See Product Bulletin 797 for more information. |
| 2022 | Sliding Patio Door | 02/28/2022: Frame and Sill Weather Strips became available as Configured Parts in OMS. See Product Bulletin 821 for more information. 04/21/2022: Part numbers were removed for the vinyl and weather strip profiles now available in Configured Parts in OMS (V3130, V3189, V2396/V2629, V2529/V2620. Any Discontinued - Limited Availability (LA) will continue to be available by part number. See Product Bulletin 829 for more details. 10/10/2022: Adjustable Panel Rollers were updated. See Product Bulletin 849 for additional information. 10/31/2022: Evergreen exterior discontinued. See Product Bulletin 851 for additional information. 12/05/2022: New header L bracket, adjustable plates and sill strikes on all OXXO sliding doors implemented to reduce panel play. See Product Bulletin 859 for additional information. |
| 2023 | Sliding Patio Door | 02/27/2023: Gunmetal introduced. See Product Bulletin 863 for additional information 08/28/2023: V2676 Roller Track made available as configured parts in OMS. See Product Bulletin 898 for more information. |

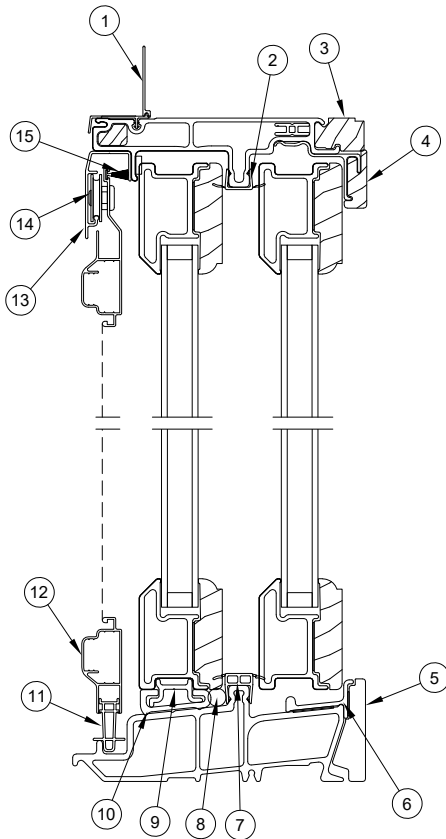

Head Jamb and Sill

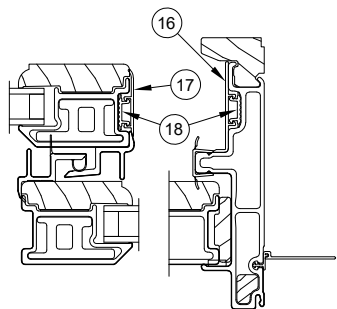

Stile and Jamb Covers
Interior Painted
Units Only

1. Head Jamb Nailing Fin, V119
2. Jamb/Head Jamb Weather Strip, V2629/V2396
3. Head Jamb Liner, W8565
4. Panel Guide, W8566
5. Sill Liner, V2693
6. Roller Track with Tape, V2676
7. Sill Weather Strip, V2620/V2529
8. Backer Rod
9. Leveling Block Insert, A2821
10. Leveling Block, V2344
11. Screen Roller Guide, V2932
12. Screen Panel
13. Head Jamb Screen Track, A1237
14. Adjustable Screen Roller
15. Pile Weather Strip, (Sliding)
16. Interior Jamb Cover, V2939
17. Stile Cover, V2165
18. Jamb Cover Base, V2937
19. Jamb Liner, W7623
20. Interior Handle
21. Stationary Panel Interlock, V3130
22. Operator Panel Interlock, V3189
23. Interior Cover, W13506
24. Stationary Panel Spacer, W8581
25. Exterior Handle
26. Jamb Nailing Fin, V104

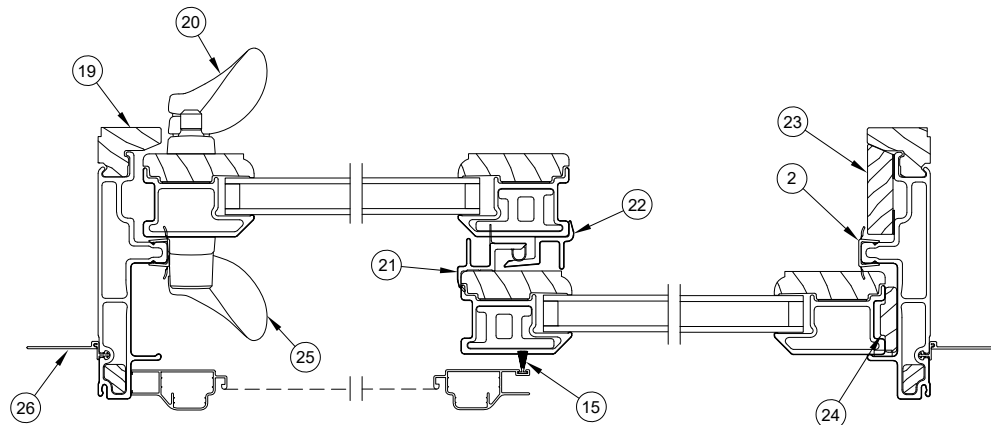

Jamb - XO

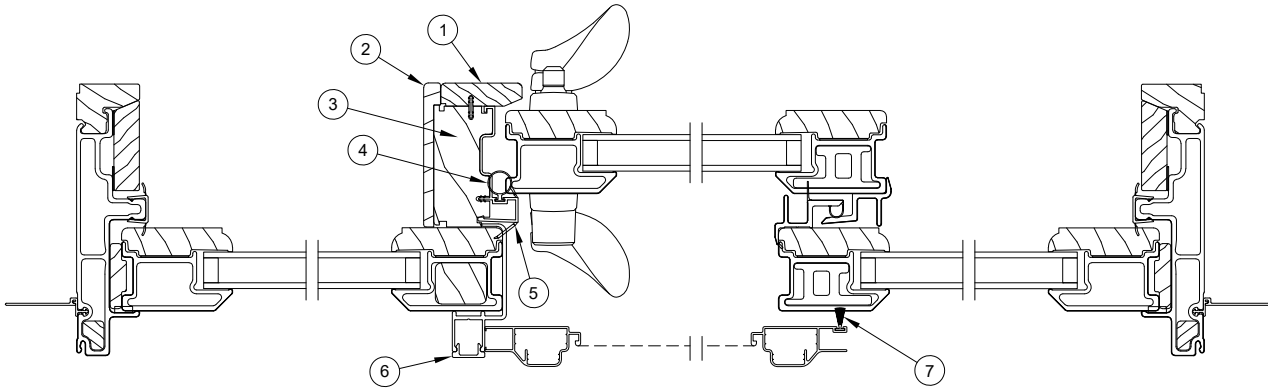

3 Panel Jamb Detail - OXO R

1. Astragal Trim, W7718
2. Astragal Cover, W13261
3. Astragal Assembly
4. Astragal Weather Strip, V2398
5. Astragal Cap, Vertical, V3003/V3005
6. Stile Cover, A1222
7. Pile Weather Strip (Sliding)
8. Interior Mull Trim, W7719
9. Spline, A3337

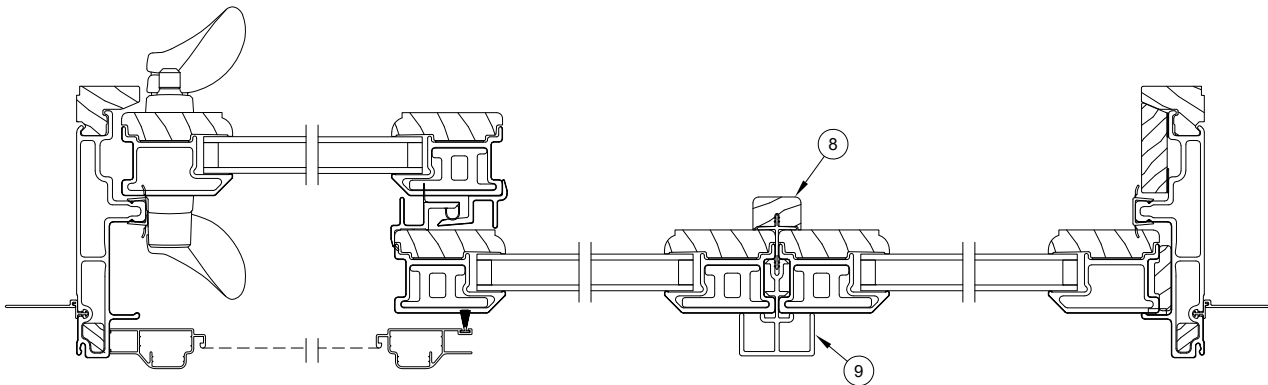

3 Panel Jamb Detail - XOO R

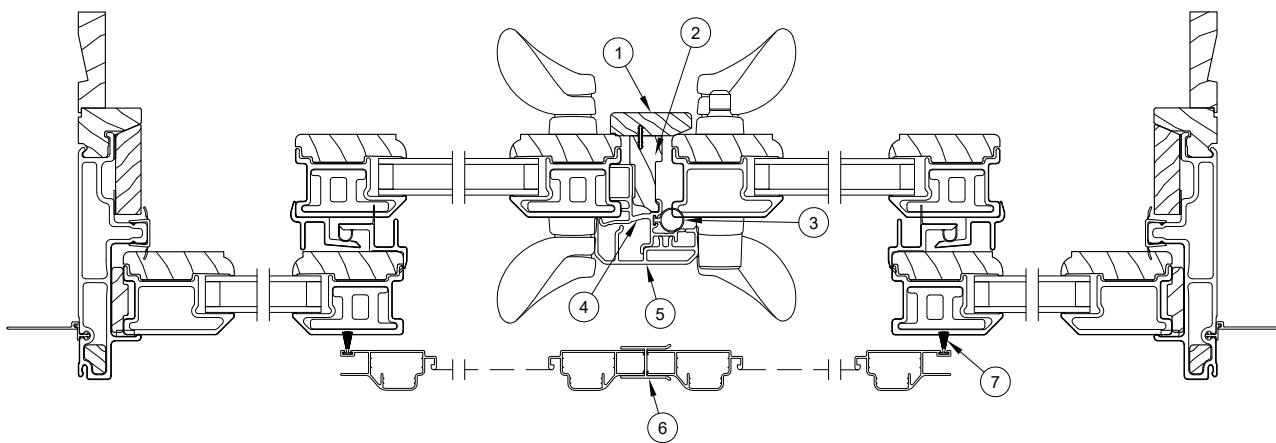

4 Panel Jamb Detail - OXXO R

1. Astragal Trim, W7718
2. Interior Astragal, W12167
3. Astragal Weather Strip, V2398
4. Astragal Base, Secondary Operator, A3347
5. Astragal Cap, A3348
6. Screen Astragal (OXXO), A2740
7. Pile Weather Strip (Sliding)

General Installation Kit - OX/OOX/OXO

Includes:

- 2 - Dust block, screen
- 3 - #8 x 3" Phillips pan head screws - White or Black
- 2 - #8 x 3" Phillips pan head screws - Stainless Steel

| Color | PN |
|-------|--------|
| White | 118811 |
| Black | 118813 |

General Installation Kit - OXXO

Includes:

- 5 - Dust block, screen
- 4 - #8 x 3" Phillips pan head screws - White or Black
- 2 - #8 x 3" Phillips pan head screws - Stainless Steel
- 3 - #10 x 2 3/4" flat head masonry screws
- 5 - #8 x 2 1/2" Phillips flat head screws - White or Black
- 16 - #8 x 5/8" Phillips truss head screws - Beige or Black

| Color | PN |
|-------|--------|
| White | 118812 |
| Black | 118814 |



Screen Dust Block



#8 x 5/8
Phillips trusshead

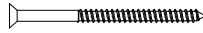

#8 x 2 1/2" Phillips flat head

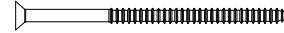

#10 x 2 3/4" flat head masonry



#8 x 3" Phillips pan head

Installation Screws

Includes:

12 - #8 x 3" Phillips pan head screws

| Color | Pkg Qty. | PN |
|-------------|----------|----------|
| Stone White | 25 | 11880829 |
| Beige | | 11886182 |
| Black | | 11886167 |

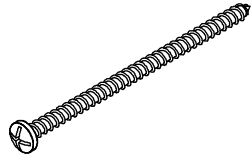

Through Jamb Plug

| Color | PN |
|-------------|----------|
| Beige | 11882969 |
| Black | 11882971 |
| Stone White | 11882970 |

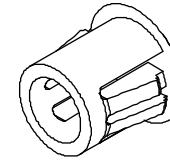

Cambridge Active Handle Set, Exterior

Includes:

- 1 - Handle
- 1 - Exterior escutcheon
- 2 - Handle screws
- 1 - Post nut
- 1 - Keyed cylinder
- 1 - Keyed cylinder cover
- 2 - Cylinder cover screws
- 1 - Handle gasket
- 1 - Handle gasket
- 2 - Keys
- 1 - Instruction card
- 1 - Allen wrench

| Color | XO/XOO/OXO-R OXXO-R | OX/OOX/OXO-L OXXO-L |
|-----------------------|------------------------|------------------------|
| White | 108852 | 108853 |
| Brass PVD | 108858 | 108859 |
| Satin Nickel PVD | 108860 | 108861 |
| Oil Rubbed Bronze PVD | 108862 | 108863 |
| Almond Frost | 108874 | 108875 |
| Matte Black | 108872 | 108873 |

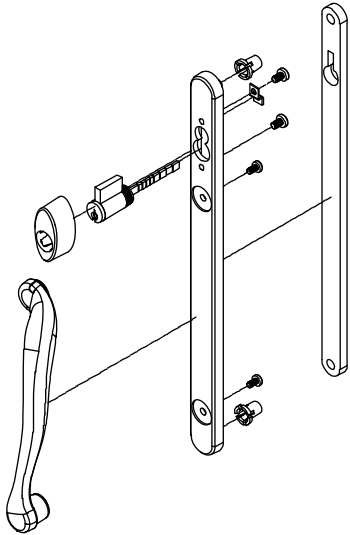

XO/XOO/OXO-R/OXXO-R shown

Cambridge Active Handle Set, Interior

Includes:

- 1 - Handle
- 1 - Interior escutcheon
- 2 - Handle screws
- 2 - Escutcheon machine screws
- 1 - Thumb turn
- 1 - Thumb turn extension
- 1 - Instruction card
- 1 - Allen wrench

| Color | XO/XOO/OXO-R OXXO-R | OX/OOX/OXO-L OXXO-L |
|-----------------------|------------------------|------------------------|
| White | 208840 | 208841 |
| Brass PVD | 208846 | 208847 |
| Satin Nickel PVD | 208848 | 208849 |
| Oil Rubbed Bronze PVD | 208850 | 208851 |
| Almond Frost | 208870 | 208871 |
| Matte Black | 208868 | 208869 |

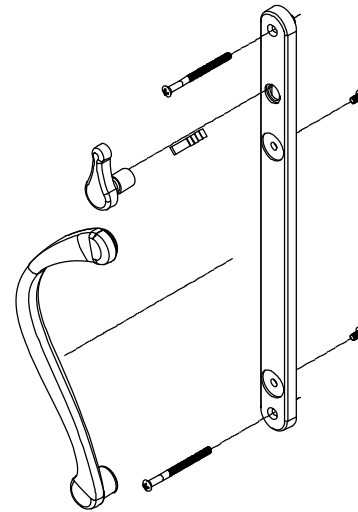

XO/XOO/OXO-R/OXXO-R shown

Cambridge Passive Handle Set, Exterior

Includes:

- 1 - Handle
- 1 - Exterior escutcheon
- 1 - Handle gasket
- 2 - Handle screws
- 2 - Post nuts
- 1 - Instruction card
- 1 - Allen wrench

| Color | OXXO-R | OXXO-L |
|-----------------------|---|---|
| | OX, OOX, OXO-L (Elevate Sliding Patio Door Non-Keyed only) | XO, XOO, OXO-R (Elevate Sliding Patio Door Non-Keyed only) |
| White | 228878 | 228879 |
| Brass PVD | 228876 | 228877 |
| Satin Nickel PVD | 228874 | 228875 |
| Oil Rubbed Bronze PVD | 228872 | 228873 |
| Almond Frost | 228870 | 228871 |
| Matte Black | 228868 | 228869 |

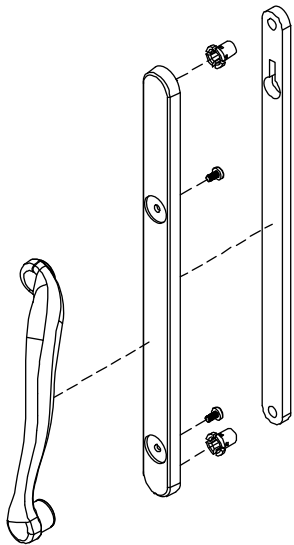

OXXO-L shown

Cambridge Passive Handle Set, Interior

Includes:

- 1 - Handle
- 1 - Interior escutcheon
- 2 - Handle screws
- 2 - Escutcheon machine screws
- 1 - Instruction card
- 1 - Allen wrench

| Color | OXXO-R | OXXO-L |
|-----------------------|--------|--------|
| White | 218878 | 218879 |
| Brass PVD | 218876 | 218877 |
| Satin Nickel PVD | 218874 | 218875 |
| Oil Rubbed Bronze PVD | 218872 | 218873 |
| Almond Frost | 218870 | 218871 |
| Matte Black | 218868 | 218869 |

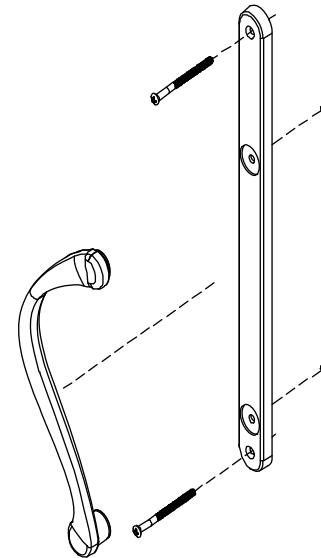

OXXO-L shown

Northfield Active Handle Set, Exterior, 1”

Includes:

- 1 - Handle
- 1 - Exterior escutcheon
- 1 - Handle screw
- 1 - Handle bracket
- 2 - Handle bracket screws
- 1 - Keyed cylinder
- 2 - Z-clip/keyed cylinder cover screws
- 1 - Z-clip
- 2 - Keys
- 1 - Instruction card
- 1 - Allen wrench

| Color | XO/XOO/OXO-R OXXO-R | OX/OOX/OXO-L OXXO-L |
|-----------------------|------------------------|------------------------|
| White | 11868101 | 11868100 |
| Brass PVD | 11868103 | 11868102 |
| Satin Nickel PVD | 11868105 | 11868104 |
| Oil Rubbed Bronze PVD | 11868107 | 11868106 |
| Almond Frost | 11868109 | 11868108 |
| Matte Black | 11868111 | 11868110 |

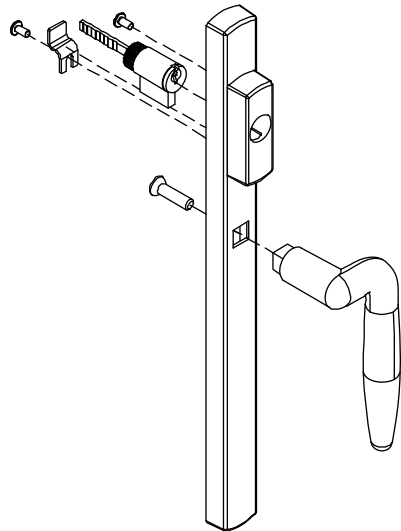

XO/OOX/OXO-R/OXXO-R shown

Northfield Active Handle Set, Interior, 1”

Includes:

- 1 - Handle
- 1 - Thumb turn
- 1 - Interior escutcheon
- 2 - machine screws
- 1 - Handle screw
- 1 - Handle bracket
- 2 - Handle escutcheon bracket screws
- 1 - Tail piece
- 1 - Instruction card
- 1 - Allen wrench

| Color | XO/XOO/OXO-R OXXO-R | OX/OOX/OXO-L OXXO-L |
|-----------------------|------------------------|------------------------|
| White | 11868120 | 11868121 |
| Brass PVD | 11868122 | 11868123 |
| Satin Nickel PVD | 11868124 | 11868125 |
| Oil Rubbed Bronze PVD | 11868126 | 11868127 |
| Almond Frost | 11868128 | 11868129 |
| Matte Black | 11868130 | 11868131 |

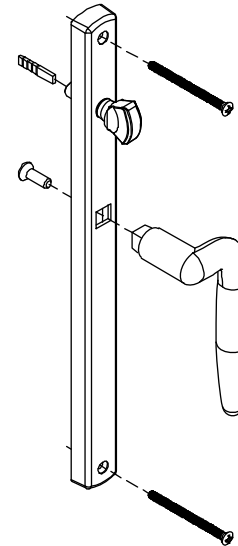

OX/OOX/OXO-L/OXXO-L shown

Northfield Passive Handle Set, Exterior, 1”

Includes:

- 1 - Handle
- 1 - Exterior escutcheon
- 1 - Handle screws
- 1 - Handle bracket
- 2 - Bracket screws
- 1 - Instruction card
- 1 - Allen wrench

| Color | OXXO-R | OXXO-L |
|-----------------------|---|---|
| | OX, OOX, OXO-L (Elevate Sliding Patio Door Non-Keyed only) | XO, XOQ, OXO-R (Elevate Sliding Patio Door Non-Keyed only) |
| White | 11868160 | 11868161 |
| Brass PVD | 11868162 | 11868163 |
| Satin Nickel PVD | 11868164 | 11868165 |
| Oil Rubbed Bronze PVD | 11868166 | 11868167 |
| Almond Frost | 11868168 | 11868169 |
| Matte Black | 11868170 | 11868171 |

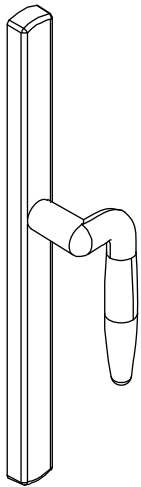

OXXO-L shown

Northfield Passive Handle Set, Interior, 1”

Includes:

- 1 - Handle
- 1 - Exterior escutcheon
- 1 - Handle screws
- 1 - Handle bracket
- 2 - Bracket screws
- 1 - Instruction card
- 1 - Allen wrench

| Color | OXXO-R | OXXO-L |
|-----------------------|----------|----------|
| White | 11868140 | 11868141 |
| Brass PVD | 11868142 | 11868143 |
| Satin Nickel PVD | 11868144 | 11868145 |
| Oil Rubbed Bronze PVD | 11868146 | 11868147 |
| Almond Frost | 11868148 | 11868149 |
| Matte Black | 11868150 | 11868151 |

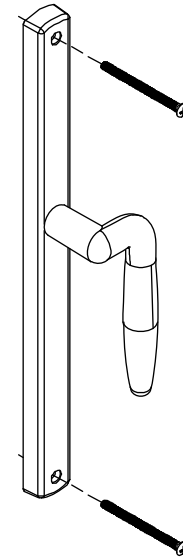

OXXO-R shown

Cambridge Handle Screws

Includes:

2 - #8 x 7/16" button head cap screw - attach handle to escutcheon.

| Color | PN |
|-------|--------|
| Zinc | 118095 |

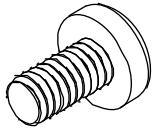

Tail Piece/Extension, Interior Active Handle

| PN |
|----------|
| 11868008 |

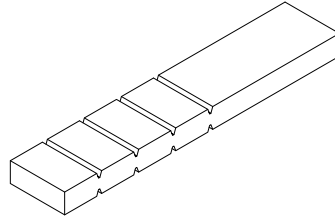

Keyed Cylinder

Includes:

1 - Lock Cylinder
2 - Keys

Note:

For keyed alike cylinders, please contact your Marvin representative. Please supply the original order number, if possible.

| PN |
|--------|
| 108810 |

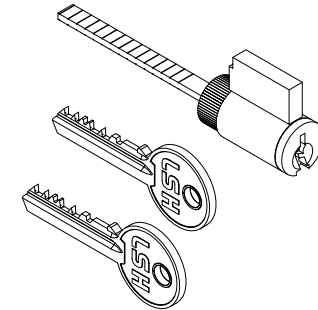

Cambridge Handle Escutcheon Screw

Includes:

1 - #8-32 x 2" Phillips oval head machine screw - attach exterior to interior plate

| Color | PN |
|-------------------|--------|
| White | 118090 |
| Brass | 118092 |
| Satin Nickel | 118093 |
| Oil Rubbed Bronze | 118094 |
| Almond Frost | 118096 |
| Matte Black | 118100 |

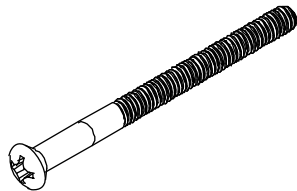

Northfield Handle Escutcheon Screw

Includes:

1 - #8-32 x 2 1/2" Machine screw - attach exterior to interior plate

| Color | PN |
|-------------------|--------|
| White | 118082 |
| Brass | 118084 |
| Satin Nickel | 118085 |
| Oil Rubbed Bronze | 118086 |
| Almond Frost | 118083 |
| Matte Black | 118102 |

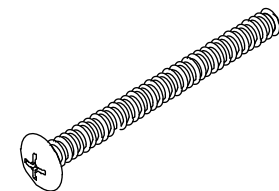

Keeper

Includes:

- 1 - Keeper
- 4 - #8 x 3" Phillips self tapping pan head screws - used on OX/XO, OOX/XOO
- 4 - #10 x 1" Phillips self tapping pan head screws - used on OXO
- 4 - #8 x 2" Phillips self tapping pan head screws - used on OXXO

| Color | PN |
|-------------|--------|
| Pearl White | 117711 |
| Black | 117712 |

Keeper, Stainless Steel

Includes:

- 1 - Keeper
- 4 - #8 x 3" Phillips self tapping pan head screws - used on OX/XO, OOX/XOO
- 4 - #10 x 1" Phillips self tapping pan head screws - used on OXO
- 4 - #8 x 2" Phillips self tapping pan head screws - used on OXXO

| Color | PN |
|---------------------|--------|
| 304 Stainless Steel | 117713 |

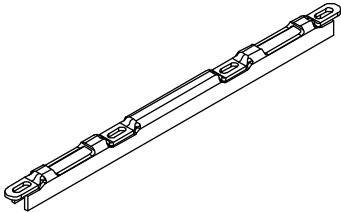

Assembly Lock, Multi-Point

Includes:

- 1 - Mortise lock and trim plate
- 2 - #8 x 1" Phillips self tapping flat head screws

| Color | PN |
|----------|----------|
| Standard | 11869890 |
| Coastal | 11869891 |

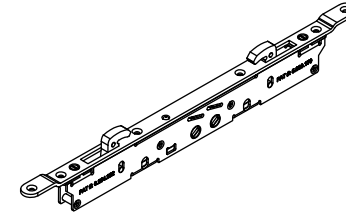

Flush Bolt Assembly Kit

Includes:

- 1 - Flush bolt assembly
- 2 - #6 x 3/4" Phillips flat head screws
- 2 - #6 x 5/8" Phillips flat head screws

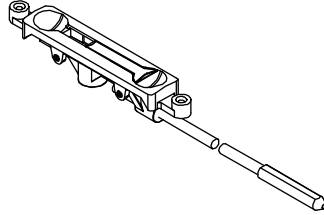

| Color | PN |
|-------------|----------|
| Pearl White | 10809688 |
| Black | 10809689 |

Flush Bolt Face Plate Kit

Includes:

- 1 - Flush bolt face plate
- 2 - #6-18 x 3/4" Type A, full thread screw
- 2 - #6-20 x 5/8" Type AB, full thread screw



| Color | PN |
|-------------|----------|
| Pearl White | 10809350 |
| Black | 10809351 |

Shoot Bolt Guide

NOTE: 2 per panel - OXXO

| Color | PN |
|-------------|----------|
| Pearl White | 10501152 |
| Black | 10501163 |

| Suggested Fasteners | Color | PN |
|-------------------------------------|-----------------|----------|
| 2 - #8-18 x 1"AB, full thread screw | Stainless Steel | 11800769 |

| Suggested Fasteners | Color Match | PN |
|---|-------------|----------|
| 2 - #6 x 1/2" Type AB, Phillips, flat head, full thread screw | Pearl White | 11860650 |
| | Black | 11860649 |

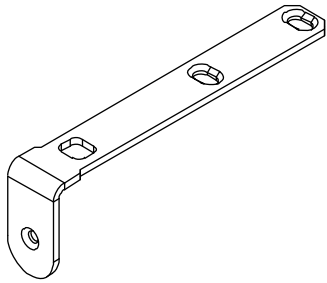

Shoot Bolt Guide Insert

NOTE: 2 per panel - OXXO

| Color | PN |
|-------|----------|
| Black | 11860345 |

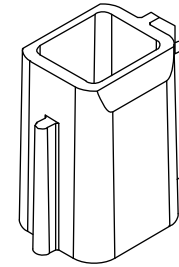

Strike Plate, Head Jamb, OXXO

Usage dates:

12/05/2022 to present

| PN | Suggested Fasteners | PN |
|----------|--|----------|
| 11862586 | #8-18 x 1 1/4" Phillips, flat head screw | 11806156 |

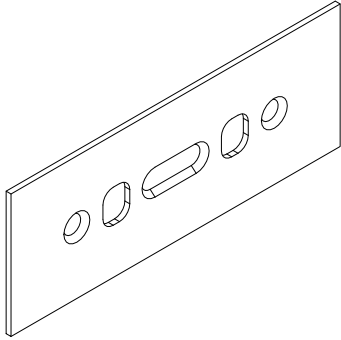

Strike Plate, Head Jamb OXXO

Usage dates:

12/05/2022 to present

| Color | PN | Suggested Fasteners | PN |
|-------|----------|--|----------|
| White | 11863580 | #8-18 x 1 1/4" Phillips, flat head screw | 11806156 |
| Black | 11863581 | | |

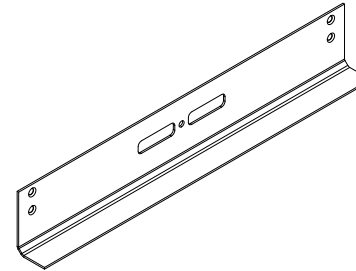

Sill Strike, OXXO

Usage dates:

12/05/2022 to present

| PN | Suggested Fasteners | PN |
|----------|---|----------|
| 11862587 | #8-18 x 1#8 x 1" Phillips, flat head, full thread screw | 11800645 |

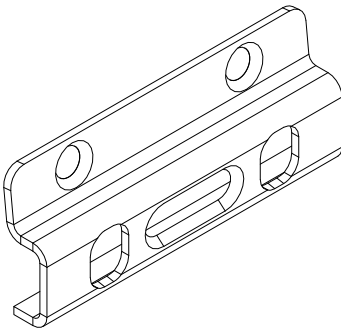

Sill Strike Plate

Includes:

2 - #8 x 1" Phillips flat head screws

Usage dates:

Prior to 12/05/2022

| Color | PN |
|-----------------|----------|
| Stainless Steel | 10188184 |

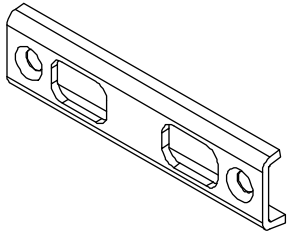

Head Jamb Strike Plate

Includes:

4 - #8 x 5/8" Phillips flat head screws

5 - #8 x 2 1/2" Phillips flat head screws

Usage dates:

Prior to 12/05/2022

| Color | PN |
|-------------|----------|
| Pearl White | 10188185 |
| Black | 10188188 |

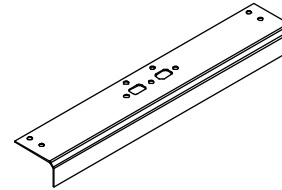

Adjustment Roller

Usage dates:

10/10/2022 to present

| Color | PN |
|---------------------------|----------|
| Zinc | 10820010 |
| Coastal (Stainless Steel) | 10820011 |

| Suggested Fasteners | |
|---------------------------|----------|
| 2 - #8 x 1", 410 screw | |
| Color | PN |
| Standard (Zinc) | 11800769 |
| Coastal (Stainless Steel) | 11800810 |

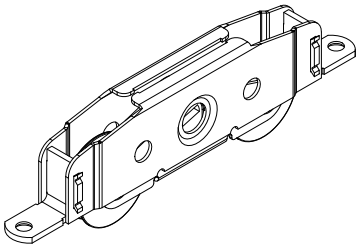

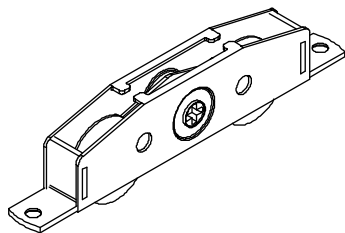

Adjustable Panel Roller

Usage dates: Prior to 10/10/2022
No longer available, use current part.

Sill Drain Weep

| Color | PN |
|-------|----------|
| Black | 15631215 |

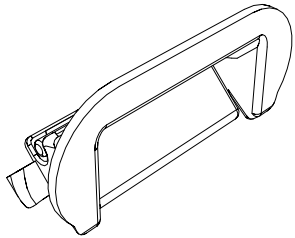

Leveling Block End Cap

| Color | Handing | PN |
|-------|---------|----------|
| Beige | LH | 10801583 |
| Black | LH | 10809583 |
| Beige | RH | 10801582 |
| Black | RH | 10809582 |

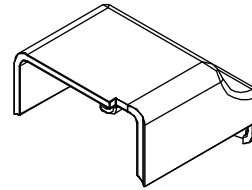

Astragal End Cap, OXXO

NOTE: Top and bottom of secondary astragal

| Color | PN |
|-------|----------|
| Black | 11860363 |

| Suggested Fastener | PN |
|---|----------|
| 1 - #8-15 x 3/4" Type A-17, full thread screw | 11805321 |

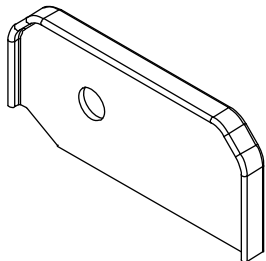

Header End Cap Cover

| Color | PN |
|-------|----------|
| Beige | 10500801 |
| Black | 10500809 |

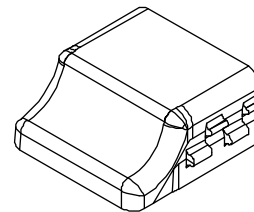

Adjustment Hole Cap/Plug Kit

Includes:

2 - Operator adjustment hole caps

| Color | PN |
|----------------|----------|
| Bare | 31505738 |
| White | 39256345 |
| Clear | 39256067 |
| Designer Black | 39256066 |

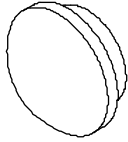

Header/Sill Strike Plate Adjustment Filler

NOTE: Field Service Only

NOTE: Used on OXXO units prior to 12/05/2022

| Color | PN |
|-------|----------|
| Black | 11882270 |

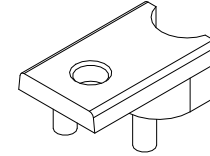

Bottom Stationary Panel Bracket Kit

Includes:

- 1 - Bracket
 - 2 - #8 x 1" Phillips pan head screws
 - 2 - #8 x 3/4" Pin-in Torx flathead screws - T20
- NOTE: Tamper resistant driver bit available in Tools section

| Color | Handing | PN |
|-----------------|---------|--------|
| Stainless Steel | LH | 105130 |
| | RH | 105133 |

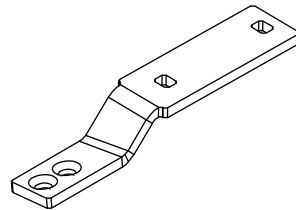

Stationary Panel Bracket

| Color | PN |
|-----------------|----------|
| Beige | 10500131 |
| Stainless Steel | 10501159 |
| Black | 10501139 |

| Suggested Fasteners | Color | PN |
|---|-----------------|----------|
| 3 - #8 x 1" Phillips self tapping pan head screws | Beige | 11806155 |
| | Stainless Steel | 11805185 |
| | Black | 11809255 |

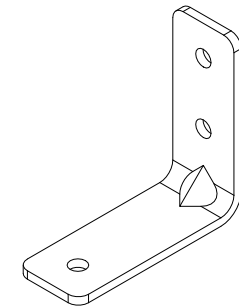

Stop Block Kit, XO/OX/OXO/OXXO Beige Sill

Includes:

- 2 - Bumper tack, Beige
- 1 - Bumper tack, Black
- 2 - Stop block, Beige
- 1 - Stop block, Bronze

| Color | PN |
|-------|--------|
| Beige | 117750 |

Stop Block Kit, XO/OX/OXO/OXXO Bronze Sill

Includes:

- 1 - Bumper tack, Beige
- 2 - Bumper tack, Black
- 1 - Stop block, Beige
- 2 - Stop block, Bronze

| Color | PN |
|--------|--------|
| Bronze | 117760 |

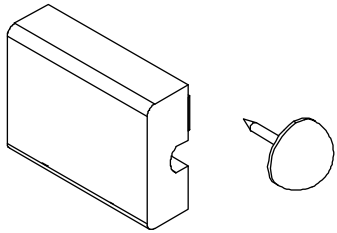

Stop Block Kit, OOX/XOO

Includes:

- 1 - Stop block, Beige
- 1 - Stop block, Bronze
- 1 - Stop block, 1-hole, Beige (not shown)
- 1 - Stop block, 1-hole, Bronze (not shown)
- 1 - Bumper tack, Beige
- 1 - Bumper tack, Black
- 1 - Stop block plug, Beige
- 1 - Stop block plug - Bronze
- 1 - #10 x 1 1/2" Phillips pan head screw

| PN |
|--------|
| 117770 |

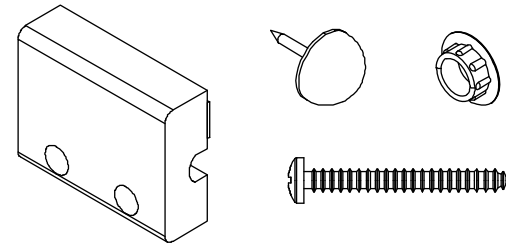

NOTE: When replacing interlock system parts on product manufactured between 2/25/2019 to 12/29/2020, all Interlock parts must be replaced with current parts and must be ordered separately. The replacement parts needed are the Interlock Seal Sub Assembly, Interlock Hook, V3189 Operator Interlock and V3130 Stationary Interlock.

Interlock Seal, Sub Assembly

Usage: Stationary panel

Qty 1 on OX/XO, OOX/XOO, OXO

Qty 2 on OXXO

Usage dates:

12/29/2020 to present

| Color | PN |
|-------|----------|
| Beige | 11870522 |
| Black | 11870521 |

| Suggested Fastener | PN |
|--|----------|
| 1 - #7 x 3/4" Type A-17, full thread, pan head screw | 11806164 |

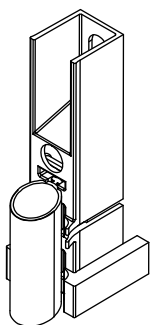

Interlock Hook

Usage: Stationary and operator panel

Qty 2 per panel

Usage dates:

12/29/2020 to present

| PN |
|----------|
| 10152337 |

| Suggested Fasteners | Color Match | PN |
|--|-------------|----------|
| 4 - #8-18 x 1" Type A, Phillips, pan head, full thread screw | Beige | 11806155 |
| | Black | 11809255 |
| | White | 11808055 |

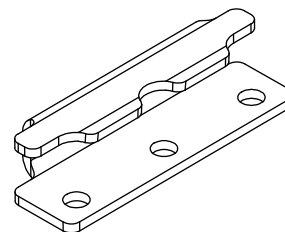

NOTE: When replacing interlock system parts on product manufactured between 2/25/2019 to 12/29/2020, all Interlock parts must be replaced with current parts and must be ordered separately. The replacement parts needed are the Interlock Seal Sub Assembly, Interlock Hook, V3189 Operator Interlock and V3130 Stationary Interlock.

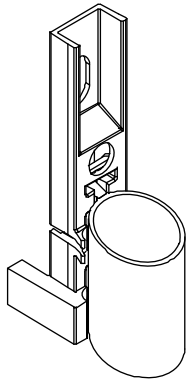

Interlock Seal, Sub Assembly

No longer available, replace with current part

Usage: 2/25/2019 to 12/29/2020

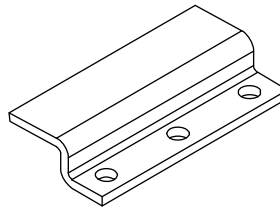

Interlock Hook

No longer available, replace with current part

Usage: 2/25/2019 to 12/29/2020

Tamper Resistant Pin-in T20 Driver Bit

NOTE: Used on T20 screws

| |
|----------|
| PN |
| 02095562 |

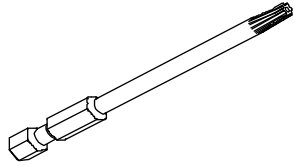

Aluminum Panel Guide

A1223

NOTE: All OXO CN operations will require 2 parts to make a complete panel guide

| CN width | Length | Oper | White PN | Black PN |
|-------------------------------|-----------------|------|----------|----------|
| 5-0 OX/XO, 7-6 OXO | 56 1/4" (1429) | | 18546050 | 19546050 |
| 7-6 OXO | 27 1/2 (699) | LH | 18546076 | 19546076 |
| | | RH | 18546077 | 19546079 |
| 7-6 OOX/XOO | 85 3/4" (2178) | | 18546079 | 19546079 |
| 6-0 OX/XO, 9-0 OXO | 68 1/4" (1734) | | 18546055 | 19546055 |
| 9-0 OXO | 33 1/2" (851) | LH | 18546092 | 19546092 |
| | | RH | 18546094 | 19546094 |
| 9-0 OOX/XOO | 103 3/4" (2635) | | 18546096 | 19546096 |
| 8-0 OX/XO, 12-0 (3 Panel) OXO | 92 1/4" (2443) | | 18546080 | 19546080 |
| 12-0 (3 Panel) OXO | 45 1/2" (1156) | LH | 18546097 | 19546097 |
| | | RH | 18546098 | 19546078 |
| 12-0 (3 Panel) OOX/XOO | 139 3/4" (3539) | | 18546093 | 19546093 |
| 10-0 OXXO | 51" (1295) | LH | 18546010 | 19546010 |
| | | RH | 18546011 | 19546011 |
| 12-0 (4 Panel) OXXO | 63" (1600) | LH | 18546012 | 19546012 |
| | | RH | 18546013 | 19546013 |
| 16-0 OXXO | 87" (2210) | LH | 18546016 | 19546016 |
| | | RH | 18546017 | 19546017 |

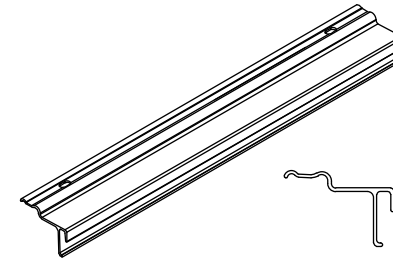

| Suggested Fasteners | Color Match | PN |
|--|-------------------|----------|
| #8 x 5/8" Phillips self tapping pan head screws (order quantity of 16 is recommended) | Beige (EA) | 11806158 |
| | Black (EA) | 11806173 |
| | Beige (pkg of 25) | 11807158 |
| | Black (pkg of 25) | 11807174 |

Leveling Block Insert

A2821

| CN Width | Length | PN |
|-------------------------|----------------|--------|
| 5-0/7-6/10-0 | 23 1/2" (597) | 169012 |
| 6-0/9-0/12-0 (4 panel) | 29 1/2" (749) | 169015 |
| 8-0/12-0 (3 panel)/16-0 | 41 1/2" (1054) | 169021 |

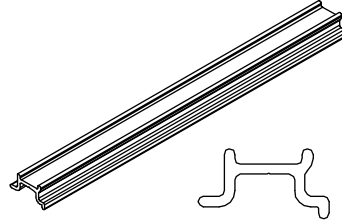

Spline, OOX/XOO

A3337

| CN | Length | Color and Part Number | | | | | | |
|------------|------------------|-----------------------|----------|----------|----------|----------|----------|------------|
| | | Stone White | Pebble | Bronze | Cashmere | Ebony | Gunmetal | *Evergreen |
| 6-5 height | 76 45/64" (1948) | 19541065 | 19541165 | 19541265 | 19541465 | 19541765 | 18841065 | 19541365 |
| 6-8 height | 79 13/64" (2012) | 19541068 | 19541168 | 19541268 | 19541468 | 19541768 | 18841068 | 19541368 |
| 7-0 height | 83 13/64" (2113) | 19541070 | 19541170 | 19541270 | 19541470 | 19541770 | 18841070 | 19541370 |
| 8-0 height | 92 45/64" (2356) | 19541080 | 19541180 | 19541280 | 19541480 | 19541780 | 18841080 | 19541380 |
| Lineal | 96" (2438) | 18541096 | 18541196 | 18541296 | 18541496 | 18541796 | 18841096 | 18541396 |

NOTE: *DISC (LA) used prior to 10/29/2022

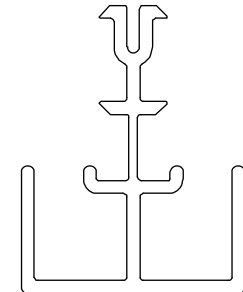

Astragal Base, Secondary Operator, OXXO

A3347

| CN Height | Length | Color, Handing and Part Number | | | | | |
|-----------|------------------|--------------------------------|----------|----------|----------|----------|----------|
| | | Stone White | | Pebble | | Bronze | |
| | | LH | RH | LH | RH | LH | RH |
| 6-5 | 74 31/32" (1904) | 19542066 | 19542065 | 19542166 | 19542165 | 19542466 | 19542465 |
| 6-8 | 77 15/32" (1968) | 19542069 | 19542068 | 19542169 | 19542168 | 19542469 | 19542468 |
| 7-0 | 81 15/32" | 19542071 | 19542070 | 18542171 | 19542170 | 19542471 | 19542470 |
| 8-0 | 90 31/32" (2311) | 19542081 | 19542080 | 19542181 | 19542180 | 19542481 | 19542480 |
| Lineal | 96" (2438) | 18542072 | | 18542172 | | 18542472 | |

| CN Height | Length | Color, Handing and Part Number | | | | | | | |
|-----------|------------------|--------------------------------|----------|----------|----------|-------------|----------|---------------|----------|
| | | Cashmere PN | | Ebony PN | | Gunmetal PN | | *Evergreen PN | |
| | | LH | RH | LH | RH | LH | RH | LH | RH |
| 6-5 | 74 31/32" (1904) | 19542366 | 19542365 | 19542566 | 19542565 | 18842066 | 18842065 | 19542366 | 19542365 |
| 6-8 | 77 15/32" (1968) | 19542369 | 19542368 | 19542569 | 19542568 | 18842069 | 18842068 | 19542369 | 19542368 |
| 7-0 | 81 15/32" | 19542371 | 18542370 | 19542571 | 19542570 | 18842071 | 18842070 | 19542271 | 19542270 |
| 8-0 | 90 31/32" (2311) | 19542381 | 19542380 | 19542581 | 19542580 | 18842081 | 18842080 | 19542381 | 19542380 |
| Lineal | 96" (2438) | 18542372 | | 18542572 | | 18842072 | | 18542272 | |

NOTE: *DISC (LA) used prior to 10/29/2022

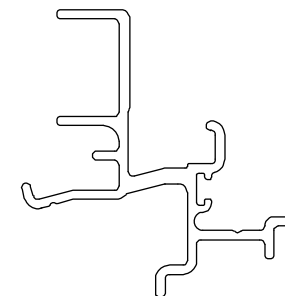

Astragal Cap, OXXO

A3348

| CN Height | Length | Color and Part Number | | | | | | |
|-----------|------------------|-----------------------|----------|----------|----------|----------|----------|------------|
| | | Stone White | Pebble | Bronze | Cashmere | Ebony | Gunmetal | *Evergreen |
| 6-5 | 75 11/64" (1909) | 19543065 | 19543165 | 19543265 | 19543465 | 19543565 | 18843065 | 19543665 |
| 6-8 | 77 43/62" (1973) | 19543068 | 19543168 | 19543268 | 19543468 | 19543568 | 18843068 | 19543368 |
| 7-0 | 81 43/64" | 19543070 | 19543170 | 19543270 | 19543470 | 19543570 | 18843070 | 19543370 |
| 8-0 | 91 11/64" (2316) | 19543080 | 19543180 | 19543280 | 19543480 | 19543580 | 18843072 | 19543380 |
| Lineal | 96" (2438) | 18543072 | 18543172 | 18543272 | 18543472 | 18543572 | 18843080 | 18543372 |

NOTE: *DISC (LA) used prior to 10/29/2022

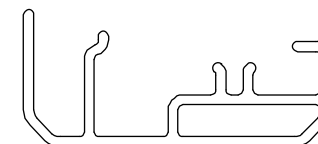

Stile Cover

A1222

NOTE: Used with A3218, Screen Stop Base, OXO

| CN Height | Length | Color and Part Number | | | | | | |
|-----------|------------------|-----------------------|----------|----------|----------|----------|----------|------------|
| | | Stone White | Pebble | Bronze | Cashmere | Ebony | Gunmetal | *Evergreen |
| 6-5 | 76 17/64" (1937) | 18547065 | 18547165 | 18547265 | 18546965 | 18546872 | 18847065 | 18547365 |
| 6-8 | 78 49/64" (2001) | 18547068 | 18547168 | 18547268 | 18546968 | 18546873 | 18847068 | 18547368 |
| 7-0 | 82 49/64" (2102) | 18547070 | 18547170 | 18547270 | 18546970 | 18546874 | 18847070 | 18547370 |
| 8-0 | 92 17/64" (2344) | 18547080 | 18547180 | 18547283 | 18546983 | 18546875 | 18847080 | 18547383 |

NOTE: *DISC (LA) used prior to 10/29/2022

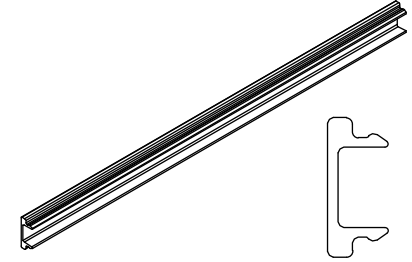

Screen Stop Base, OXO

A3218

| CN | Length | Color, Handing and Part Number | | | | | |
|------------|------------------|--------------------------------|----------|-------------|----------|----------|----------|
| | | Pebble | | Stone White | | Bronze | |
| | | LH | RH | LH | RH | LH | RH |
| 6-5 height | 77 3/32" (1958) | 18550166 | 18550165 | 18550066 | 18550065 | 18550266 | 18550265 |
| 6-8 height | 79 19/32" (2022) | 18550169 | 18550168 | 18550069 | 18550068 | 18550269 | 18550268 |
| 7-0 height | 83 19/32" (2123) | 18550171 | 08550170 | 18550071 | 18550070 | 18550271 | 18550270 |
| 8-0 height | 93 3/32" (2365) | 18550181 | 18550180 | 18550081 | 18550080 | 18550281 | 18550280 |

| CN | Length | Color, Handing and Part Number | | | | | | | |
|------------|------------------|--------------------------------|----------|----------|----------|----------|----------|------------|----------|
| | | Cashmere | | Ebony | | Gunmetal | | *Evergreen | |
| | | LH | RH | LH | RH | LH | RH | LH | RH |
| 6-5 height | 77 3/32" (1958) | 18550466 | 18550465 | 18550566 | 18550565 | 18850366 | 18850365 | 18550366 | 18550365 |
| 6-8 height | 79 19/32" (2022) | 18550469 | 18550468 | 18550569 | 18550568 | 18850369 | 18850368 | 18550369 | 18550368 |
| 7-0 height | 83 19/32" (2123) | 18550471 | 08550470 | 18550571 | 18550570 | 18850371 | 18850370 | 18550371 | 18550370 |
| 8-0 height | 93 3/32" (2365) | 18550481 | 18550480 | 18550581 | 18550580 | 18850381 | 18850380 | 18550381 | 18550380 |

NOTE: *DISC (LA) used prior to 10/29/2022

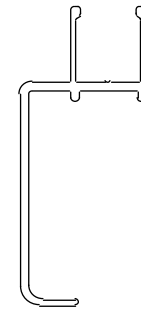

Ordering specifications for Configured Parts in OMS:

1. Unit type
2. Configuration (and handing, if needed)
3. Select a component: left, right, or center panel interlock weather strip
4. Unit size (call number, rough opening or frame size)
5. Interior and exterior color
6. Sill frame color (if needed)

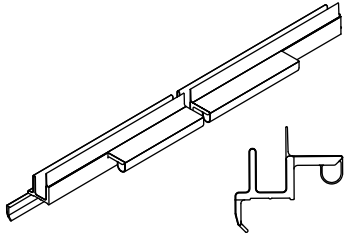

Stationary Interlock
V3130

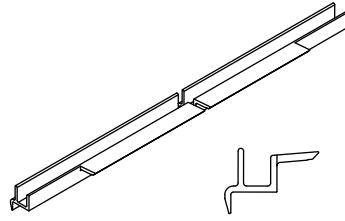

Operator Interlock
V3189

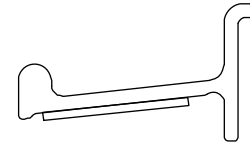

Roller Track
V2676
Includes foam sealant tape

| Suggested Fasteners | Color and Part Number | |
|--|-----------------------|----------|
| 9 - #8-18 x 1" Type A, Phillips, pan head, full thread screw | Beige | 11806155 |
| | Black | 11809255 |
| | White | 11808055 |

NOTE: When replacing interlock system parts on product manufactured between 2/25/2019 to 12/29/2020, all Interlock parts must be replaced with current parts and must be ordered separately. The replacement parts needed are the Interlock Seal Sub Assembly, Interlock Hook, V3189 Operator Interlock and V3130 Stationary Interlock.

Stationary Panel Leveling Block, Kit

V2344

Includes:

- 1 - Foam sealant tape
- #8 x 5/8" Phillips pan head screws (qty will be determined by CN size)

| CN Width | Length | Color and Part Number | |
|--|------------------|-----------------------|----------|
| | | Color | PN |
| 5-0 OX/XO/7-6 OXO 10-0 OXXO | 31 1/4" (794) | Beige | 10899010 |
| | | Black | 10802910 |
| 6-0 OX/XO/9-0 OXO 12-0 (4 panel) OXXO | 37 1/4" (946) | Beige | 10899012 |
| | | Black | 10802912 |
| 8-0 OX/XO 12-0 (3 panel) OXO 16-0 OXXO | 49 1/4" (1251) | Beige | 10899016 |
| | | Black | 10802916 |
| 7-6 OOX/XOO | 60 15/16" (1548) | Beige | 10802176 |
| | | Black | 10802976 |
| 9-0 OOX/XOO | 72 15/16" (1853) | Beige | 10802190 |
| | | Black | 10802990 |
| 12-0 (3 panel) OOX/ XOO | 96 15/16" | Beige | 10802112 |
| | | Black | 10802913 |



Sill Liner

V2693

Includes:

- Foam sealant tape

| CN Width | Length | Color and Part Number | |
|----------------|-----------------|-----------------------|----------|
| | | Beige | Black |
| 5-0 | 59" (1499) | 10860350 | 10860450 |
| 6-0 | 71" (1803) | 10860360 | 10860460 |
| 7-6 | 88 1/2" (2248) | 10860376 | 10860476 |
| 8-0 | 95" (2413) | 10860380 | 10860480 |
| 9-0 | 106 1/2" (2705) | 10860390 | 10860490 |
| 10-0 | 117 1/2" (2895) | 10860310 | 10860410 |
| 12-0 (4 panel) | 141 1/2" (3594) | 10860312 | 10860412 |
| 12-0 (3 panel) | 143" (3632) | 10860321 | 10860421 |
| 16-0 | 189 1/2" (4813) | 10860316 | 10860416 |

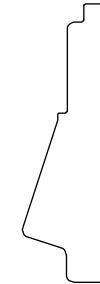

Interior Jamb Cover

V2939

NOTE: Only used on units with a painted interior finish.

| CN Height | Length | Color and Part Number | |
|-----------|----------------|-----------------------|----------|
| | | Black | White |
| 6-5 | 76 1/2" (1943) | 15900365 | 15900465 |
| 6-8 | 79" (2007) | 15900368 | 15900468 |
| 7-0 | 83" (2108) | 15900370 | 15900470 |
| 8-0 | 92 1/2" (2350) | 15900380 | 15900480 |

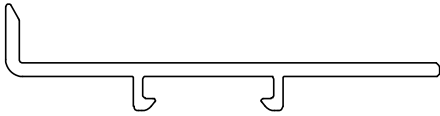

Jamb Cover Base

V2937

| Length | Color | PN |
|-------------|---------|----------|
| 1 1/4" (32) | Natural | 15600074 |
| 5" (127) | | 15600075 |



Spline Insert

V2638

| CN Height | Length | PN |
|-----------|----------------|----------|
| 6-5 | 75 5/8" (1921) | 15911265 |
| 6-8 | 78 1/8" (1984) | 15911268 |
| 7-0 | 82 1/8" (2086) | 15911270 |
| 8-0 | 91 5/8" (2327) | 15911280 |

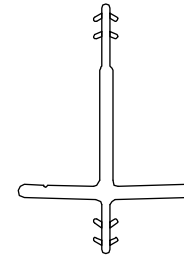

Stile Cover

V2165

| CN Height | Length | Color and Part Number | |
|-----------|------------------|-----------------------|--------|
| | | Stone White | Black |
| 6-5 | 76 13/32" (1941) | 259565 | 659565 |
| 6-8 | 78 29/32" (2004) | 259568 | 659568 |
| 8-0 | 92 13/32" (2347) | 259580 | 659580 |

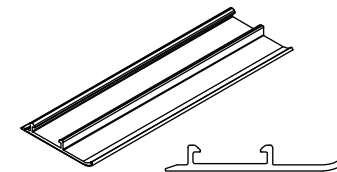

Astragal Cap, Vertical, OXO

V3003/V3005

| CN | Length | Beige PN | | White PN | | Black PN | |
|------------|----------------|----------|----------|----------|----------|----------|----------|
| | | RH | LH | RH | LH | RH | LH |
| 6-5 height | 77 1/2" (1969) | 15907066 | 15907065 | 15907166 | 15907165 | 15907266 | 15907265 |
| 6-8 height | 80 1/2" (2045) | 15907069 | 15907068 | 15907169 | 15907168 | 15907269 | 15907268 |
| 7-0 height | 84 1/2" | 15907071 | 15907070 | 15907171 | 15907170 | 15907271 | 15907270 |
| 8-0 height | 94" (2388) | 15907081 | 15907080 | 15907181 | 15907180 | 15907281 | 15907280 |

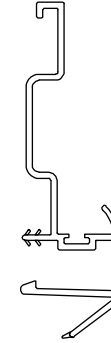

Secondary Bulb with Tape

V2414

For Field Service Only

| Length | Color | PN |
|--------|-------|----------|
| 96" | Beige | 11107696 |
| | Black | 11107697 |

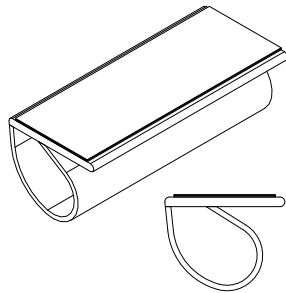

NOTE: When replacing interlock system parts on product manufactured between 2/25/2019 to 12/29/2020, all Interlock parts must be replaced with current parts and must be ordered separately. The replacement parts needed are the Interlock Seal Sub Assembly, Interlock Hook, V3189 Operator Interlock and V3130 Stationary Interlock.

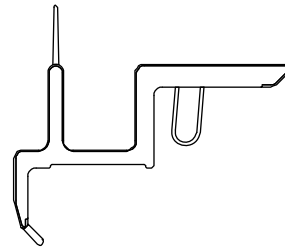

V2952 Interlock

No longer available, replace
with V3130 or V3189

Panel Guide

W8566

NOTE: CNs marked NA can be cut down from the next larger size

| CN Width | Length | Color and Part Number | | | |
|----------------|-------------------|-----------------------|----------|----------------|----------|
| | | Bare Wood | White | Designer Black | Clear |
| 5-0 | 56 6/16" (1430) | 31518750 | 39228750 | 39229750 | 31618750 |
| 6-0 | 69 5/16" (1735) | 31518755 | 39228755 | 39229755 | 31618755 |
| 7-6 | 85 13/16" (2180) | 31518776 | 39228776 | 39229776 | 31618776 |
| 8-0 | 92 5/16" (2345) | 31518780 | 39228780 | 39229779 | 31618780 |
| 9-0 | 103 13/16" (2637) | 31518792 | 39228792 | 39229792 | 31618790 |
| 10-0 | 114 5/16" (2904) | 31518710 | 39228710 | 39229710 | 31618710 |
| 12-0 (4 panel) | 138 5/16" (3513) | 31518712 | 39228712 | 39229712 | 31618712 |
| 12-0 (3 panel) | 139 13/16" (3551) | 31518713 | 39228713 | NA | NA |
| 16-0 | 186 5/16" (4732) | 31518716 | 39228716 | 39229716 | 31618716 |

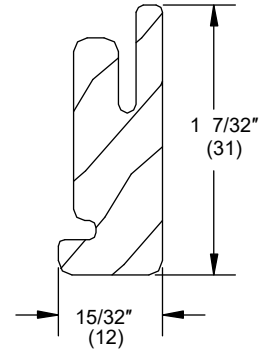

Head Jamb Liner

W8565

| CN Width | Length | Color and Part Number | | | |
|----------------|-----------------|-----------------------|----------|----------------|----------|
| | | Bare Wood | White | Designer Black | Clear |
| 5-0 | 58 7/8" (1495) | 31518650 | 39228650 | 39229050 | 31618650 |
| 6-0 | 70 7/8" (1800) | 31518655 | 39228655 | 39229055 | 31618655 |
| 7-6 | 88 3/8" (2245) | 31518676 | 39228676 | 39229076 | 31618676 |
| 8-0 | 94 7/8" (2410) | 31518680 | 39228680 | 39229081 | 31618681 |
| 9-0 | 106 3/8" (2702) | 31518692 | 39228692 | 39229095 | 31618690 |
| 10-0 | 116 7/8" (2969) | 31518610 | 39228610 | 39229010 | 31618610 |
| 12-0 (4 panel) | 140 7/8" (3578) | 31518612 | 39228612 | 39229012 | 31618612 |
| 12-0 (3 panel) | 142 3/8" (3616) | 31518613 | 39228613 | 39229013 | 31618613 |
| 16-0 | 188 7/8" (4797) | 31518616 | 39228616 | 39229016 | 31618616 |

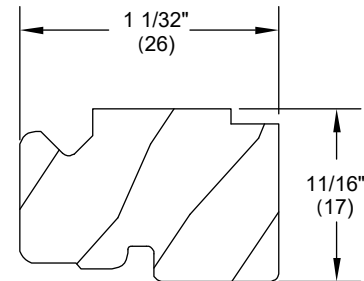

Astragal Trim

W7718

| CN Height | Length | Color and Part Number | | | |
|-----------|------------------|-----------------------|----------|----------------|----------|
| | | Bare Wood | White | Designer Black | Clear |
| 6-5 OXO | 75 27/64" (1916) | 31515965 | 39225965 | 39219065 | 31610465 |
| 6-8 OXO | 77 59/64" (1979) | 31515968 | 39225968 | 39219068 | 31610468 |
| 7-0 OXO | 81 59/64" (2081) | 31515970 | 39225970 | 39219070 | 31610470 |
| 8-0 OXO | 91 27/64" (2322) | 31515980 | 39225980 | 39219080 | 31610480 |

| CN Height | Length | Color and Part Number | | | |
|-----------|------------------|-----------------------|----------|----------------|----------|
| | | Bare Wood | White | Designer Black | Clear |
| 6-5 OXXO | 75 1/64" (1906) | 31514565 | 39224565 | 39219165 | 31610565 |
| 6-8 OXXO | 77 33/64" (1969) | 31514568 | 39224568 | 39219168 | 31610568 |
| 7-0 OXXO | 81 33/64" (2071) | 31514570 | 39224570 | 39219170 | 31610570 |
| 8-0 OXXO | 91 1/64" (2312) | 31514580 | 39224580 | 39219180 | 31610580 |

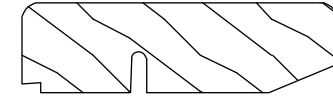

Interior Mull Trim

W7719

| CN Height | Length | Color and Part Number | | | |
|-----------|------------------|-----------------------|----------|----------------|----------|
| | | Bare Wood | White | Designer Black | Clear |
| 6-5 | 75 43/64" (1922) | 31518865 | 39228865 | 39229365 | 31610365 |
| 6-8 | 78 11/64" (1986) | 31518868 | 39228868 | 39229368 | 31610368 |
| 7-0 | 82 11/64" (2087) | 31518870 | 39228870 | 39229370 | 31610370 |
| 8-0 | 91 43/64" (2329) | 31518880 | 39228880 | 39229381 | 31610380 |

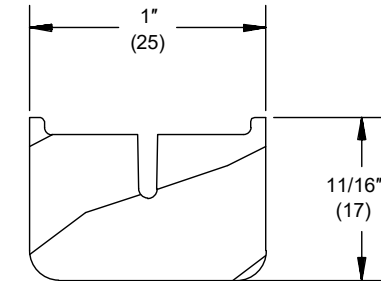

Jamb Liner

W7623

| CN Height | Length | Color and Part Number | | | |
|-----------|------------------|-----------------------|----------|----------------|----------|
| | | Bare Wood | White | Designer Black | Clear |
| 6-5 | 76 11/16" (1948) | 31503165 | 39203165 | 39209565 | 31613165 |
| 6-8 | 79 3/16" (2011) | 31503168 | 39203168 | 39209568 | 31613168 |
| 7-0 | 83 3/16" (2113) | 31503170 | 39203170 | 39209570 | 31613170 |
| 8-0 | 92 11/16" (2354) | 31503180 | 39203180 | 39209580 | 31613180 |

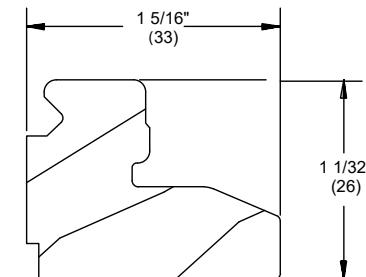

Interior Astragal, OXXO

W12167

A: Middle Handed

B: End Fabrication

| | CN Height | Length | Color, Handing/Location and Part Number | | | |
|---|------------|----------------|---|-----------|----------------|-----------|
| | | | Bare Wood | White | Designer Black | Clear |
| | | | Middle LH | Middle LH | Middle LH | Middle LH |
| A | 6-5 height | 18 1/2" (470) | 31520039 | 39220039 | 39209139 | 31609139 |
| | 6-8 height | 21" (533) | 31520033 | 39220033 | 39209133 | 31609133 |
| | 7-0 height | 25" (635) | 31520026 | 39220026 | 39209127 | 31609126 |
| | 8-0 height | 34 1/2" (876) | 31520035 | 39220035 | 39209135 | 31609135 |
| | | | Middle RH | Middle RH | Middle RH | Middle RH |
| | 6-5 height | 18 1/2" (470) | 31520038 | 39220038 | 39209138 | 31609138 |
| | 6-8 height | 21" (533) | 31520031 | 39220031 | 39209131 | 31609131 |
| | 7-0 height | 25" (635) | 31520025 | 39220025 | 39209125 | 31609125 |
| | 8-0 height | 34 1/2" (876) | 31520034 | 39220034 | 39209134 | 31609334 |
| B | | | End Fabrication | | | |
| | All | 22 9/32" (566) | 31520032 | 39220032 | 39209132 | 31609132 |

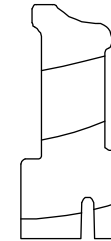

Astragal Assembly, OXO

Includes:

- 1 - Astragal
- 1 - Astragal cap
- 1 - Weather strip
- 1 - Top gasket
- 1 - Bottom gasket

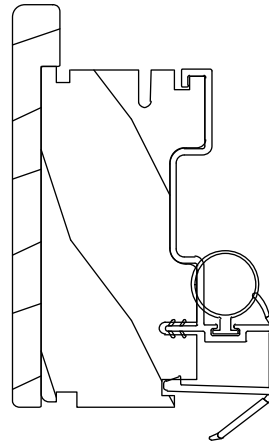

| Suggested Fasteners | PN |
|---|----------|
| 12 - #8-15 x 3 1/2" Type A/TF, Phillips, flat head, 2/3 thread screws | 05080121 |

| CN Height | Length | Stone White Cap with Beige Weather Strip | | Designer Black Cap with Beige Weather Strip | | Clear Cap with Beige Weather Strip | | Bare Wood Cap with Beige Weather Strip | |
|-----------|------------------|--|----------|---|----------|------------------------------------|----------|--|----------|
| | | LH | RH | LH | RH | LH | RH | LH | RH |
| 6-5 | 76 57/64" (1953) | 10305065 | 10305165 | 10306065 | 10306165 | 10307065 | 70307165 | 10308065 | 10308165 |
| 6-8 | 79 25/64" (2017) | 10305068 | 10305168 | 10306068 | 10306168 | 10307068 | 10307168 | 10308068 | 10308168 |
| 8-0 | 92 57/64" (2359) | 10305080 | 10305180 | 10306080 | 10306180 | 10307080 | 10307180 | 10308080 | 10308180 |

| CN Height | Length | Stone White Cap with Black Weather Strip | | Designer Black Cap with Black Weather Strip | | Clear Cap with Black Weather Strip | | Bare Wood with Black Weatherstrip | |
|-----------|------------------|--|----------|---|----------|------------------------------------|----------|-----------------------------------|----------|
| | | LH | RH | LH | RH | LH | RH | LH | RH |
| 6-5 | 76 57/64" (1953) | 10305265 | 10305365 | 10306265 | 10306365 | 10307265 | 10307365 | 10308265 | 10308365 |
| 6-8 | 79 25/64" (2017) | 10305268 | 10305368 | 10306268 | 10306368 | 10307268 | 10307368 | 10308268 | 10308368 |
| 8-0 | 92 57/64" (2359) | 10305280 | 10305380 | 10306280 | 10306380 | 10307280 | 10307380 | 10308280 | 10308380 |

| CN Height | Length | Stone White Cap with White Weather Strip | | Designer Black Cap with White Weather Strip | | Clear Cap with White Weather Strip | | Bare Wood Cap with White Weather Strip | |
|-----------|------------------|--|----------|---|----------|------------------------------------|----------|--|----------|
| | | LH | RH | LH | RH | LH | RH | LH | RH |
| 6-5 | 76 57/64" (1953) | 10305465 | 10305565 | 10306465 | 10306565 | 10307465 | 10307565 | 10308465 | 10308565 |
| 6-8 | 79 25/64" (2017) | 10305468 | 10305568 | 10306468 | 10306568 | 10307468 | 10307568 | 10308468 | 10308568 |
| 8-0 | 92 57/64" (2359) | 10305480 | 10305580 | 10306480 | 10306580 | 10307480 | 10307580 | 10308780 | 10308580 |

Astragal Cover, OXO

W13261

NOTE: Reference Instruction 19916315 for more details.

Usage dates:

February 2019 to present

| Length | Finish/Color | LH PN | RH PN |
|---------------------|----------------|----------|----------|
| 92 31/32" (2362) | Bare Wood | 31511680 | 31511681 |
| | Clear | 33821680 | 33821681 |
| | White | 39201680 | 39201681 |
| | Designer Black | 39921680 | 39921681 |



Interior Wood Cover

W13506

NOTE: Only used on units with bare wood or clear lacquer interiors.

| CN Height | Length | Color and Part Number | |
|-----------|----------------|-----------------------|--------|
| | | Bare Wood | Clear |
| 6-5 | 76 1/2" (1943) | 210065 | 211065 |
| 6-8 | 79" (2007) | 210068 | 211068 |
| 7-0 | 83" (2108) | 210070 | 211070 |
| 8-0 | 92 1/2" (2350) | 210080 | 211080 |

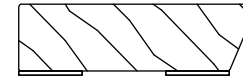

Stationary Panel Spacer

W8581

| Length | Bare Wood PN |
|-----------|--------------|
| 12" (305) | 31518812 |

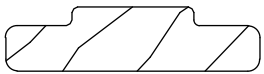

Ordering specifications for Configured Parts in OMS (Frame Weather Strip):

1. Unit type;
2. Configuration (handing, if needed);
3. Component;
4. Exterior and Interior color;
5. Unit size
6. Interior weather strip package color;
7. Component location (from exterior view).

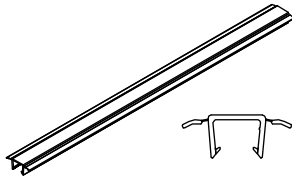

Frame Weather Strip
V2396/V2629

Ordering specifications for Configured Parts in OMS (Sill Weather Strip):

1. Unit type;
2. Configuration (handing, if needed);
3. Component;
4. Exterior and Interior color;
5. Unit size;
6. Sill frame color.

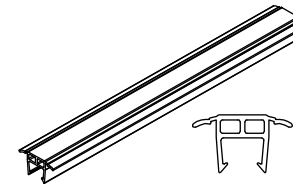

Sill Weather Strip
V2529/V2620

Weather Strip, Astragal

V2398

| Color | Length | PN |
|-------|-------------------------------|----------|
| Beige | Specify length, sold by LF | 15900187 |
| White | | 15900088 |
| Black | | 15900099 |

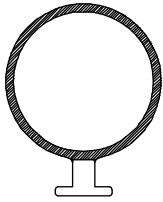

Backer Rod

| Color | Length | PN |
|-------|--------|----------|
| Gray | 5 ft. | 10510060 |

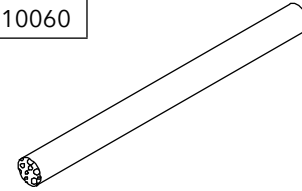

Head Jamb Dust Block

2 5/16" x 5/8" x 1/2" (59x16x13)

NOTE: Adhesive backed

| Color | PN |
|-------|----------|
| Gray | 10500135 |



Head Jamb to Stationary Panel Foam Plug

| Color | PN |
|-------|----------|
| Beige | 10500128 |

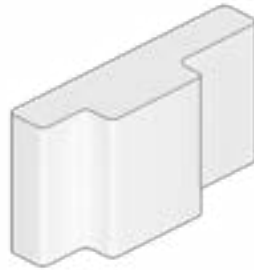

Sill Dust Block

2" x 13/16 x 5" (51 x 21 x 127)

NOTE: Adhesive backed

NOTE: Used on top and bottom of Astragal End Cap, OXXO and is also used with part 11860363

| Color | PN |
|-------|----------|
| Gray | 10500132 |

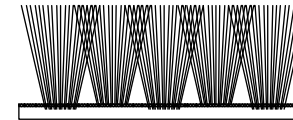

Stationary Panel Gasket, OOX/XOO

| Color | PN |
|---------|----------|
| Natural | 10503422 |

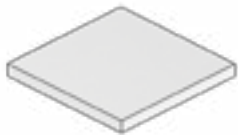

Astragal Gasket, OXO

| Color | PN |
|---------|--------|
| Natural | 105017 |

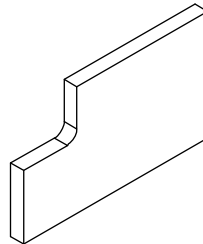

Frame Sealant, Foam, Sill Liner

1 1/16" x 3/8"

NOTE: Adhesive backed

| Length | Color | PN |
|----------------------------|-------|----------|
| Specify length, Sold by LF | Gray | 10500142 |

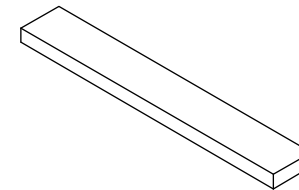

Elevate Sliding Patio Door Panels

Units manufactured February 25, 2019 to present

Ordering specifications (use all that apply):

1. Size; (verify manufacture date before ordering)
2. Operator or stationary;
3. Handing;
4. Exterior color;
5. Glazing;
6. Bare wood or white interior

NOTE: Operator panels include rollers, lock box, panel drip, interlock, aluminum and wood fillers. Stationary panels include interlock, stationary brackets, end caps, dust blocks, and wood spacers.

NOTE: Panels are not reglazable; replacement glass will require a new panel.

When replacing a panel for products produced between 2/25/2019 and 12/29/2020, the opposite panel also needs to upgrade to the V3130/ V3189 Interlock, current Interlock hook and current Interlock seal (stat panel only).

Daylight Opening (DLO) to Panel OM

Daylight Width + 4 5/8" (117) = OM Width of Panel

Daylight Height + 4 5/8" (117) = OM Height of Panel

| Width | |
|-------------------------|------------------|
| CN Size | OM Width |
| 5-0/7-6/10-0 | 29 5/8" (752) |
| 6-8/9-0/12-0 (4 Panel) | 35 5/8" (905) |
| 8-0/12-0 (3 panel)/16-0 | 47 5/8" (1210) |
| Height | |
| CN Size | OM Height |
| 6-5 | 76 21/32" (1947) |
| 6-8 | 79 5/32" (2011) |
| 7-0 | 83 5/32" (2112) |
| 8-0 | 92 21/32" (2353) |

EXTERIOR VIEW
Sliding Patio Door

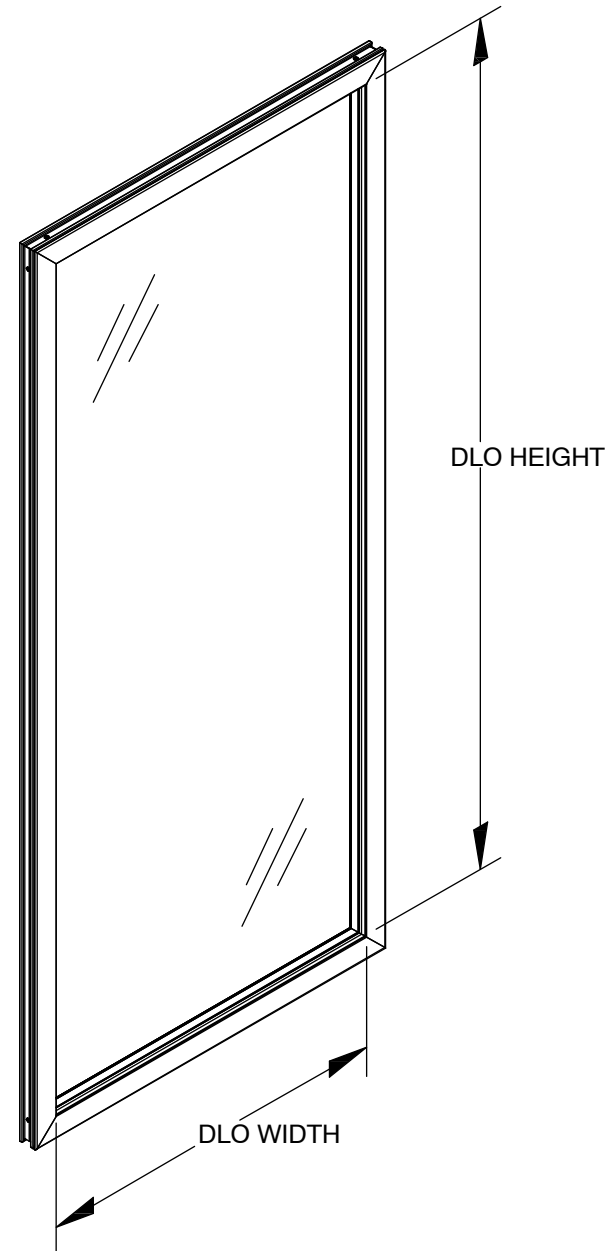

Ordering specifications (use all that apply):

1. size; if there is no existing screen from which to obtain the OM of the screen, determine the size of the screen by using the conversion chart below. The daylight opening is the measurement of the visible glass;
2. handing;

NOTE: Screens are standard with a color matched aluminum surround. Standard mesh is Marvin Bright View™. Determine the outside measurement of the existing screen. Find the sizes that correspond to the width and height indicated on the following chart.

NOTE: 02/14/2020: The screen handle position was changed to a height dimension of 38" from the bottom of the screen to the center of the handle.

Daylight Opening (DLO) to OM of screen

Daylight Width + 4 3/16" (106) = OM Width of Screen

Daylight Height + 5 1/64" (127) = OM Height of Screen

| Width | |
|-------------------------|------------------|
| CN Size | OM Width |
| 5-0/7-6/10-0 | 29 3/16" (741) |
| 6-8/9-0/12-0 (4 Panel) | 35 3/16" (894) |
| 8-0/12-0 (3 panel)/16-0 | 47 3/16" (1199) |
| Height | |
| CN Size | OM Height |
| 6-5 | 77 3/64" (1957) |
| 6-8 | 79 35/64" (2020) |
| 7-0 | 83 35/64" (2122) |
| 8-0 | 93 3/64" (2363) |

Head Jamb Screen Track

A1237

*NOTE: For NA Part number, order next size up

| CN Width | Length | Color and Part Number | | | | | | |
|---------------------------------|-------------------|-----------------------|----------|----------|----------|----------|----------|------------|
| | | Stone White | Pebble | Bronze | Cashmere | Ebony | Gunmetal | *Evergreen |
| 5-0 OX, XO | 57 31/64" (1460) | 11897145 | 11897146 | 11897147 | 11897149 | 11898150 | 18847050 | 11897148 |
| 6-0 OX, XO | 69 31/64" (1765) | 11897150 | 11897151 | 11897152 | 11897154 | 11898155 | 18847055 | 11897153 |
| 7-6 OOX, XOO, OXO | 86 63/64" (2210) | 10870476 | 10870576 | 10870676 | 10871867 | 10870967 | 18847076 | 10870767 |
| 8-0 OX, XO | 93 31/64" (2375) | 11897155 | 11897156 | 11897157 | 11897159 | 11898160 | 18847082 | 11897158 |
| 9-0 OOX, XOO, OXO | 104 63/64" (2667) | 11897160 | 11897161 | 11897162 | 11897164 | 11898165 | 18847095 | 11897163 |
| 10-0 OOX, XOO | 115 31/64" (2934) | 10890010 | 10890011 | 10890012 | 10890014 | 10890015 | 18847010 | 10890013 |
| 12-0 (4 panel) OXXO | 139 31/64" (3543) | 10890110 | 10890111 | 10890112 | 10890114 | 10890115 | 18847012 | 10890113 |
| 12-0 (3 panel) OOX, XOO, OXO | 140 63/64" (3581) | 11897812 | 11897912 | 11898012 | 11898212 | 11898312 | 18847013 | 11898112 |
| 16-0 OXXO | 187 31/64" (4762) | 10890210 | 10890211 | 10890212 | 10890214 | 10890215 | 18847016 | 10890213 |

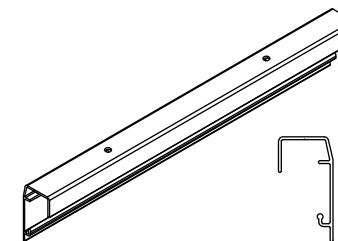

Screen Parts

| Suggested Fasteners | Color Match | PN |
|---|-------------------|----------|
| #8 x 5/8" Phillips self tapping panhead screws OX/XO uses a quantity of 8 OOX/XOO/OXO uses a quantity of 12 OXXO uses a quantity of 16 | Beige (EA) | 11806158 |
| | Black (EA) | 11806173 |
| | Beige (pkg of 25) | 11807158 |
| | Black (pkg of 25) | 11807174 |

NOTE: *DISC (LA) used prior to 10/29/2022

Screen Astragal, OXXO

A2740

Includes:

5 - Screen dust blocks

5 to 7 - #7-19 x 1 1/2" Phillips pan head screws (11807111)

1 - Sliding screen instruction

| CN Height | Length | Color and Part Number | | | | | | |
|-----------|------------------|-----------------------|----------|----------|----------|----------|----------|------------|
| | | Stone White | Pebble | Bronze | Cashmere | Ebony | Gunmetal | *Evergreen |
| 6-5 | 75 23/64" (1914) | 11810065 | 11820065 | 11830065 | 11870065 | 11880065 | 11848065 | 11840065 |
| 6-8 | 77 55/64" (1978) | 11810068 | 11820068 | 11830068 | 11870068 | 11880068 | 11848068 | 11840068 |
| 7-0 | 81 55/64" (2079) | 11810070 | 11820070 | 11830070 | 11870070 | 11880070 | 11848070 | 11840070 |
| 8-0 | 91 23/64" (2320) | 11810080 | 11820080 | 11830080 | 11870080 | 11180080 | 11848080 | 11840080 |

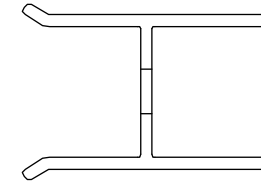

NOTE: *DISC (LA) used prior to 10/29/2022

Screen Roller Guide

V2932

| CN Width | Color | PN |
|-------------------------|-------|----------|
| 5-0/7-6/10-0 | Black | 15918851 |
| 6-0/9-0/12-0 (4 panel) | | 15918861 |
| 8-0/12-0 (3 panel)/16-0 | | 15918881 |

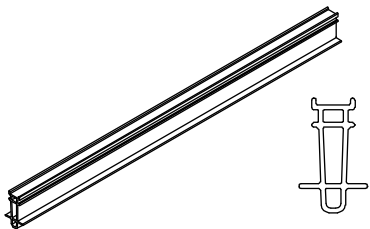

Screen Pile Weather Strip, Sliding Screen

| PN |
|----------|
| 10600252 |

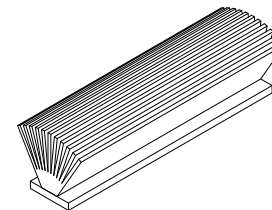

Screen Handle Assembly

Includes:

- 1 - Exterior handle - a
- 1 - Interior handle - b
- 1 - Slide - c
- 1 - Latch - d
- 3 - Screws
- 1 - Rivet

| Color | PN |
|-------|----------|
| Black | 10150028 |

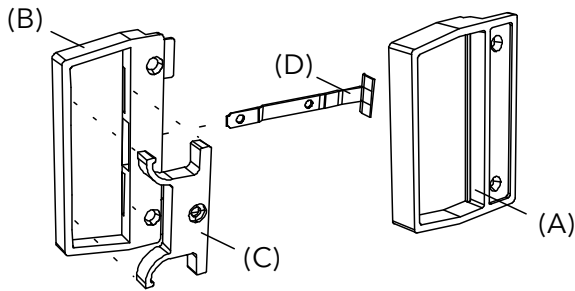

Screen Bumper

3/4" x 3/4" x 1 3/8"

| PN |
|----------|
| 02540675 |

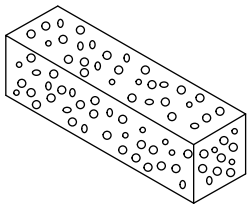

Screen Roller Assembly

Includes:

- 2 - Rollers
- 2 - Machine screws
- 2 - Grommet washers

| PN |
|----------|
| 11869525 |

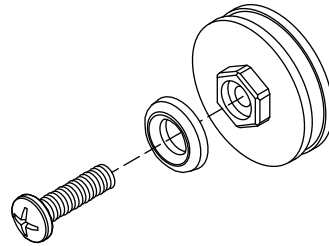

Screen Door Strike Kit

Includes:

- 1 - #8 x 5/8" Phillips pan head screw

| PN |
|----------|
| 11897165 |

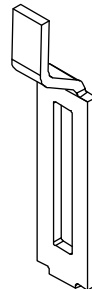

Screen Door Meeting Stile Dust Block

17/32" x 7/8" x 1/2" (13x22x13)

NOTE: Adhesive backed

| Color | PN |
|-------|----------|
| Gray | 10500161 |

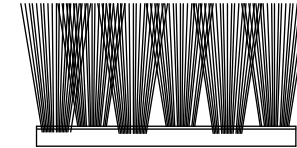

Screen Door Stop Kit

Includes:

- 2 - #8 x 5/8" pierce point, Phillips truss head screws

| PN |
|----------|
| 10188177 |

