











WOOD ROUND TOP DOOR TRANSOMS

RT1 TRUE HALF CIRCLE STANDARD SIZES - DIRECT GLAZE

RO (mm)	5-0 (1524)	6-0 (1829)	5-15/8 (1565)	6-15/8 (1870)	8-15/8 (2480)
2-6 (762)					
RO (mm)		3-0 (914)	2-6 13/16 (783)	3-0 13/16 (1240)	4-0 13/16 (1240)
	WDRRT50R28R	WDRRT60R33R	WDRRT5030	WDRRT6036	WDRRT8048

RT29 ELLIPTICAL STANDARD SIZES - DIRECT GLAZE

RO (mm)	5-0 (1524)	6-0 (1829)	5-15/8 (1565)	6-15/8 (1870)	8-15/8 (2480)
1-5 15/16 (456)					
RO (mm)					
	WDRRT50R14R	WDRRT60R14R	WDRRT5017	WDRRT6017	WDRRT8021

CONSTRUCTION DETAILS

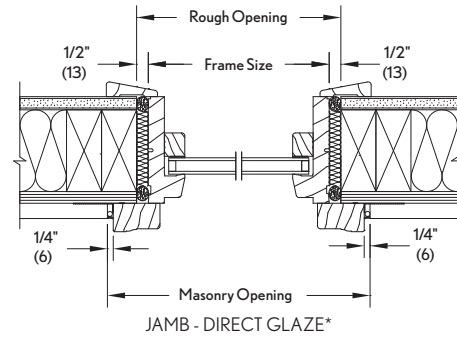
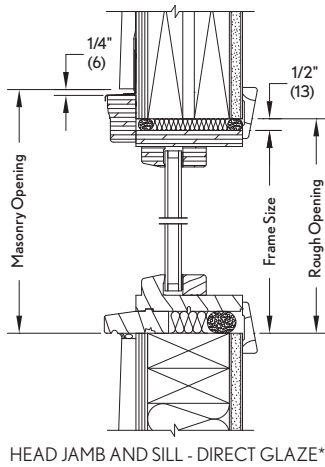

NOTES:

- If these units are not used as transoms, add 15/16" (24) to rough opening heights for subsill.
- Non-back rabbet casing shown. Back rabbet casing used on Wood Ultimate Sliding French Doors, Wood Patio Doors, Wood 2 1/4" Inswing French Doors and Wood Commercial Doors.