

CASEMENT ROUND TOPS

Multiple Assemblies

MO (mm)	2-4 1/2 (724)	MO (mm)	3-4 1/2 (1029)	MO (mm)	4-0 1/2 (1232)	MO (mm)	4-8 1/2 (1435)
RO (mm)	2-5 (737)	RO (mm)	3-5 (1041)	RO (mm)	4-1 (1245)	RO (mm)	4-9 (1448)
FS (mm)	2-4 (711)	FS (mm)	3-4 (1016)	FS (mm)	4-0 (1219)	FS (mm)	4-8 (1422)
4-1 3/8 (1254) 4-1 5/8 (1260) 4-1 1/8 (1248)	 IRT29 1W / ICA2935	4-1 1/8 (1508) 4-1 5/8 (1514) 4-1 1/8 (1502)	 IRT212W / ICA2139 2W	5-1 1/8 (1813) 5-1 5/8 (1819) 5-1 1/8 (1807)	 IRT25 2W / ICA2547 2W	6-1 1/8 (2118) 6-1 5/8 (2124) 6-1 1/8 (2111)	 IRT29 2W / ICA2955 2W E
4-5 3/8 (1356) 4-5 5/8 (1362) 4-5 1/8 (1349)	 IRT29 1W / ICA2939	5-7 3/8 (1711) 5-7 5/8 (1718) 5-7 1/8 (1705)	 IRT212W / ICA2147 2W	6-7 3/8 (2016) 6-7 5/8 (2022) 6-7 1/8 (2010)	 IRT25 2W / ICA2555 2W	7-3 3/8 (2219) 7-3 5/8 (2226) 7-3 1/8 (2213)	 IRT29 2W / ICA2959 2W E
5-1 3/8 (1559) 5-1 5/8 (1565) 5-1 1/8 (1553)	 IRT29 1W / ICA2947 E	6-3 3/8 (1915) 6-3 5/8 (1921) 6-3 1/8 (1908)	 IRT212W / ICA2155 2W	7-3 3/8 (2219) 7-3 5/8 (2226) 7-3 1/8 (2213)	 IRT25 2W / ICA2563 2W	7-7 3/8 (2321) 7-7 5/8 (2327) 7-7 1/8 (2315)	 IRT29 2W / ICA2963 2W E
5-9 3/8 (1762) 5-9 5/8 (1768) 5-9 1/8 (1756)	 IRT29 1W / ICA2955 E	6-7 3/8 (2016) 6-7 5/8 (2022) 6-7 1/8 (2010)	 IRT212W / ICA2159 2W	6-7 3/8 (2016) 6-7 5/8 (2022) 6-7 1/8 (2010)	 IRT25 2W / ICAP4955	7-7 3/8 (2321) 7-7 5/8 (2327) 7-7 1/8 (2315)	 IRT29 2W / ICAP5763

Construction Detail

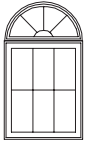
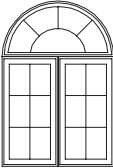
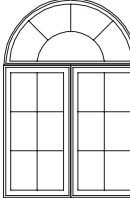
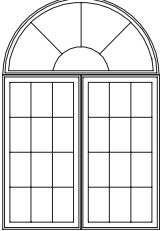
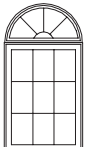
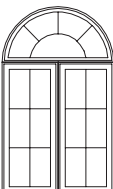
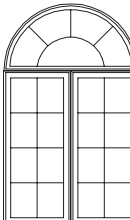
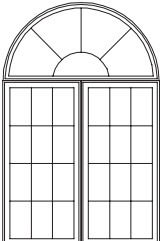
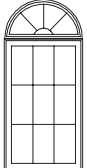
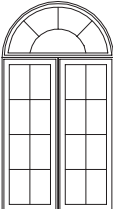
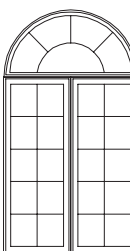
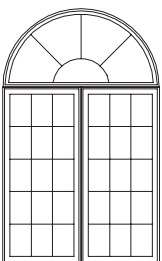
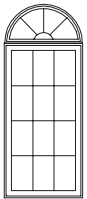
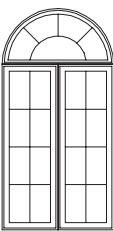
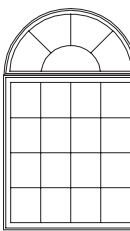
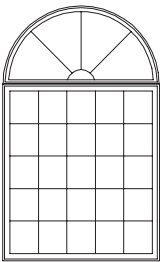
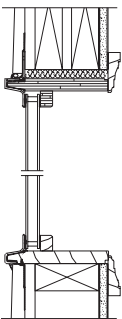

Casement
Head Jamb and Sill

Horizontal Mullion Detail

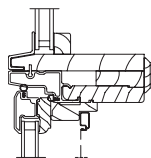

Casement Round Top
Over Casement