

INTEGRITY ALL ULTREX POLYGON

Table of Contents

	PAGE
History	2
Part Identification	3
Parts	
Vinyl parts	4
Glass Replacement	5

ATTENTION:

- Specification and technical data are subject to change without notice.
- Numbers listed in parentheses () are metric equivalents in millimeters rounded to the nearest whole number.

PRODUCED	UNIT TYPE	FEATURES OR CHANGES	DISCONTINUED
April 2006	Polygon	Unit features 7/8" double strength insulating Low E II w/argon. GBGs are available in White and Pebble Gray. 2" jambs with a 4 9/16" and 6 9/16" extensions. Available with factory applied sheet rock return and field applied J-channel. White interior only with white hardware. Pebble Gray and Stone White Ultrex exteriors.	
September 2006	Polygon	Prairie GBG Lite cuts made available for the All Ultrex Series products. See Product Bulletin 69 for more details.	Present
March 2007	Polygon	Bronze exterior introduced.	Present
November 2007	Polygon	Evergreen exterior introduced.	Present
March 2008	Polygon	Cashmere exteriors introduced.	Present
March 2009	Polygon	Ebony exteriors introduced.	Present
May 2009	Polygon	LoE ³ 366™ glass option introduced.	Present
February 2015	Polygon	Introduced new nailing fin with drip cap for All Ultrex	Present

**HEAD JAMB
& SILL DETAIL**

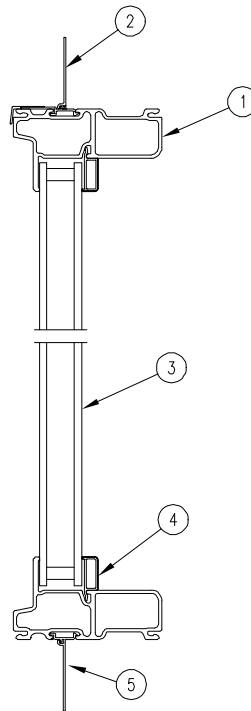

**JAMB
DETAIL**

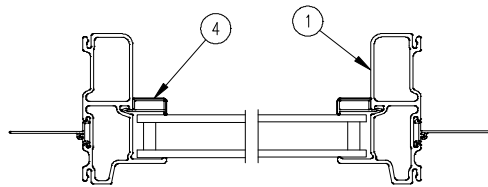

NOTE: Not to scale; specifications subject to change without notice.

1. Frame
2. Nailing Fin w/Drip Cap
3. Insulating Glass
4. Glazing Stop
5. Nailing Fin

When ordering replacement parts specify:

1. Type of unit;
2. Part number;
3. Description.

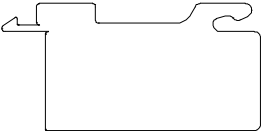
ILLUSTRATION <i>NOT TO SCALE</i>	DESCRIPTION	LENGTH	PART NO.
	Glazing Stop V1473	150" (3810)	17012799
	Secondary Frame Transom Mull V1664	CN10 9 7/8" (251) CN16 15 7/8" (403) CN50 59 5/32" (1503) CN5-10 69 21/32" (1769) CN60 71 5/32" (1807) CN90 107 5/32" (2722) Lineal 144" (3658)	11700135 11700195 11700595 11700695 11700715 11701075 11700099

POLYGON/DIRECT GLAZE GLASS REPLACEMENT

ORDERING REPLACEMENT GLASS

When ordering replacement glass specify:

1. Order #
2. Shape (see shapes below);
3. Rough opening* (polygon shapes only);
4. Glazing

* If rough opening is not available, provide the exterior daylight opening by measuring at key dimensions shown in the shape chart below and contact your Integrity representative to calculate rough opening.

NOTE: Glazing stops are included with replacement glass.

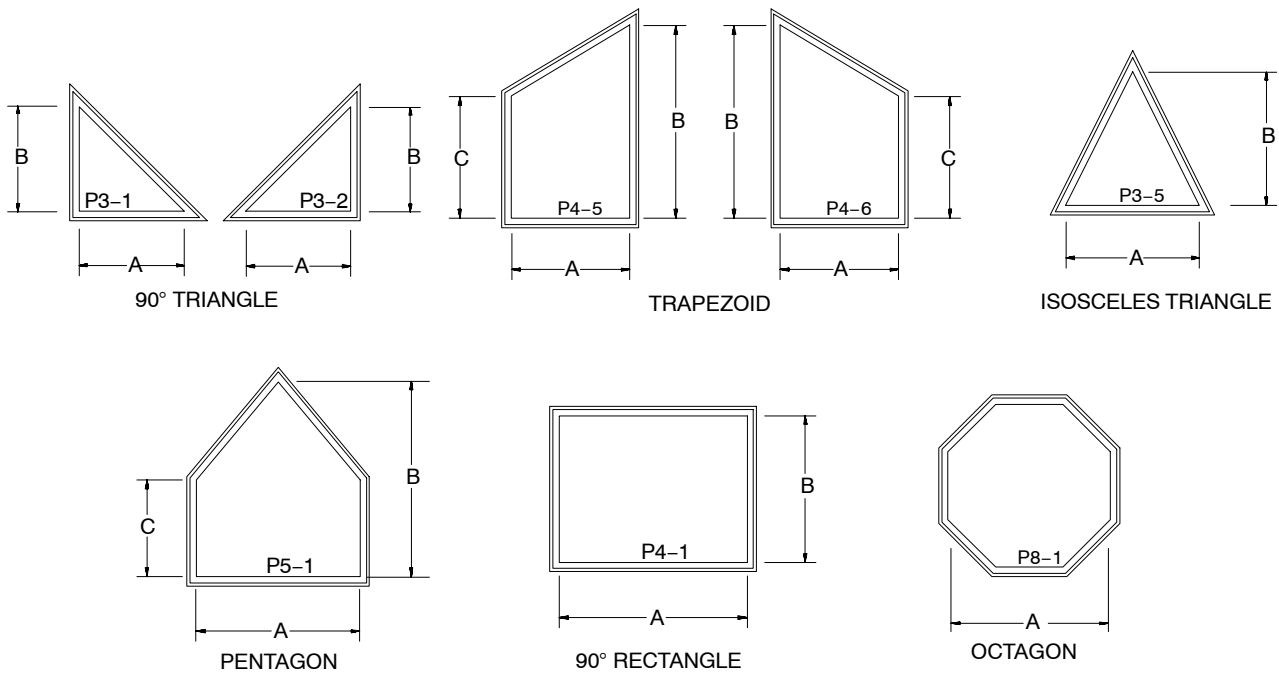

NOTE: Exterior view shown