

Factory Applied Casement Window Opening Control Device Operating Instruction

ABSTRACT: This instruction is for Marvin Ultimate Casement (UCA), Infinity Casement (NCA/NINCA), Integrity Wood-Ultrex Casement (ICA), and Integrity All Ultrex Casement (IFCA). Follow all installation instructions provided. The window opening control device meets the requirements of ASTM F2090-10.

NOTE: Leave a copy of the safety information for the building owner and building occupant, if applicable where the device is located.



CAUTION

All building and fire codes should be consulted before installing window units with factory installed window opening control devices. Contact local building code department or fire department for specific codes. It is critical to check your local building codes to determine the specific requirements regarding Window Opening Control Devices, egress and all other compliance requirements applicable to your project or circumstances. The casement WOCD is not appropriate for use in coastal applications. **Do not** remove window opening control device at any time, improper reapplication may result in the device being ineffective in preventing falls through an open window.

NOTE: Numbers listed in parentheses () are metric equivalents in millimeters rounded to the nearest whole number.



WARNING!

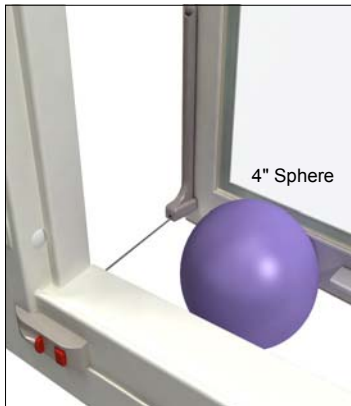

Possible Fall Hazard: Young children may fall out of the window if the window fall prevention device is not installed correctly. When properly engaged, no space shall exist at the lowest opening portion of the window opening that would permit the passage of a rigid sphere measuring 4" (102) in diameter.

NOTE: Once installation of unit is complete, check window opening control device for proper operation. When the sash is closed and locked the window opening control device should automatically engage.

Maximum unit size device is intended for:		
Unit	Frame Size	
ICA	36.00" (914) x 71.125" (1807)	
IFCA	35.50" (902) x 71.500" (1816)	
NCA, NINCA	>36.00" (914) Width	40.00" (1016) x 60.00" (1524)
	≤36.00" (914) Width	36.00" (914) x 86.00" (2184)
CUCA, CURCA, CUCART	≤36.00" (914) Width	36.00" (914) x 96.125" (2442)
	≤36.00" (914) Width	36.00" (914) x 96.125" (2442)
WUCA, WURCA, WUCART	>36.00" (914) Width	40.00" (1016) x 92.063" (2338)
	≤36.00" (914) Width	40.00" (1016) x 97.063" (2465)

Disengaging the Window Opening Control Device

1. Unlock window and open sash.
2. Depress red lock button and hold.
3. Slide lock lever toward the lock button and the locking bullet will retract into the tether housing on the sash.

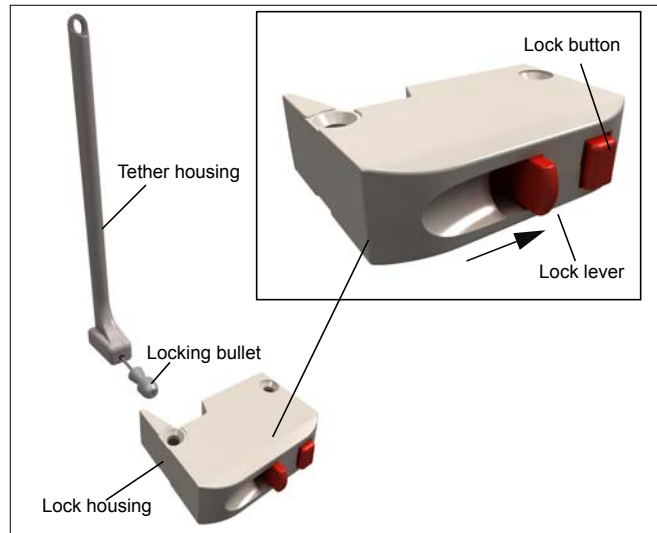

Reset the Window Opening Control Device

1. Close sash and lock window.