

# Wood Grilles

## Grille Tack Field Installation Procedures

**ATTENTION:** For ease of staining and painting, install grille tacks after the window sash has been painted or stained.

**NOTE:** Removal of the sash is not required to perform this procedure. Ensure that the slots at the end of each grille bar are clear prior to installation.

**NOTE:** Numbers listed in parentheses ( ) are metric equivalents in millimeters rounded to the nearest whole number.

### Step 1: Prep Sash for Installation

1. Place grille square and flat against the glass.
2. Apply a 1/2" (13) x 1" (25) piece of painters tape on stile and rails of sash or panel where grille bars make contact with the sash.
3. Use a pencil to mark center of vertical and horizontal grille bars on the tape. See figure 1.

**NOTE:** Marvin product used for illustrative purposes only.

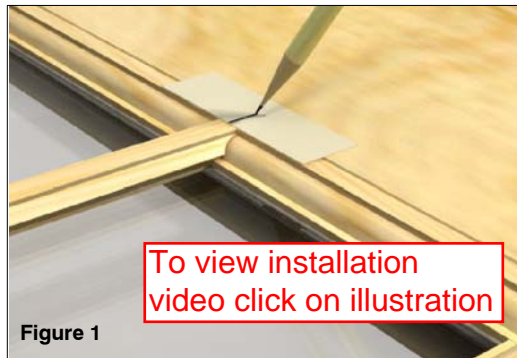

### Step 2: Install Grille Tacks

1. Remove grille assembly from sash or panel.
2. Insert grille tack into slot on flat end of the installation tool. See figure 2.

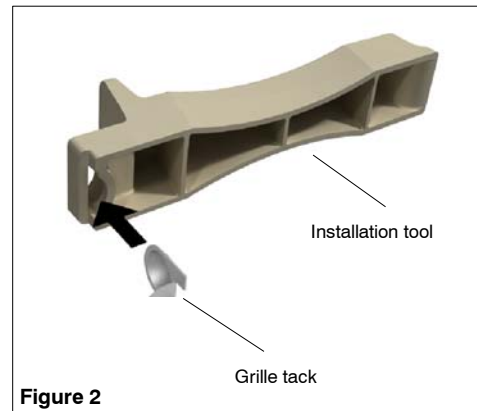

3. Place installation tool flat on the glass and line up center of tack with mark on the tape. Push grille tack into place. See Figure 3.

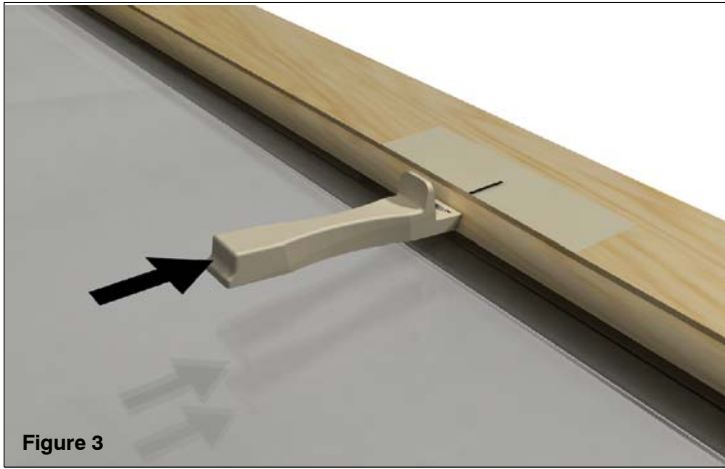

4. Lift installation tool straight upward, away from the glass, to disconnect from grille tack.

5. Rotate tool 180 degrees; place tool on glass against the back of the tack; firmly press on grille tack until seated. See figure 4.



**WARNING: Possible choking hazard. Ensure that the grille tacks are firmly seated and keep out of reach of children.**



### Step 3: Install Grille

1. Place grille assembly against the grille tacks and press each bar flat against the glass until seated.