

Marvin Interior Shades

Sliding Door Installation Instruction

ABSTRACT: The following instruction is for installing a Marvin Interior Shade on a Sliding Door. *NOTE: Shades are for use only in connection with Marvin® brand windows and doors. Shades are not covered under warranty if used with Integrity®, Infinity®, or any third party manufacturer's product.*

NOTE: Numbers listed in parentheses () are metric equivalents in millimeters rounded to the nearest whole number.



WARNING

Always practice safety! Wear the appropriate eye, ear and hand protection, especially when working with power tools.

NOTE: If the video does not play you may need an updated version of [Adobe Reader](#).



Seek Assistance

We recommend two people for installing the shade.

You Will Need to Supply

Flathead screwdriver	Phillips screwdriver
Allen wrench (1/8" or smaller)	Rubber mallet
Paste wax (furniture wax or floor wax)	

Before you Begin

Interior shade cartridges need to be correctly positioned before you start installation. A label is located at the bottom of the shade cartridge; it is important to leave this label attached (it is hidden from view) so you will have a reference number should you need to contact your Marvin representative.

NOTE: Finishing should be completed prior to installing your shade.

Stationary Panel Shade Installation

NOTE: Do not remove stretch wrap from cartridge until cartridge is attached.

1. Using a flathead screwdriver, remove the head and sill guide track(s) in front of the operator panel(s). Do not remove guide track(s) in front of the stationary panel(s). On a three wide configuration (OOX or XOO), remove guide track from center (the center O panel) only. Install shade on end stationary panel first. See figure 1.



Figure 1

2. Remove pocket cover from stationary panel by gently prying cover from frame (the cover is barbed to the frame). See figure 2.



Figure 2

3. Insert stationary interior shade cartridge into track. Pull bar faces towards operator panel. See figure 3.



Figure 3



Tip

Grasp fabric adapter pull towards the quarter turn connector for easier connection.

- Using an 1/8" (3) or smaller allen wrench to attach fabric adapter to stationary jamb extension via the quarter turn connector on bottom and top. See figure 4.

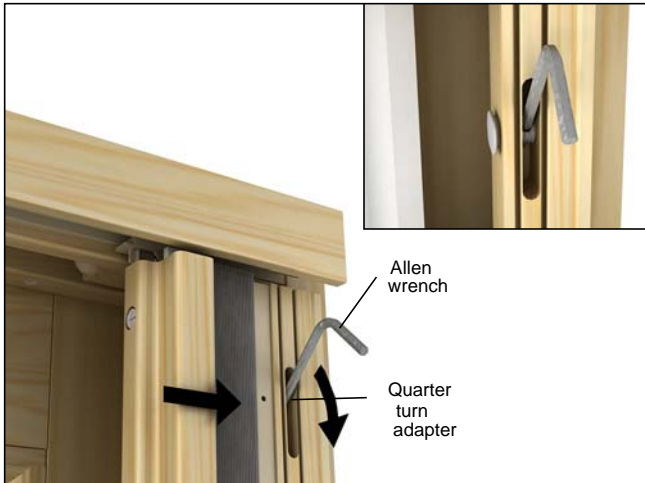

Figure 4

- Using an 1/8" (3) or smaller allen wrench, loosen the top quarter turn connector. This will temporarily take tension off of the top cords.
- Remove stretch wrap from top section of cartridge



Tip

Make sure cords are not twisted or braided.

- Remove the #6 x 1/4" pan head screw in head track. Save this screw for use in the next step. See figure 5.



Figure 5

- Fasten terminal ring to the head guide using the #6 x 1/4" pan head screw. See figure 6.



Figure 6

- Using an 1/8" (3) or smaller allen wrench, tighten the top quarter turn connector and loosen the bottom quarter turn connector. This will temporarily take tension off of the top cords.
- Remove stretch wrap from bottom section of cartridge.
- Remove the #6 x 1/4" pan head screw in sill guide track. Save this screw for use in the next step. See figure 7.



Figure 7

- Fasten terminal ring to the sill guide using #6 x 1/4" pan head screw. See figure 8.



Figure 8

- If the door is a 3 wide unit, install the interlocking panel interior shade. Follow same steps as stationary panel shade installation.



Tip

The top foam gasket on a three wide unit may need to have slit cut into it so that the cords can be strung through gasket.

- Reinstall the guide tracks into both the head and sill by pressing firmly in to place. See figure 9.

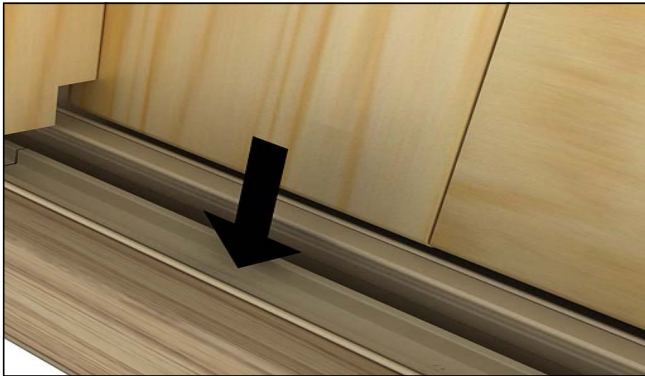

Figure 9

NOTE: Guide track may slide side to side during operation of shade if one guide track is removed. If this happens the fabric adapter may drop down behind the guide track. This will be noticed if the remaining guide track appears too long when reinstalling. Raise the fabric adapter up and slide the guide track back underneath prior to reinstalling the remaining guide track.

- Check the operation of the interior stationary shade(s).
- Check for proper tension. Top and bottom spring tension needs to be 3 1/2"-4 1/8" (89-105), center spring needs to be 3"-3 1/2" (76-89) for the shade to properly work. See figure 10. Measure from the end of the top loop on string to the opposing loop on the bottom.

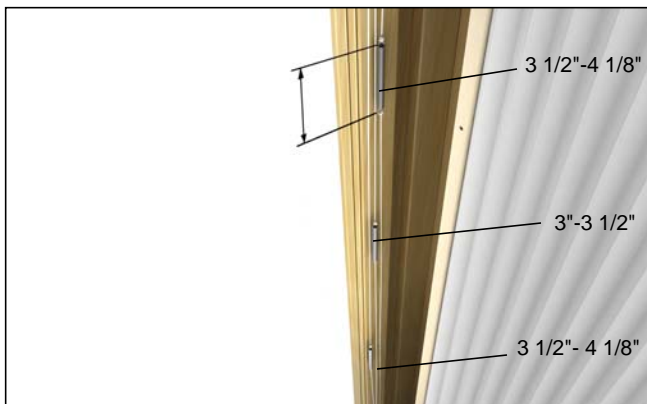

Figure 10

Operator Panel Shade Installation

- Remove the meeting stile pocket cover by gently prying from frame (the cover is barbed to the frame). See figure 11.



Figure 11

- Insert operator interior shade cartridge into the track. (Pull bar facing towards the locking handle.) See figure 12.



Figure 12

- Using an 1/8" (3) or smaller allen wrench to attach fabric adapter to meeting stile extension via the quarter turn connector on the top and bottom. See figure 13.

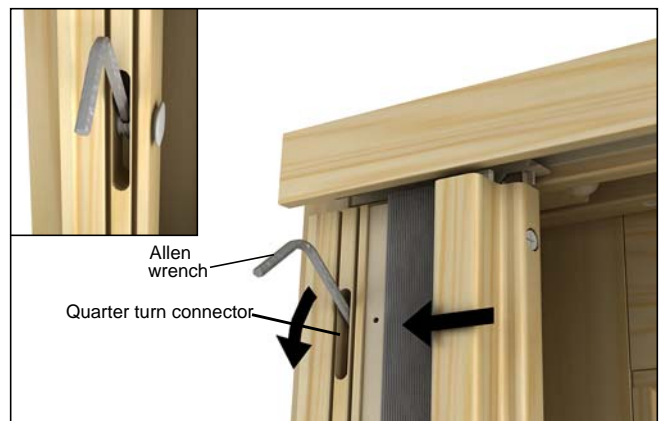

Figure 13

4. Using an 1/8" (3) or smaller allen wrench, loosen the top quarter turn connector. This will temporarily take tension off of the top cords.
5. Remove stretch wrap from top section of interior shade cartridge.
6. At head, insert crimp into cord tensioner. See figure 14.



Figure 14

7. Slide cord tensioner into guide track and fasten with a #6 x 1" flathead screw into the pre-drilled hole. See figure 15.



Figure 15

8. Using an 1/8"(3) or smaller allen wrench, tighten the top quarter turn connector and loosen the bottom quarter turn connector. This will temporarily take tension off of the bottom cords.
9. Remove bottom section of stretch wrap on cartridge.
10. At sill, insert crimp into cord tensioner. Slide cord tensioner into place and fasten with a #6 x 1" flathead screw in the pre-drilled hole. See figure 16.



Figure 16

11. Check operation of interior operator shade. Move the operator panel open and closed to test the operation of the interior shade and magnets. See figure 17.



Tip

If necessary, use a basic paste wax to wax the cords to reduce friction.



Figure 17

12. Top and bottom spring tension needs to be 3 1/2"-4 1/8" (89-105), center spring needs to be 3"-3 1/2"(76-89) for the shade to properly work. See figure 18. Measure from the end of the top loop on string to the opposing loop on the bottom.

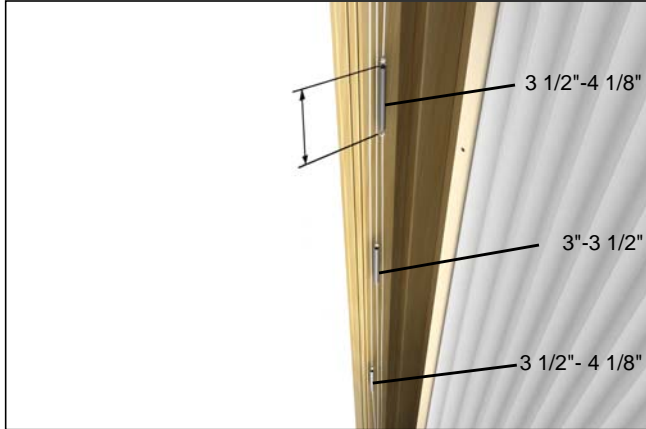

Figure 18

13. Using a rubber mallet install the pocket cover and the meeting stile cover. *Note: Fabric adapter may have up to a 5/8"(16) bow between the quarter turn connector points, this is **not** a defect.*